

LEGEND

#	STRIPING CONSTRUCTION NOTE NUMBER		FIRE HYDRANT
#	DETAIL NUMBER PER CALTRANS STD PLANS Traffic lines as cardinal number Arrows as roman numeral		BLUE FIRE HYDRANT MARKER
TS	TRAFFIC SIGNAL	ETR	EXISTING TO REMAIN
W	CROSSWALK/LIMIT LINE (SOLID ONE FOOT WHITE LINE)	LF	LINEAR FEET
Y	CROSSWALK/LIMIT LINE (SOLID ONE FOOT YELLOW LINE)	SF	SQUARE FEET
		CR	CURB RETURN
		FC	FACE OF CURB
		DI	STORM DRAIN INLET

CONSTRUCTION NOTES

- 1 BIKE LANE SYMBOL & ARROW  
Install bike lane symbol and bike lane arrow markings 20 feet after curb return (as measured from base of symbol) and/or as noted. Space symbol and arrow 6 feet apart. See Detail.

2 SHARROW  
Install first sharrow marking 20 feet after curb return or as noted. Install other sharrow markings as noted. See Detail.

3 PARKING TEE  
Install short stem toward curb, distance measured from center of cross. Spacing between tees to be determined by engineer. See Detail.
- 4 BIKE DETECTOR SYMBOL  
Install bike detector pavement marking 1 foot back from crosswalk and centered in lane, or as noted. See Detail.

5 SPEED HUMP STRIPING  
Install 1 foot white stripes on speed humps, 5 feet apart, on center. See Detail.

6 CONTINENTAL CROSSWALK  
Install 2 foot stripes aligned with roadway centerline, staggered spacing, white unless otherwise noted. Do not refresh existing transverse lines when installing continental crosswalk. See Detail.
- 7 WHITE BUFFER STRIPING  
Install 6 inch white striping every 15 feet at 45 degree angle, or as noted.

8 YELLOW BUFFER STRIPING  
Install 6 inch yellow striping every 15 feet at 45 degree angle, or as noted.

9 REMOVE CONFLICTING STRIPING

10 REMOVE CONFLICTING MARKINGS

11 PAINT CURB COLOR INDICATED

NOTE: CONTRACTOR TO COORDINATE WITH AC TRANSIT TO SCHEDULE REMOVAL AND INSTALLATION OF BUS POLES (BY AC TRANSIT, AS NOTED ON PLANS) BEFORE CONSTRUCTION

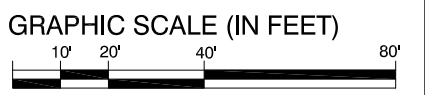

E 18TH ST  
LAKESHORE AVE TO PARK BLVD

REVIEWED BY	No.	DATE	BY	REFERENCE
JASON PATTON				
DESIGNED BY				
DAVID PENE				
DRAWN BY				
DEP				

STRIPING & SIGNAGE  
PLAN  
S-1

PROJECT NO.  
1004787

SCALE: 1" = 40'  
DATE: 10/21/2020

SHEET NO.  
1 OF 11

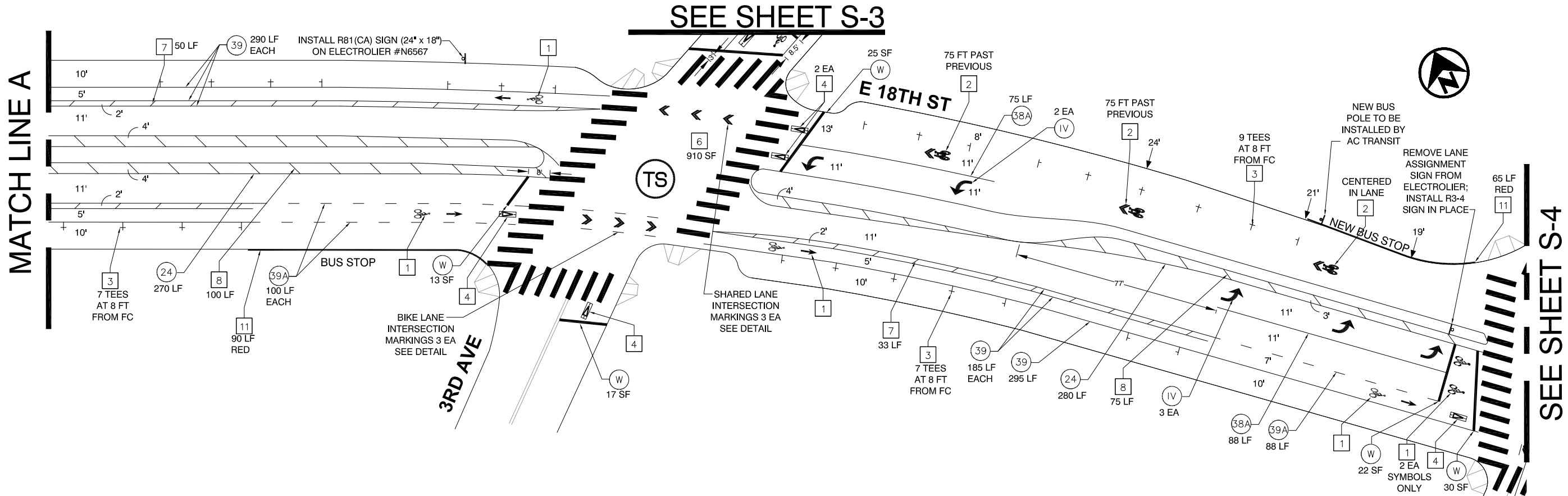

LEGEND

#	STRIPING CONSTRUCTION NOTE NUMBER		FIRE HYDRANT
#	DETAIL NUMBER PER CALTRANS STD PLANS Traffic lines as cardinal number Arrows as roman numeral		BLUE FIRE HYDRANT MARKER
TS	TRAFFIC SIGNAL	ETR	EXISTING TO REMAIN
W	CROSSWALK/LIMIT LINE (SOLID ONE FOOT WHITE LINE)	LF	LINEAR FEET
Y	CROSSWALK/LIMIT LINE (SOLID ONE FOOT YELLOW LINE)	SF	SQUARE FEET
		CR	CURB RETURN
		FC	FACE OF CURB
		DI	STORM DRAIN INLET

CONSTRUCTION NOTES

- 1 BIKE LANE SYMBOL & ARROW  
Install bike lane symbol and bike lane arrow markings 20 feet after curb return (as measured from base of symbol) and/or as noted. Space symbol and arrow 6 feet apart. See Detail.

2 SHARROW  
Install first sharrow marking 20 feet after curb return or as noted. Install other sharrow markings as noted. See Detail.

3 PARKING TEE  
Install short stem toward curb, distance measured from center of cross. Spacing between tees to be determined by engineer. See Detail.
- 4 BIKE DETECTOR SYMBOL  
Install bike detector pavement marking 1 foot back from crosswalk and centered in lane, or as noted. See Detail.

5 SPEED HUMP STRIPING  
Install 1 foot white stripes on speed humps, 5 feet apart, on center. See Detail.

6 CONTINENTAL CROSSWALK  
Install 2 foot stripes aligned with roadway centerline, staggered spacing, white unless otherwise noted. Do not refresh existing transverse lines when installing continental crosswalk. See Detail.
- 7 WHITE BUFFER STRIPING  
Install 6 inch white striping every 15 feet at 45 degree angle, or as noted.

8 YELLOW BUFFER STRIPING  
Install 6 inch yellow striping every 15 feet at 45 degree angle, or as noted.

9 REMOVE CONFLICTING STRIPING

10 REMOVE CONFLICTING MARKINGS

11 PAINT CURB COLOR INDICATED

NOTE: CONTRACTOR TO COORDINATE WITH AC TRANSIT TO SCHEDULE REMOVAL AND INSTALLATION OF BUS POLES (BY AC TRANSIT, AS NOTED ON PLANS) BEFORE CONSTRUCTION

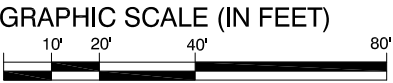

**CITY OF OAKLAND**  
DEPARTMENT OF TRANSPORTATION  
250 FRANK H. OGAWA PLAZA, SUITE 4344 \* OAKLAND CA, 94612  
(510) 238-3466 \* FAX (510) 238-7415

**E 18TH ST**  
LAKESHORE AVE TO PARK BLVD

REVIEWED BY	JASON PATTON	No.	DATE	BY	REFERENCE
DESIGNED BY	DAVID PENÉ				
DRAWN BY	DEP				

**STRIPING & SIGNAGE**  
**PLAN**  
**S-2**

PROJECT NO. <b>1004787</b>	
SCALE: 1" = 40'	SHEET NO.
DATE: 10/21/2020	<b>2</b> OF <b>11</b>

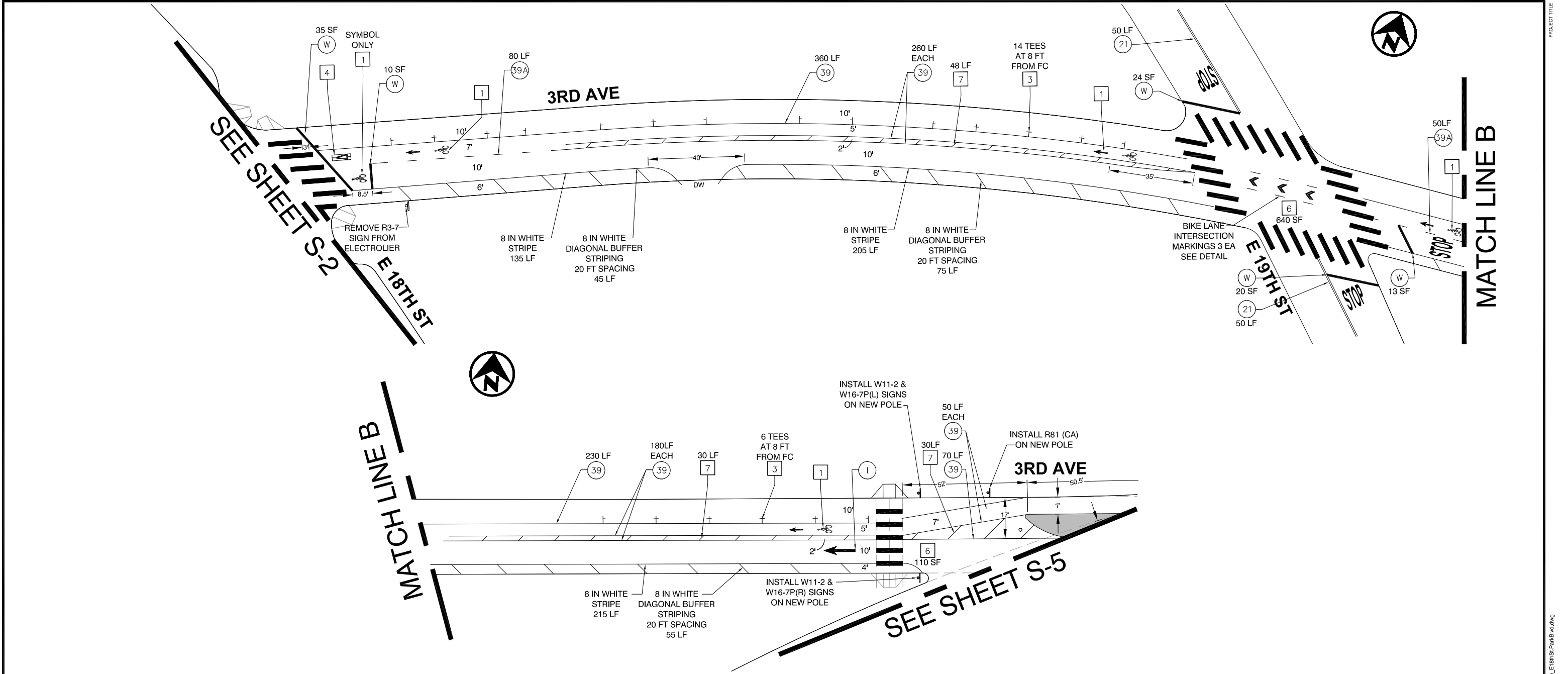

LEGEND

#	STRIPING CONSTRUCTION NOTE NUMBER		FIRE HYDRANT
#	DETAIL NUMBER PER CALTRANS STD PLANS Traffic lines as cardinal number Arrows as roman numeral		BLUE FIRE HYDRANT MARKER
TS	TRAFFIC SIGNAL	ETR	EXISTING TO REMAIN
W	CROSSWALK/LIMIT LINE (SOLID ONE FOOT WHITE LINE)	LF	LINEAR FEET
Y	CROSSWALK/LIMIT LINE (SOLID ONE FOOT YELLOW LINE)	SF	SQUARE FEET
		CR	CURB RETURN
		FC	FACE OF CURB
		DI	STORM DRAIN INLET

CONSTRUCTION NOTES

- 1 BIKE LANE SYMBOL & ARROW  
Install bike lane symbol and bike lane arrow markings 20 feet after curb return (as measured from base of symbol) and/or as noted. Space symbol and arrow 6 feet apart. See Detail.

2 SHARROW  
Install first sharrow marking 20 feet after curb return or as noted. Install other sharrow markings as noted. See Detail.

3 PARKING TEE  
Install short stem toward curb, distance measured from center of cross. Spacing between tees to be determined by engineer. See Detail.
- 4 BIKE DETECTOR SYMBOL  
Install bike detector pavement marking 1 foot back from crosswalk and centered in lane, or as noted. See Detail.

5 SPEED HUMP STRIPING  
Install 1 foot white stripes on speed humps, 5 feet apart, on center. See Detail.

6 CONTINENTAL CROSSWALK  
Install 2 foot stripes aligned with roadway centerline, staggered spacing, white unless otherwise noted. Do not refresh existing transverse lines when installing continental crosswalk. See Detail.
- 7 WHITE BUFFER STRIPING  
Install 6 inch white striping every 15 feet at 45 degree angle, or as noted.

8 YELLOW BUFFER STRIPING  
Install 6 inch yellow striping every 15 feet at 45 degree angle, or as noted.

9 REMOVE CONFLICTING STRIPING

10 REMOVE CONFLICTING MARKINGS

11 PAINT CURB COLOR INDICATED

NOTE: CONTRACTOR TO COORDINATE WITH AC TRANSIT TO SCHEDULE REMOVAL AND INSTALLATION OF BUS POLES (BY AC TRANSIT, AS NOTED ON PLANS) BEFORE CONSTRUCTION

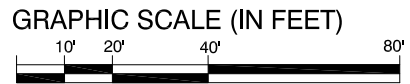

**CITY OF OAKLAND**  
DEPARTMENT OF TRANSPORTATION  
250 FRANK H. OGAWA PLAZA, SUITE 4344 \* OAKLAND CA, 94612  
(510) 238-3466 \* FAX (510) 238-7415

**3RD AVENUE  
E18TH ST - PARK BLVD**

REVIEWED BY	JASON PATTON	No.	DATE	BY	REFERENCE
DESIGNED BY	DAVID PENÉ				
DRAWN BY	DEP				

**STRIPING & SIGNAGE  
PLAN  
S-3**

PROJECT NO. <b>1004787</b>	
SCALE: 1" = 40'	SHEET NO. <b>3 OF 11</b>
DATE: 10/21/2020	

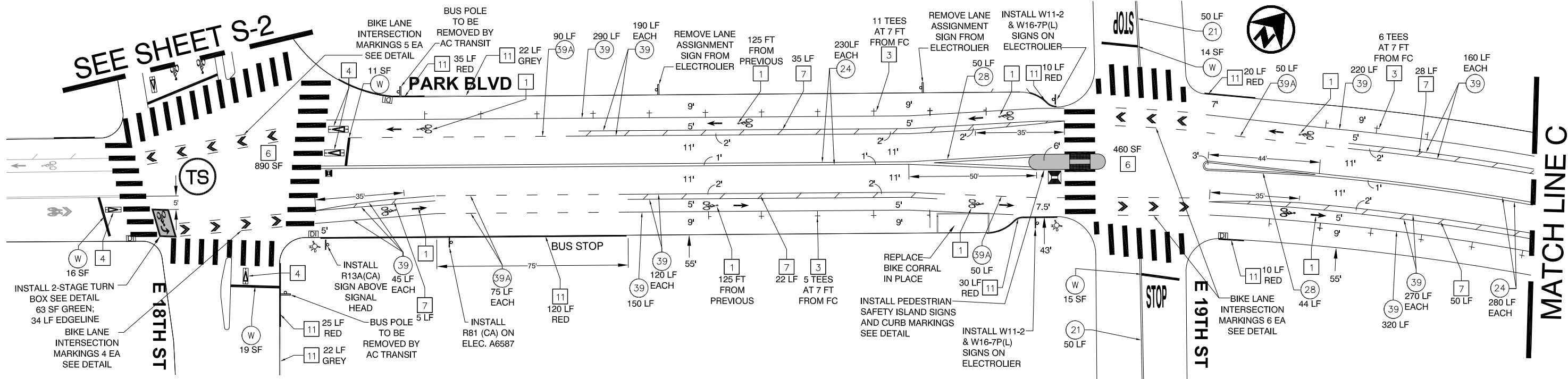

LEGEND

#	STRIPING CONSTRUCTION NOTE NUMBER	Fire Hydrant	FIRE HYDRANT
#	DETAIL NUMBER PER CALTRANS STD PLANS Traffic lines as cardinal number Arrows as roman numeral	Blue Fire Hydrant Marker	BLUE FIRE HYDRANT MARKER
TS	TRAFFIC SIGNAL	ETR	EXISTING TO REMAIN
W	CROSSWALK/LIMIT LINE (SOLID ONE FOOT WHITE LINE)	LF	LINEAR FEET
Y	CROSSWALK/LIMIT LINE (SOLID ONE FOOT YELLOW LINE)	SF	SQUARE FEET
		CR	CURB RETURN
		FC	FACE OF CURB
		DI	STORM DRAIN INLET

CONSTRUCTION NOTES

- 1 BIKE LANE SYMBOL & ARROW  
Install bike lane symbol and bike lane arrow markings 20 feet after curb return (as measured from base of symbol) and/or as noted. Space symbol and arrow 6 feet apart. See Detail.

2 SHARROW  
Install first sharrow marking 20 feet after curb return or as noted. Install other sharrow markings as noted. See Detail.

3 PARKING TEE  
Install short stem toward curb, distance measured from center of cross. Spacing between tees to be determined by engineer. See Detail.
- 4 BIKE DETECTOR SYMBOL  
Install bike detector pavement marking 1 foot back from crosswalk and centered in lane, or as noted. See Detail.

5 SPEED HUMP STRIPING  
Install 1 foot white stripes on speed humps, 5 feet apart, on center. See Detail.

6 CONTINENTAL CROSSWALK  
Install 2 foot stripes aligned with roadway centerline, staggered spacing, white unless otherwise noted. Do not refresh existing transverse lines when installing continental crosswalk. See Detail.
- 7 WHITE BUFFER STRIPING  
Install 6 inch white striping every 15 feet at 45 degree angle, or as noted.

8 YELLOW BUFFER STRIPING  
Install 6 inch yellow striping every 15 feet at 45 degree angle, or as noted.

9 REMOVE CONFLICTING STRIPING

10 REMOVE CONFLICTING MARKINGS

11 PAINT CURB COLOR INDICATED

NOTE: CONTRACTOR TO COORDINATE WITH AC TRANSIT TO SCHEDULE REMOVAL AND INSTALLATION OF BUS POLES (BY AC TRANSIT, AS NOTED ON PLANS) BEFORE CONSTRUCTION

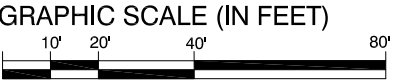

CITY OF OAKLAND

DEPARTMENT OF TRANSPORTATION  
250 FRANK H. OGAWA PLAZA, SUITE 4344 \* OAKLAND CA, 94612  
(510) 238-3466 \* FAX (510) 238-7415

PARK BLVD  
E18TH ST - CHATHAM RD

REVIEWED BY	JASON PATTON	No.	DATE	BY	REFERENCE
DESIGNED BY	DAVID PENÉ				
DRAWN BY	DEP				

STRIPING & SIGNAGE  
PLAN  
S-4

PROJECT NO.  
1004787

SCALE: 1" = 40'

DATE: 10/21/2020

SHEET NO.

4 OF 11



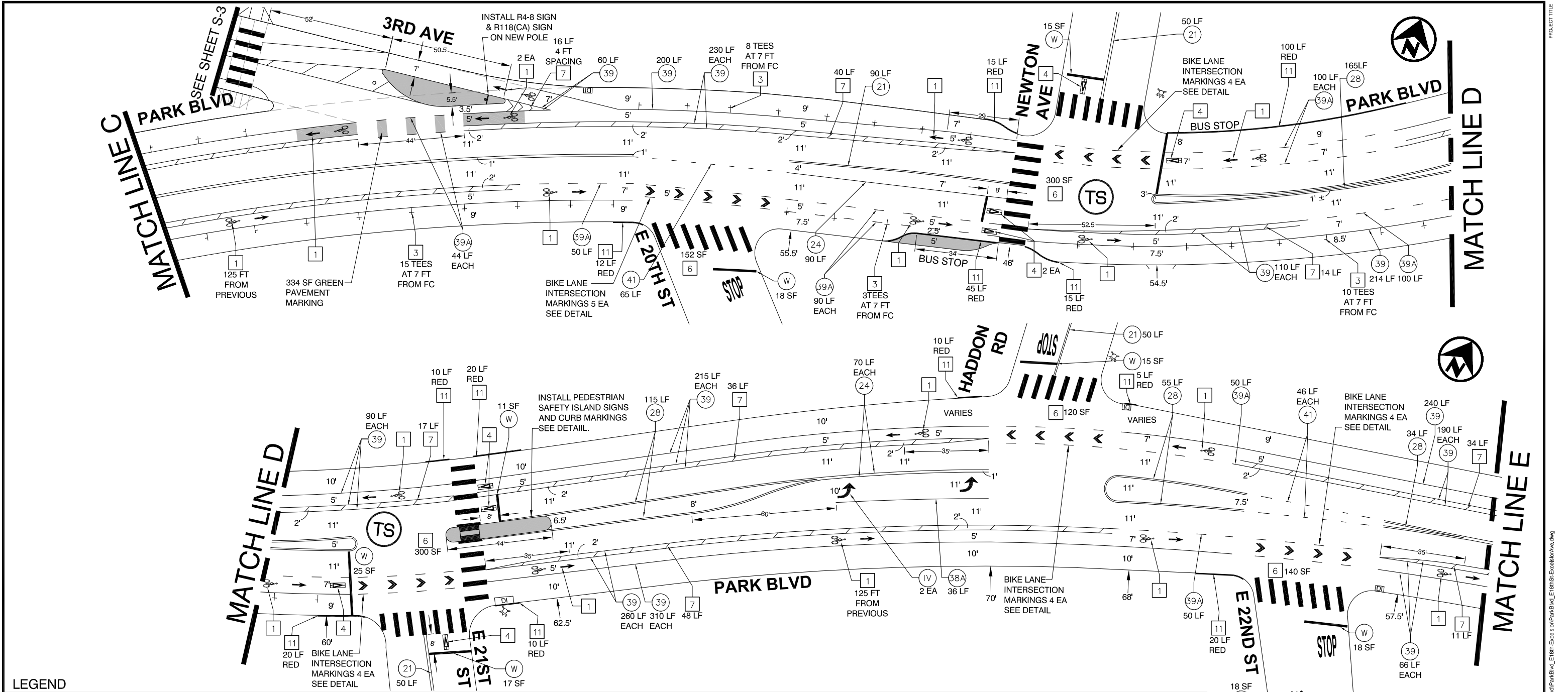

LEGEND

- |    |   |     |                          |
|----|---|-----|--------------------------|
| #  | STRIPING CONSTRUCTION NOTE NUMBER   |     | FIRE HYDRANT             |
| #  | DETAIL NUMBER PER CALTRANS STD PLANS<br>Traffic lines as cardinal number<br>Arrows as roman numeral |     | BLUE FIRE HYDRANT MARKER |
| TS | TRAFFIC SIGNAL  | ETR | EXISTING TO REMAIN       |
| W  | CROSSWALK/LIMIT LINE (SOLID ONE FOOT WHITE LINE)  | LF  | LINEAR FEET              |
| Y  | CROSSWALK/LIMIT LINE (SOLID ONE FOOT YELLOW LINE)   | SF  | SQUARE FEET              |
|    |   | CR  | CURB RETURN              |
|    |   | FC  | FACE OF CURB             |
|    |   | DI  | STORM DRAIN INLET        |

CONSTRUCTION NOTES

- |   |   |   |   |    |   |
|---|---|---|---|----|---|
| 1 | BIKE LANE SYMBOL & ARROW<br>Install bike lane symbol and bike lane arrow markings 20 feet after curb return (as measured from base of symbol) and/or as noted. Space symbol and arrow 6 feet apart. See Detail. | 4 | BIKE DETECTOR SYMBOL<br>Install bike detector pavement marking 1 foot back from crosswalk and centered in lane, or as noted. See Detail.  | 7  | WHITE BUFFER STRIPING<br>Install 6 inch white striping every 15 feet at 45 degree angle, or as noted.   |
| 2 | SHARROW<br>Install first sharrow marking 20 feet after curb return or as noted. Install other sharrow markings as noted. See Detail.  | 5 | SPEED HUMP STRIPING<br>Install 1 foot white stripes on speed humps, 5 feet apart, on center. See Detail.  | 8  | YELLOW BUFFER STRIPING<br>Install 6 inch yellow striping every 15 feet at 45 degree angle, or as noted. |
| 3 | PARKING TEE<br>Install short stem toward curb, distance measured from center of cross. Spacing between tees to be determined by engineer. See Detail.   | 6 | CONTINENTAL CROSSWALK<br>Install 2 foot stripes aligned with roadway centerline, staggered spacing, white unless otherwise noted. Do not refresh existing transverse lines when installing continental crosswalk. See Detail. | 9  | REMOVE CONFLICTING STRIPING   |
|   |   |   |   | 10 | REMOVE CONFLICTING MARKINGS   |
|   |   |   |   | 11 | PAINT CURB COLOR INDICATED  |

NOTE: CONTRACTOR TO COORDINATE WITH AC TRANSIT TO SCHEDULE REMOVAL AND INSTALLATION OF BUS POLES (BY AC TRANSIT, AS NOTED ON PLANS) BEFORE CONSTRUCTION

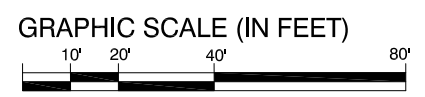

PARK BLVD  
E18TH ST - CHATHAM RD

REVIEWED BY	No.	DATE	BY	REFERENCE
JASON PATTON				
DESIGNED BY				
DAVID PENÉ				
DRAWN BY				
DEP				

STRIPING & SIGNAGE  
PLAN  
S-5

PROJECT NO. 1004787	
SCALE: 1" = 40'	SHEET NO. 5 OF 11
DATE: 10/21/2020	

DRAWING NAME: \\oakland\pva\Transportation\Bikes-Ped\_Program\Projects\Bikes-striping\ParkBlvd\_E18thSt-EssexAve.dwg  
PLOT DATE: 12-10-20  
PLOT BY: perieg

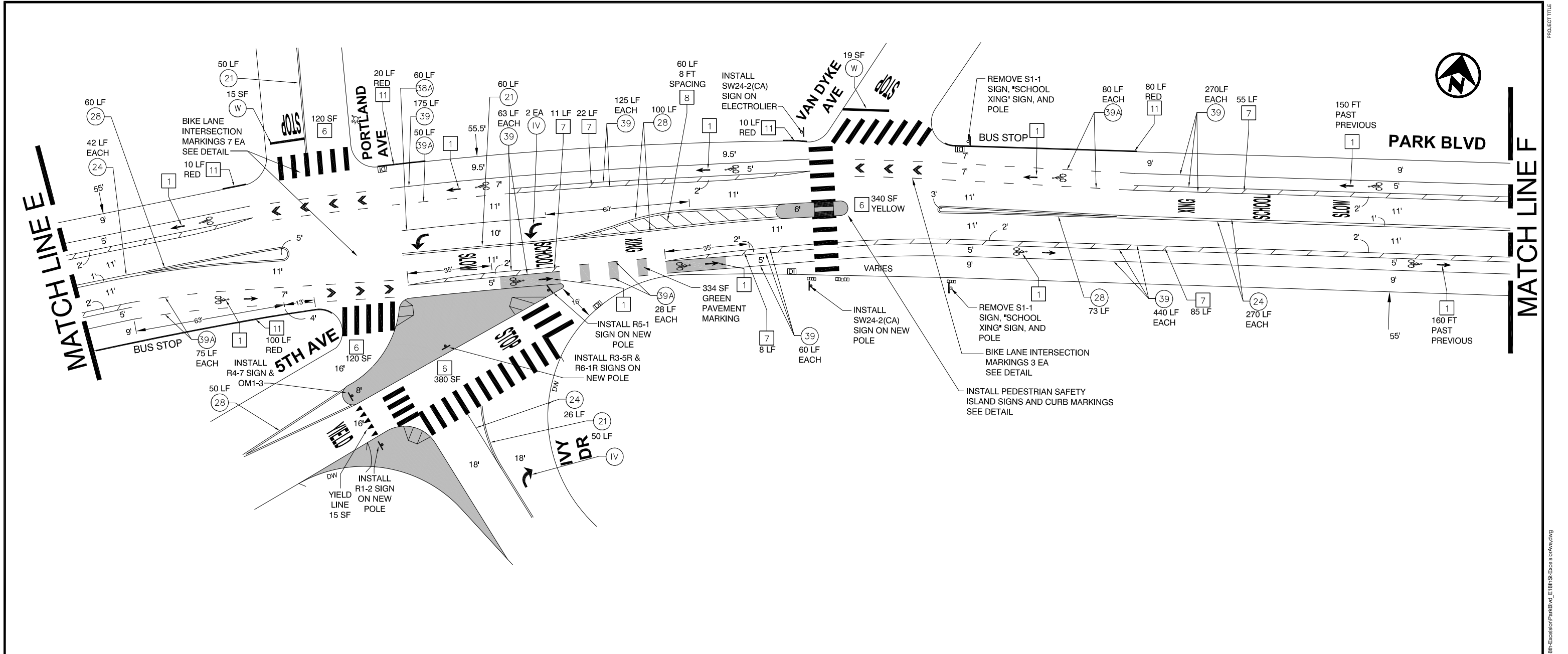

LEGEND

#	STRIPING CONSTRUCTION NOTE NUMBER	Fire Hydrant Symbol	FIRE HYDRANT
#	DETAIL NUMBER PER CALTRANS STD PLANS Traffic lines as cardinal number Arrows as roman numeral	Blue Fire Hydrant Marker	BLUE FIRE HYDRANT MARKER
TS	TRAFFIC SIGNAL	ETR	EXISTING TO REMAIN
W	CROSSWALK/LIMIT LINE (SOLID ONE FOOT WHITE LINE)	LF	LINEAR FEET
Y	CROSSWALK/LIMIT LINE (SOLID ONE FOOT YELLOW LINE)	SF	SQUARE FEET
		CR	CURB RETURN
		FC	FACE OF CURB
		DI	STORM DRAIN INLET

CONSTRUCTION NOTES

- 1 BIKE LANE SYMBOL & ARROW  
Install bike lane symbol and bike lane arrow markings 20 feet after curb return (as measured from base of symbol) and/or as noted. Space symbol and arrow 6 feet apart. See Detail.

2 SHARROW  
Install first sharrow marking 20 feet after curb return or as noted. Install other sharrow markings as noted. See Detail.

3 PARKING TEE  
Install short stem toward curb, distance measured from center of cross. Spacing between tees to be determined by engineer. See Detail.
- 4 BIKE DETECTOR SYMBOL  
Install bike detector pavement marking 1 foot back from crosswalk and centered in lane, or as noted. See Detail.

5 SPEED HUMP STRIPING  
Install 1 foot white stripes on speed humps, 5 feet apart, on center. See Detail.

6 CONTINENTAL CROSSWALK  
Install 2 foot stripes aligned with roadway centerline, staggered spacing, white unless otherwise noted. Do not refresh existing transverse lines when installing continental crosswalk. See Detail.
- 7 WHITE BUFFER STRIPING  
Install 6 inch white striping every 15 feet at 45 degree angle, or as noted.

8 YELLOW BUFFER STRIPING  
Install 6 inch yellow striping every 15 feet at 45 degree angle, or as noted.

9 REMOVE CONFLICTING STRIPING

10 REMOVE CONFLICTING MARKINGS

11 PAINT CURB COLOR INDICATED

NOTE: CONTRACTOR TO COORDINATE WITH AC TRANSIT TO SCHEDULE REMOVAL AND INSTALLATION OF BUS POLES (BY AC TRANSIT, AS NOTED ON PLANS) BEFORE CONSTRUCTION

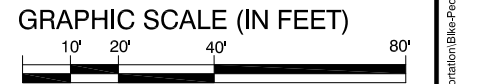

**CITY OF OAKLAND**  
DEPARTMENT OF TRANSPORTATION  
250 FRANK H. OGAWA PLAZA, SUITE 4344 \* OAKLAND CA, 94612  
(510) 238-3466 \* FAX (510) 238-7415

**PARK BLVD**  
**E18TH ST - CHATHAM RD**

REVIEWED BY	JASON PATTON	No.	DATE	BY	REFERENCE
DESIGNED BY	DAVID PENÉ				
DRAWN BY	DEP				

**STRIPING & SIGNAGE**  
**PLAN**  
**S-6**

PROJECT NO. <b>1004787</b>	
SCALE: 1" = 40'	SHEET NO.
DATE: 10/21/2020	<b>6</b> OF <b>11</b>

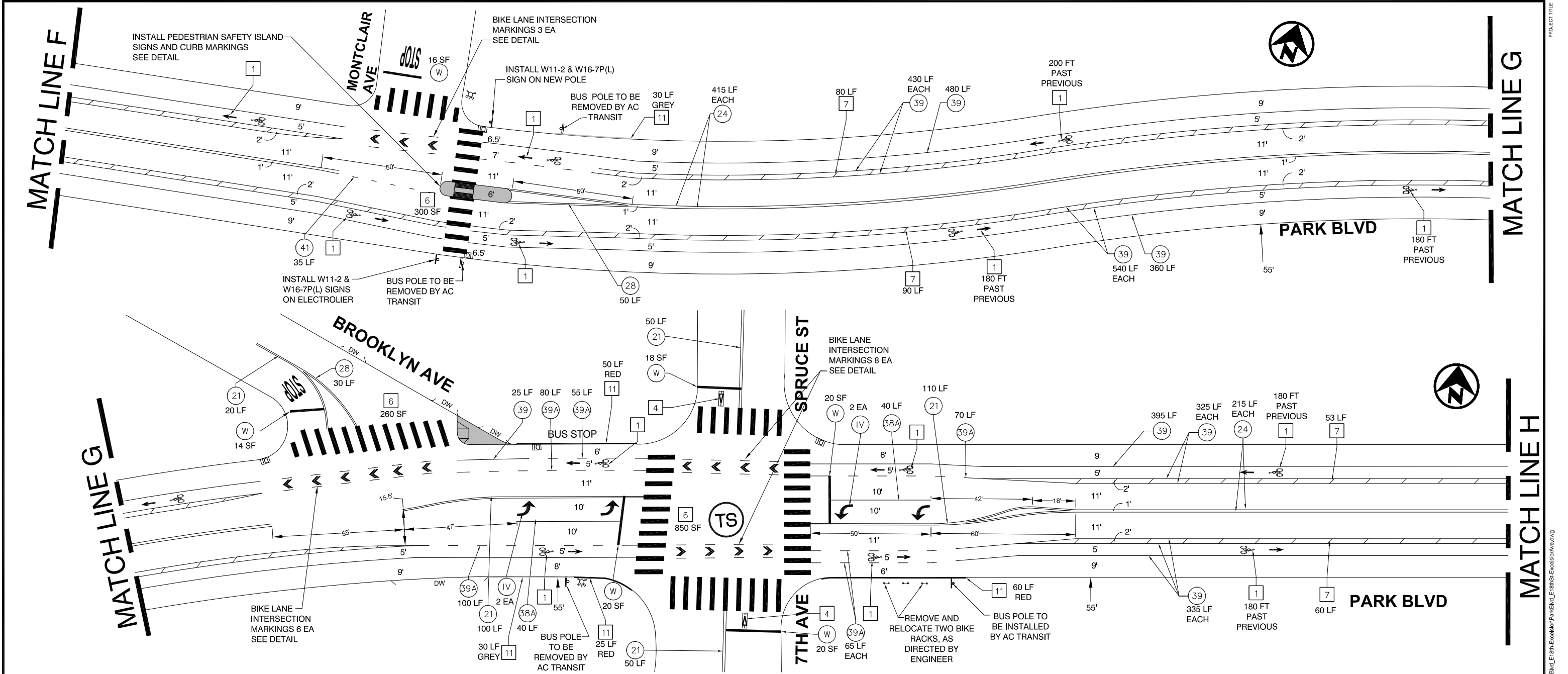

**LEGEND**

#	STRIPING CONSTRUCTION NOTE NUMBER		FIRE HYDRANT
#	DETAIL NUMBER PER CALTRANS STD PLANS Traffic lines as cardinal number Arrows as roman numeral		BLUE FIRE HYDRANT MARKER
TS	TRAFFIC SIGNAL	ETR	EXISTING TO REMAIN
W	CROSSWALK/LIMIT LINE (SOLID ONE FOOT WHITE LINE)	LF	LINEAR FEET
Y	CROSSWALK/LIMIT LINE (SOLID ONE FOOT YELLOW LINE)	SF	SQUARE FEET
		CR	CURB RETURN
		FC	FACE OF CURB
		DI	STORM DRAIN INLET

**CONSTRUCTION NOTES**

1	<b>BIKE LANE SYMBOL &amp; ARROW</b> Install bike lane symbol and bike lane arrow markings 20 feet after curb return (as measured from base of symbol) and/or as noted. Space symbol and arrow 6 feet apart. See Detail.	4	<b>BIKE DETECTOR SYMBOL</b> Install bike detector pavement marking 1 foot back from crosswalk and centered in lane, or as noted. See Detail.
2	<b>SHARROW</b> Install first sharrow marking 20 feet after curb return or as noted. Install other sharrow markings as noted. See Detail.	5	<b>SPEED HUMP STRIPING</b> Install 1 foot white stripes on speed humps, 5 feet apart, on center. See Detail.
3	<b>PARKING TEE</b> Install short stem toward curb, distance measured from center of cross. Spacing between tees to be determined by engineer. See Detail.	6	<b>CONTINENTAL CROSSWALK</b> Install 2 foot stripes aligned with roadway centerline, staggered spacing, white unless otherwise noted. Do not refresh existing transverse lines when installing continental crosswalk. See Detail.

7	<b>WHITE BUFFER STRIPING</b> Install 6 inch white striping every 15 feet at 45 degree angle, or as noted.
8	<b>YELLOW BUFFER STRIPING</b> Install 6 inch yellow striping every 15 feet at 45 degree angle, or as noted.
9	<b>REMOVE CONFLICTING STRIPING</b>
10	<b>REMOVE CONFLICTING MARKINGS</b>
11	<b>PAINT CURB COLOR INDICATED</b>

NOTE: CONTRACTOR TO COORDINATE WITH AC TRANSIT TO SCHEDULE REMOVAL AND INSTALLATION OF BUS POLES (BY AC TRANSIT, AS NOTED ON PLANS) BEFORE CONSTRUCTION

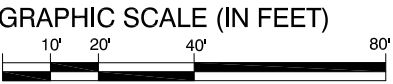

**CITY OF OAKLAND**  
DEPARTMENT OF TRANSPORTATION  
250 FRANK H. OGAWA PLAZA, SUITE 4344 \* OAKLAND CA, 94612  
(510) 238-3466 \* FAX (510) 238-7415

**PARK BLVD**  
E18TH ST - CHATHAM RD

REVIEWED BY	JASON PATTON	No.	DATE	BY	REFERENCE
DESIGNED BY	DAVID PENÉ				
DRAWN BY	DEP				

**STRIPING & SIGNAGE PLAN**  
**S-7**

PROJECT NO.	1004787
SCALE: 1" = 40'	SHEET NO.
DATE: 10/21/2020	7 OF 11

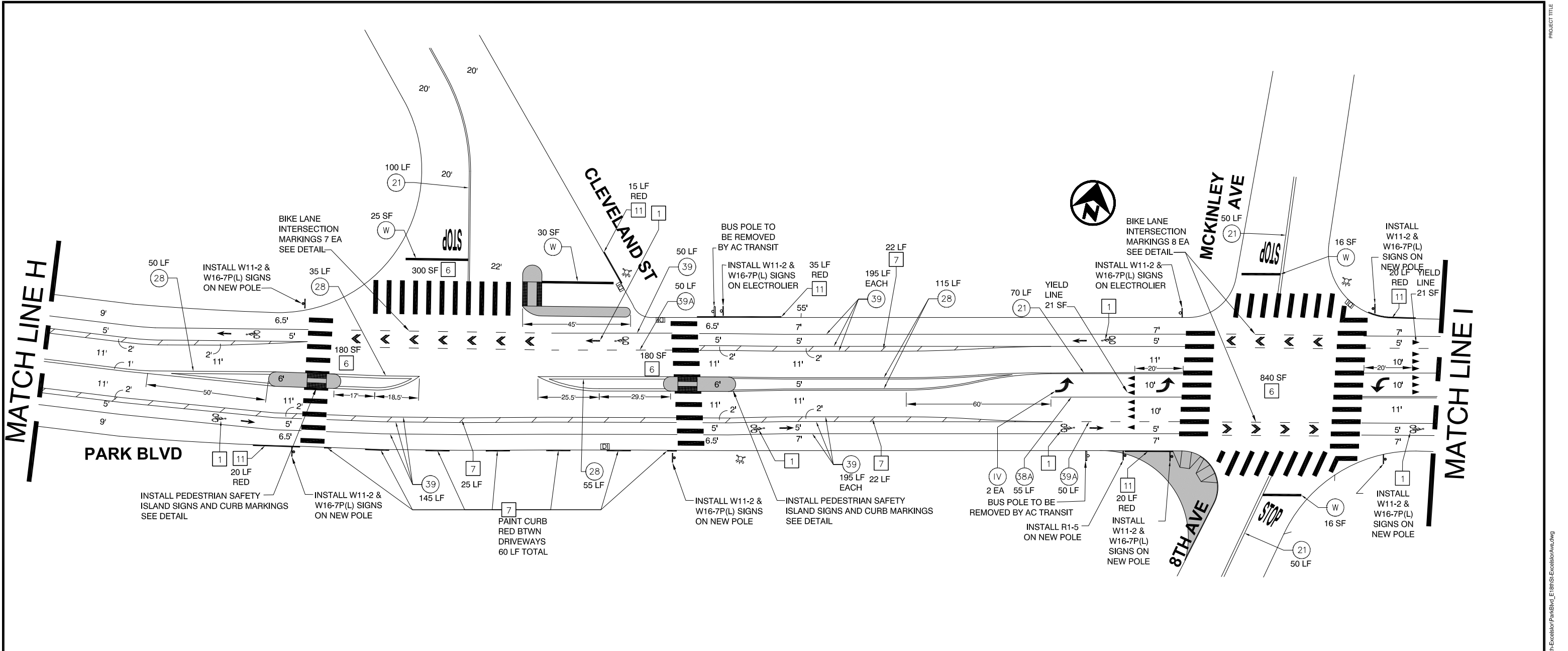

LEGEND

#	STRIPING CONSTRUCTION NOTE NUMBER		FIRE HYDRANT
#	DETAIL NUMBER PER CALTRANS STD PLANS Traffic lines as cardinal number Arrows as roman numeral		BLUE FIRE HYDRANT MARKER
TS	TRAFFIC SIGNAL	ETR	EXISTING TO REMAIN
W	CROSSWALK/LIMIT LINE (SOLID ONE FOOT WHITE LINE)	LF	LINEAR FEET
Y	CROSSWALK/LIMIT LINE (SOLID ONE FOOT YELLOW LINE)	SF	SQUARE FEET
		CR	CURB RETURN
		FC	FACE OF CURB
		DI	STORM DRAIN INLET

CONSTRUCTION NOTES

- 1 BIKE LANE SYMBOL & ARROW  
Install bike lane symbol and bike lane arrow markings 20 feet after curb return (as measured from base of symbol) and/or as noted. Space symbol and arrow 6 feet apart. See Detail.

2 SHARROW  
Install first sharrow marking 20 feet after curb return or as noted. Install other sharrow markings as noted. See Detail.

3 PARKING TEE  
Install short stem toward curb, distance measured from center of cross. Spacing between tees to be determined by engineer. See Detail.
- 4 BIKE DETECTOR SYMBOL  
Install bike detector pavement marking 1 foot back from crosswalk and centered in lane, or as noted. See Detail.

5 SPEED HUMP STRIPING  
Install 1 foot white stripes on speed humps, 5 feet apart, on center. See Detail.

6 CONTINENTAL CROSSWALK  
Install 2 foot stripes aligned with roadway centerline, staggered spacing, white unless otherwise noted. Do not refresh existing transverse lines when installing continental crosswalk. See Detail.
- 7 WHITE BUFFER STRIPING  
Install 6 inch white striping every 15 feet at 45 degree angle, or as noted.

8 YELLOW BUFFER STRIPING  
Install 6 inch yellow striping every 15 feet at 45 degree angle, or as noted.

9 REMOVE CONFLICTING STRIPING

10 REMOVE CONFLICTING MARKINGS

11 PAINT CURB COLOR INDICATED

NOTE: CONTRACTOR TO COORDINATE WITH AC TRANSIT TO SCHEDULE REMOVAL AND INSTALLATION OF BUS POLES (BY AC TRANSIT, AS NOTED ON PLANS) BEFORE CONSTRUCTION



PARK BLVD  
E18TH ST - CHATHAM RD

REVIEWED BY	No.	DATE	BY	REFERENCE
JASON PATTON				
DESIGNED BY				
DAVID PENÉ				
DRAWN BY				
DEP				

STRIPING & SIGNAGE PLAN S-8		PROJECT NO. 1004787	
SCALE: 1" = 40'		SHEET NO. 8 OF 11	
DATE: 10/21/2020			

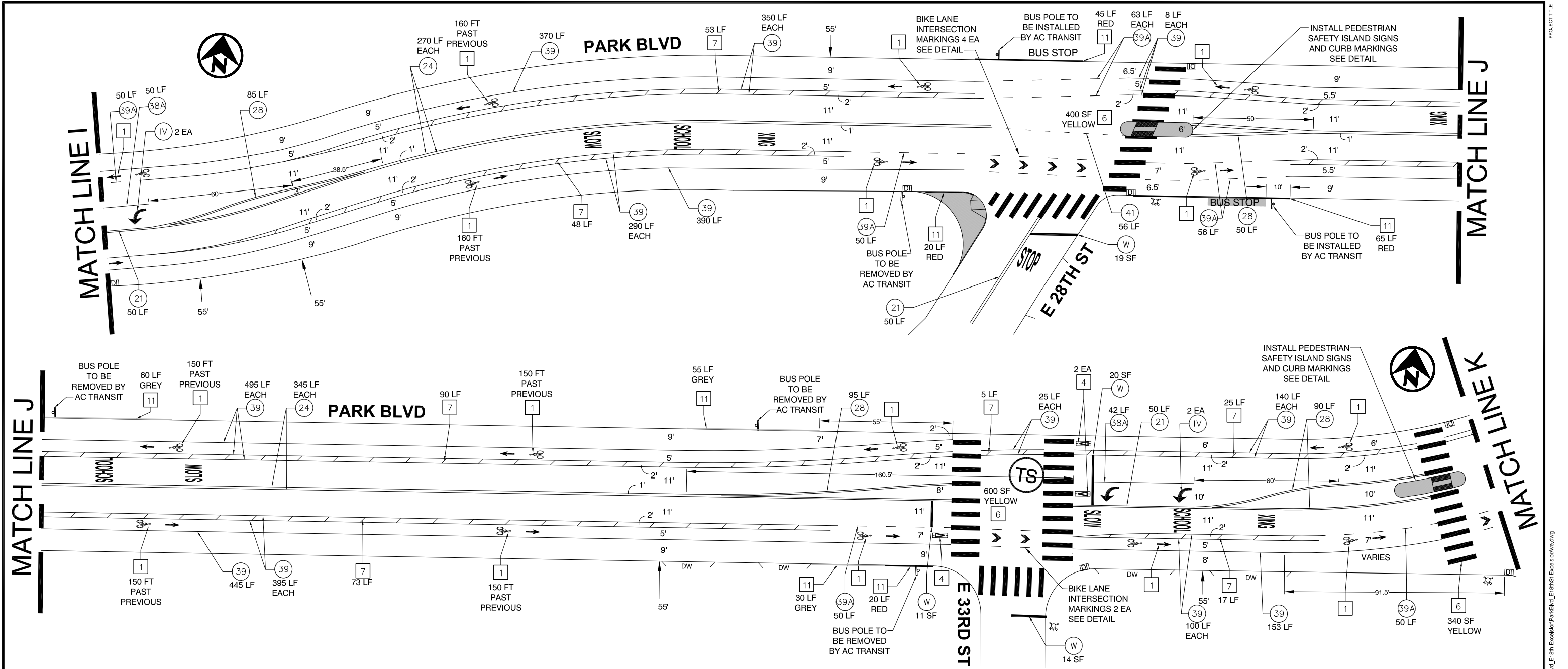

### LEGEND

#	STRIPING CONSTRUCTION NOTE NUMBER		FIRE HYDRANT
#	DETAIL NUMBER PER CALTRANS STD PLANS Traffic lines as cardinal number Arrows as roman numeral		BLUE FIRE HYDRANT MARKER
TS	TRAFFIC SIGNAL	ETR	EXISTING TO REMAIN
W	CROSSWALK/LIMIT LINE (SOLID ONE FOOT WHITE LINE)	LF	LINEAR FEET
Y	CROSSWALK/LIMIT LINE (SOLID ONE FOOT YELLOW LINE)	SF	SQUARE FEET
		CR	CURB RETURN
		FC	FACE OF CURB
		DI	STORM DRAIN INLET

### CONSTRUCTION NOTES

- BIKE LANE SYMBOL & ARROW**  
Install bike lane symbol and bike lane arrow markings 20 feet after curb return (as measured from base of symbol) and/or as noted. Space symbol and arrow 6 feet apart. See Detail.
- SHARROW**  
Install first sharrow marking 20 feet after curb return or as noted. Install other sharrow markings as noted. See Detail.
- PARKING TEE**  
Install short stem toward curb, distance measured from center of cross. Spacing between tees to be determined by engineer. See Detail.
- BIKE DETECTOR SYMBOL**  
Install bike detector pavement marking 1 foot back from crosswalk and centered in lane, or as noted. See Detail.
- SPEED HUMP STRIPING**  
Install 1 foot white stripes on speed humps, 5 feet apart, on center. See Detail.
- CONTINENTAL CROSSWALK**  
Install 2 foot stripes aligned with roadway centerline, staggered spacing, white unless otherwise noted. Do not refresh existing transverse lines when installing continental crosswalk. See Detail.
- WHITE BUFFER STRIPING**  
Install 6 inch white striping every 15 feet at 45 degree angle, or as noted.
- YELLOW BUFFER STRIPING**  
Install 6 inch yellow striping every 15 feet at 45 degree angle, or as noted.
- REMOVE CONFLICTING STRIPING**
- REMOVE CONFLICTING MARKINGS**
- PAINT CURB COLOR INDICATED**

NOTE: CONTRACTOR TO COORDINATE WITH AC TRANSIT TO SCHEDULE REMOVAL AND INSTALLATION OF BUS POLES (BY AC TRANSIT, AS NOTED ON PLANS) BEFORE CONSTRUCTION

**GRAPHIC SCALE (IN FEET)**

1' 2' 4' 8'

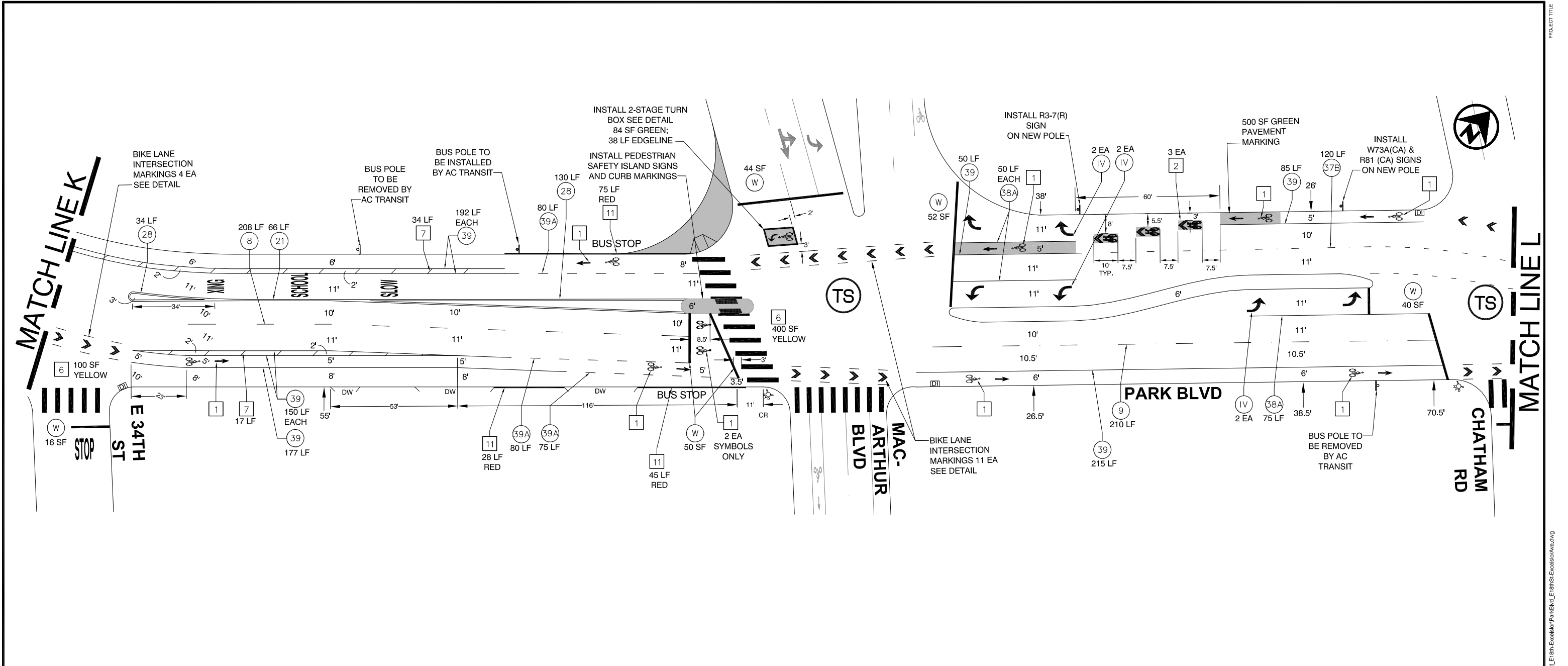

**LEGEND**

#	STRIPING CONSTRUCTION NOTE NUMBER		FIRE HYDRANT
#	DETAIL NUMBER PER CALTRANS STD PLANS Traffic lines as cardinal number Arrows as roman numeral		BLUE FIRE HYDRANT MARKER
TS	TRAFFIC SIGNAL	ETR	EXISTING TO REMAIN
W	CROSSWALK/LIMIT LINE (SOLID ONE FOOT WHITE LINE)	LF	LINEAR FEET
Y	CROSSWALK/LIMIT LINE (SOLID ONE FOOT YELLOW LINE)	SF	SQUARE FEET
		CR	CURB RETURN
		FC	FACE OF CURB
		DI	STORM DRAIN INLET

**CONSTRUCTION NOTES**

1	<b>BIKE LANE SYMBOL &amp; ARROW</b> Install bike lane symbol and bike lane arrow markings 20 feet after curb return (as measured from base of symbol) and/or as noted. Space symbol and arrow 6 feet apart. See Detail.	4	<b>BIKE DETECTOR SYMBOL</b> Install bike detector pavement marking 1 foot back from crosswalk and centered in lane, or as noted. See Detail.	7	<b>WHITE BUFFER STRIPING</b> Install 6 inch white striping every 15 feet at 45 degree angle, or as noted.
2	<b>SHARROW</b> Install first sharrow marking 20 feet after curb return or as noted. Install other sharrow markings as noted. See Detail.	5	<b>SPEED HUMP STRIPING</b> Install 1 foot white stripes on speed humps, 5 feet apart, on center. See Detail.	8	<b>YELLOW BUFFER STRIPING</b> Install 6 inch yellow striping every 15 feet at 45 degree angle, or as noted.
3	<b>PARKING TEE</b> Install short stem toward curb, distance measured from center of cross. Spacing between tees to be determined by engineer. See Detail.	6	<b>CONTINENTAL CROSSWALK</b> Install 2 foot stripes aligned with roadway centerline, staggered spacing, white unless otherwise noted. Do not refresh existing transverse lines when installing continental crosswalk. See Detail.	9	<b>REMOVE CONFLICTING STRIPING</b>
				10	<b>REMOVE CONFLICTING MARKINGS</b>
				11	<b>PAINT CURB COLOR INDICATED</b>

NOTE: CONTRACTOR TO COORDINATE WITH AC TRANSIT TO SCHEDULE REMOVAL AND INSTALLATION OF BUS POLES (BY AC TRANSIT, AS NOTED ON PLANS) BEFORE CONSTRUCTION

**GRAPHIC SCALE (IN FEET)**  
10' 20' 40' 80'

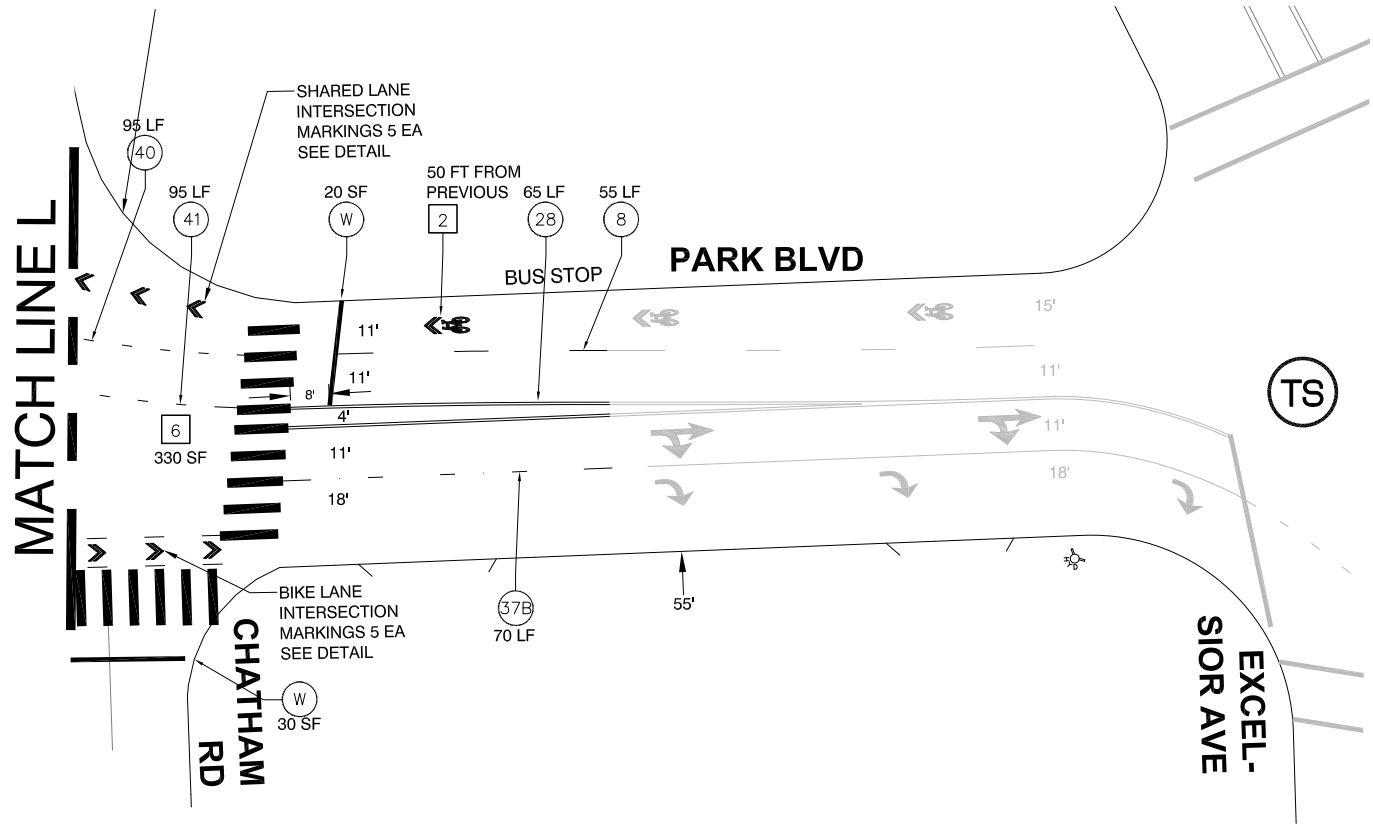

LEGEND

#	STRIPING CONSTRUCTION NOTE NUMBER		FIRE HYDRANT
#	DETAIL NUMBER PER CALTRANS STD PLANS Traffic lines as cardinal number Arrows as roman numeral		BLUE FIRE HYDRANT MARKER
TS	TRAFFIC SIGNAL	ETR	EXISTING TO REMAIN
W	CROSSWALK/LIMIT LINE (SOLID ONE FOOT WHITE LINE)	LF	LINEAR FEET
Y	CROSSWALK/LIMIT LINE (SOLID ONE FOOT YELLOW LINE)	SF	SQUARE FEET
		CR	CURB RETURN
		FC	FACE OF CURB
		DI	STORM DRAIN INLET

CONSTRUCTION NOTES

- 1

BIKE LANE SYMBOL & ARROW  
Install bike lane symbol and bike lane arrow markings 20 feet after curb return (as measured from base of symbol) and/or as noted. Space symbol and arrow 6 feet apart. See Detail.
- 2

SHARROW  
Install first sharrow marking 20 feet after curb return or as noted. Install other sharrow markings as noted. See Detail.
- 3

PARKING TEE  
Install short stem toward curb, distance measured from center of cross. Spacing between tees to be determined by engineer. See Detail.
- 4

BIKE DETECTOR SYMBOL  
Install bike detector pavement marking 1 foot back from crosswalk and centered in lane, or as noted. See Detail.
- 5

SPEED HUMP STRIPING  
Install 1 foot white stripes on speed humps, 5 feet apart, on center. See Detail.
- 6

CONTINENTAL CROSSWALK  
Install 2 foot stripes aligned with roadway centerline, staggered spacing, white unless otherwise noted. Do not refresh existing transverse lines when installing continental crosswalk. See Detail.
- 7

WHITE BUFFER STRIPING  
Install 6 inch white striping every 15 feet at 45 degree angle, or as noted.
- 8

YELLOW BUFFER STRIPING  
Install 6 inch yellow striping every 15 feet at 45 degree angle, or as noted.
- 9

REMOVE CONFLICTING STRIPING
- 10

REMOVE CONFLICTING MARKINGS
- 11

PAINT CURB COLOR INDICATED

NOTE: CONTRACTOR TO COORDINATE WITH AC TRANSIT TO SCHEDULE REMOVAL AND INSTALLATION OF BUS POLES (BY AC TRANSIT, AS NOTED ON PLANS) BEFORE CONSTRUCTION

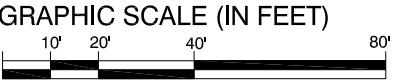

CITY OF OAKLAND  
DEPARTMENT OF TRANSPORTATION  
250 FRANK H. OGAWA PLAZA, SUITE 4344 \* OAKLAND CA, 94612  
(510) 238-3466 \* FAX (510) 238-7415

PARK BLVD  
E18TH ST - CHATHAM RD

REVIEWED BY	JASON PATTON	No.	DATE	BY	REFERENCE
DESIGNED BY	DAVID PENÉ				
DRAWN BY	DEP				

STRIPING & SIGNAGE  
PLAN  
S-11

PROJECT NO. 1004787	
SCALE: 1" = 40'	SHEET NO.
DATE: 10/21/2020	11 OF 11

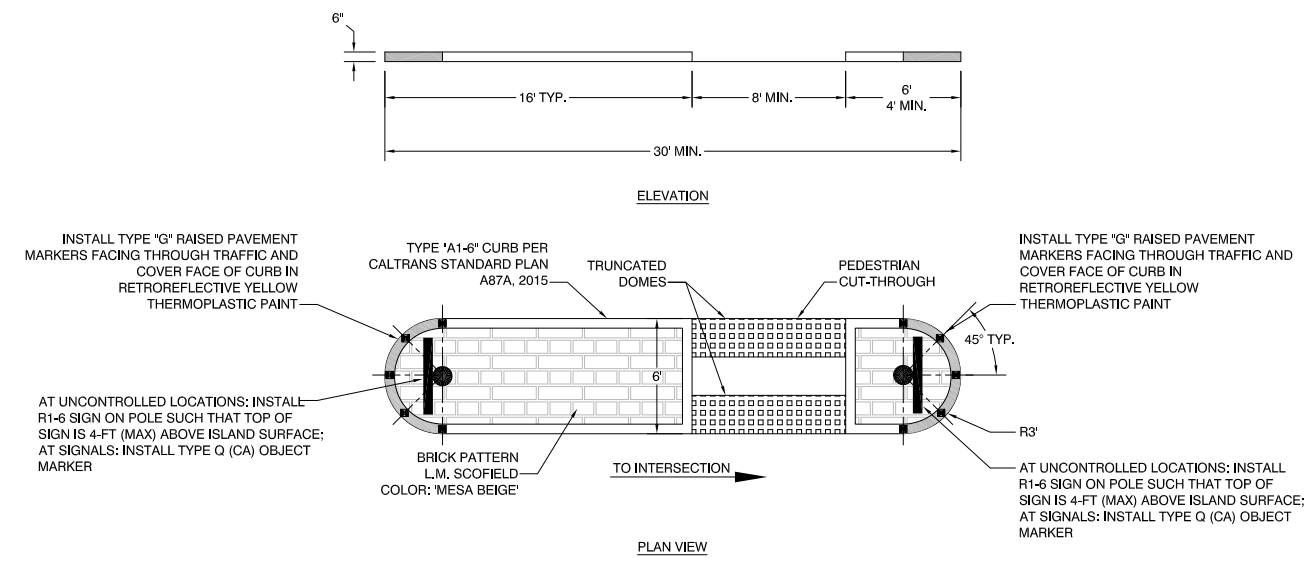

TYPICAL PEDESTRIAN SAFETY ISLAND DETAIL