

CITY OF OAKLAND
TRAFFIC ENGINEERING
WORK ORDER

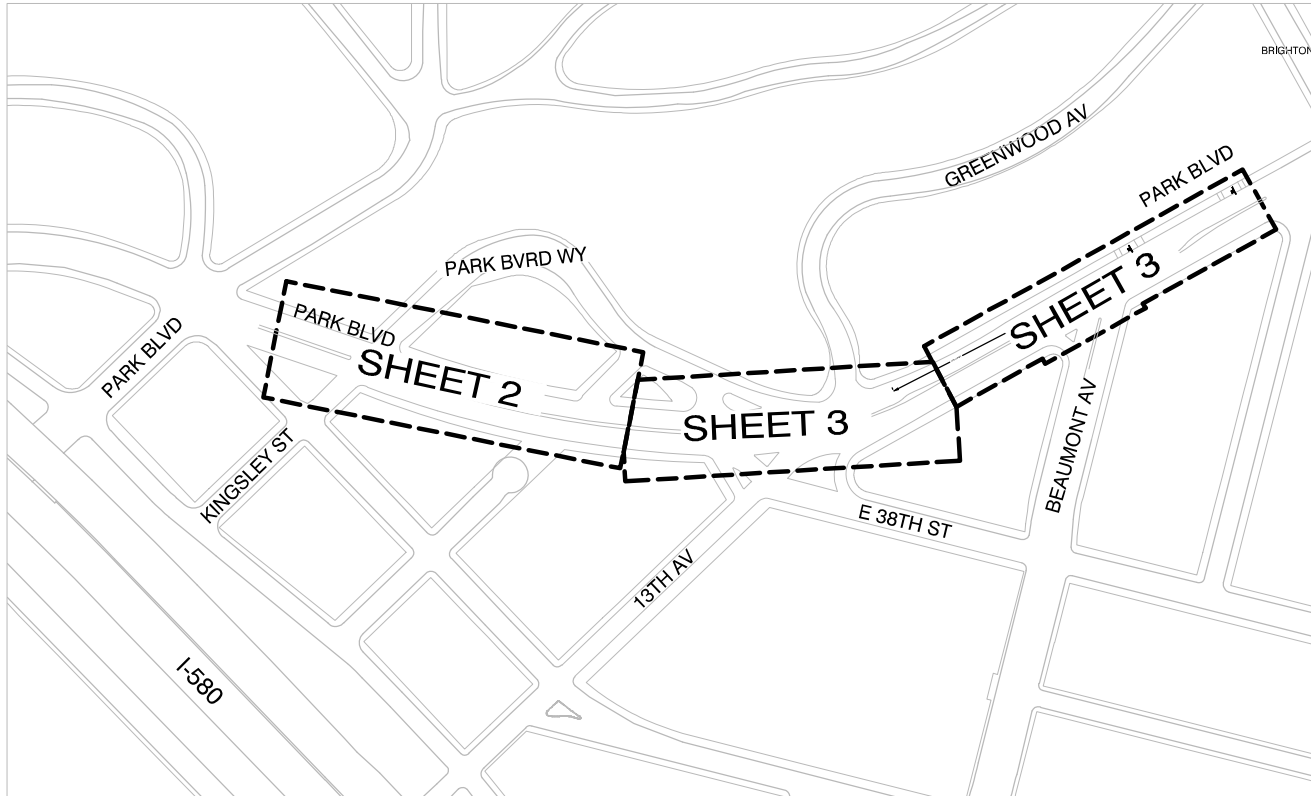

**LOCATION: SEE SHEETS REFERENCED IN KEY MAP BELOW -
PARK BLVD BETWEEN KINGSLEY ST AND BEAUMONT AVE**

Work Order No.: 1261526
TSD WO No.: 21-051
Child WO No.: 1261530
Issued Date: 07/15/2021
NAME OF TE: <i>Joe Wald</i>
Authorization: <i>Joe Wald</i>



COMPLETED BY MAINTENANCE:

Work	Date	By	Hrs.
Stop signs			
Other signs			
Lines			
Crosswalks			
Stencils			
Meters Out of Service			
Meters in Service			
Posts installed			
Painted posts			
Numbered posts			
Curbs painted			
Other			

MATERIAL CHARGED:

LABOR CHARGED:

Name	Hrs.	Name	Hrs.

INVOICED:

No.	Date:	Amt:
-----	-------	------

POSTED:

Shop:	Office:	Maps:
-------	---------	-------

POETA
PROJECT, ORG, EXPENSE, TASK, AWARD

Designed By: BJS	Phone #: 238-6175	Request #: 1130243
MATERIAL:	Project #: 1004820	ORG #: 92246
LABOR:	Project #: 1004820	ORG #: 92246
	Expense Acct #: 52411	Task #: "TE WO"
	Expense Acct #: 52411	Task #: "TE WO"
		Award #: 23234
		Award #: 23234



CITY OF OAKLAND
DEPARTMENT OF TRANSPORTATION - SAFE STREETS DIVISION
TRAFFIC ENGINEERING
250 FRANK H. OGDEN PLAZA, SUITE 4344
OAKLAND CA, 94612

TEMPORARY LANE DROP - PARK BLVD BETWEEN
KINGSLEY ST AND BEAUMONT AVE

	No.	DATE	BY	REFERENCE
CHECKED BY:				
DESIGNED BY:				
DRAWN BY:				

COVER SHEET &
KEY MAP

SCALE: NTS
DATE: 06/04/2021

SHEET 1 OF 3

Location: PARK BLVD BETWEEN KINGSLEY ST AND BEAUMONT AVE

CITY OF OAKLAND
TRAFFIC ENGINEERING
WORK ORDER



Please Perform the Work Indicated Below:

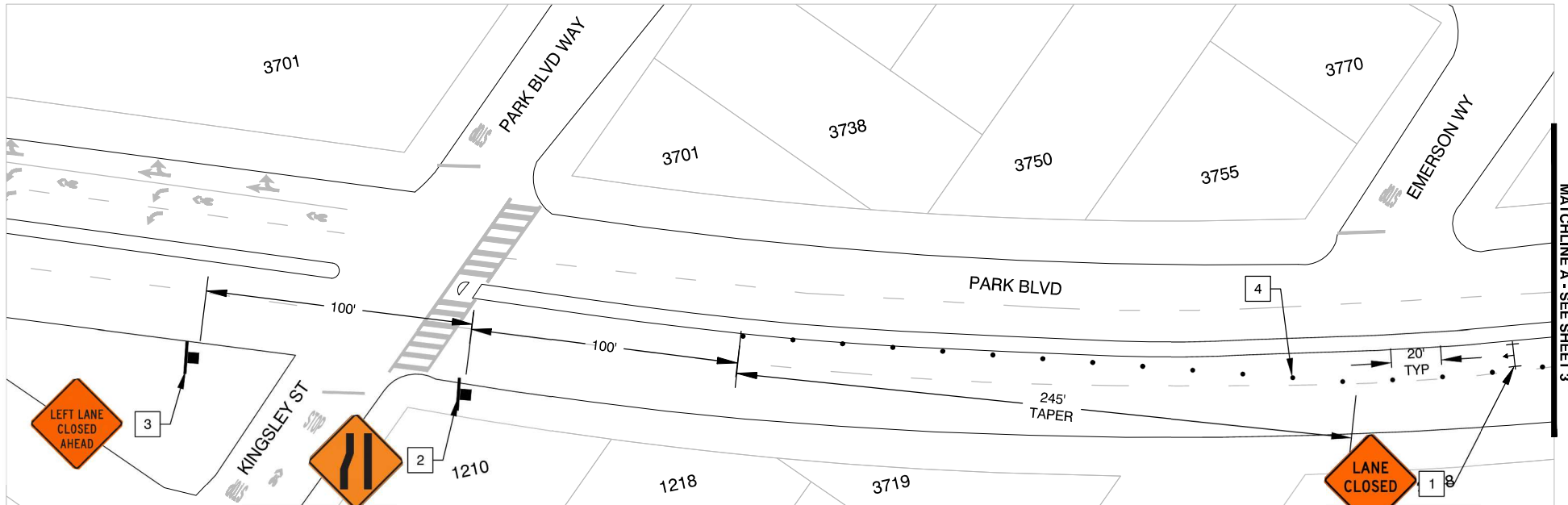

CONSTRUCTION NOTES:

- 1 INSTALL "LANE CLOSED", C30 (CA), SIGN ON TYPE 3 BARRICADE
- 2 INSTALL LANE DROP SYMBOL, W4-2L SIGN ON NEW POST.
- 3 INSTALL "LEFT LANE CLOSED AHEAD", W20-5L, SIGN ON NEW POST.
- 4 INSTALL ORANGE FLEX POST AS SHOWN ADHERED TO THE PAVEMENT WITH BUTYL PADS

LEGEND:

- FLEX POST
- ⊥ NEW SIGN ON TYPE 3 BARRICADE
- ▬ NEW SIGN ON NEW POST

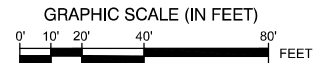

CITY OF OAKLAND
DEPARTMENT OF TRANSPORTATION - SAFE STREETS DIVISION
TRAFFIC ENGINEERING
250 FRANK H. OGDEN PLAZA, SUITE 4344
OAKLAND CA, 94612

TEMPORARY LANE DROP - PARK BLVD BETWEEN
KINGSLEY ST AND BEAUMONT AVE

No.	DATE	BY	REFERENCE

CHECKED BY: JW
DESIGNED BY: BJS
DRAWN BY: BJS

FLEX POSTS AND
SIGNAGE SHEET

SCALE: 1"=40'
DATE: 06/04/2021

SHEET 2 OF 3

Location: PARK BLVD BETWEEN KINGSLEY ST AND BEAUMONT AVE

CITY OF OAKLAND
TRAFFIC ENGINEERING
WORK ORDER

Please Perform the Work Indicated Below:

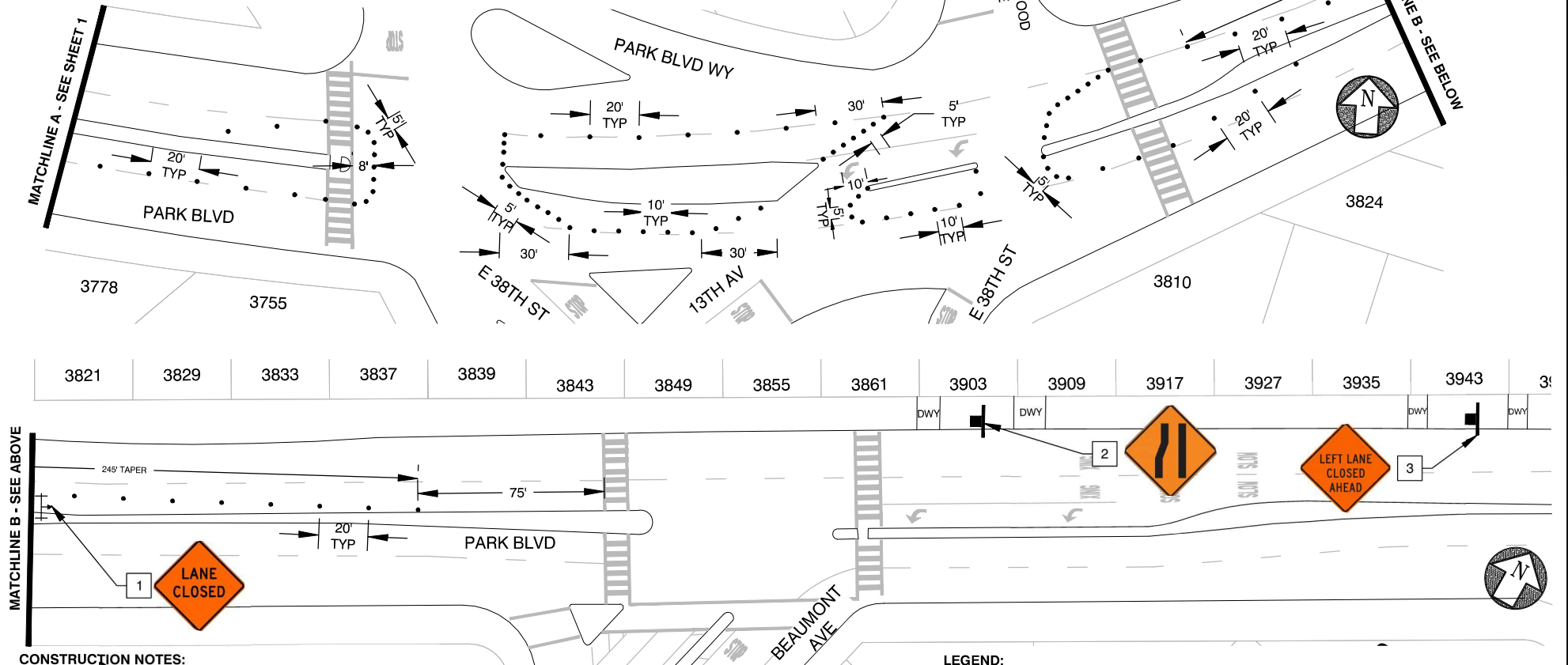

CONSTRUCTION NOTES:

- 1 INSTALL "LANE CLOSED", C30 (CA), SIGN ON TYPE 3 BARRICADE
- 2 INSTALL LANE DROP SYMBOL, W4-2L SIGN ON NEW POST.
- 3 INSTALL "LEFT LANE CLOSED AHEAD", W20-5L, SIGN ON NEW POST.
- 4 INSTALL ORANGE FLEX POST AS SHOWN ADHERED TO THE PAVEMENT WITH BUTYL PADS

LEGEND:

- FLEX POST
- NEW SIGN ON TYPE 3 BARRICADE
- NEW SIGN ON NEW POST

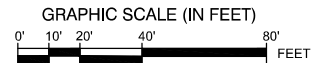

CITY OF OAKLAND
DEPARTMENT OF TRANSPORTATION - SAFE STREETS DIVISION
TRAFFIC ENGINEERING
250 FRANK H. OGDEN PLAZA, SUITE 4344
OAKLAND CA, 94612

TEMPORARY LANE DROP - PARK BLVD BETWEEN
KINGSLEY ST AND BEAUMONT AVE

No.	DATE	BY	REFERENCE
CHECKED BY	JW		
DESIGNED BY	BJS		
DRAWN BY	BJS		

FLEX POSTS AND
SIGNAGE SHEET

SCALE: 1"=40'
DATE: 06/04/2021

SHEET 3 OF 3