

SECTION A-A

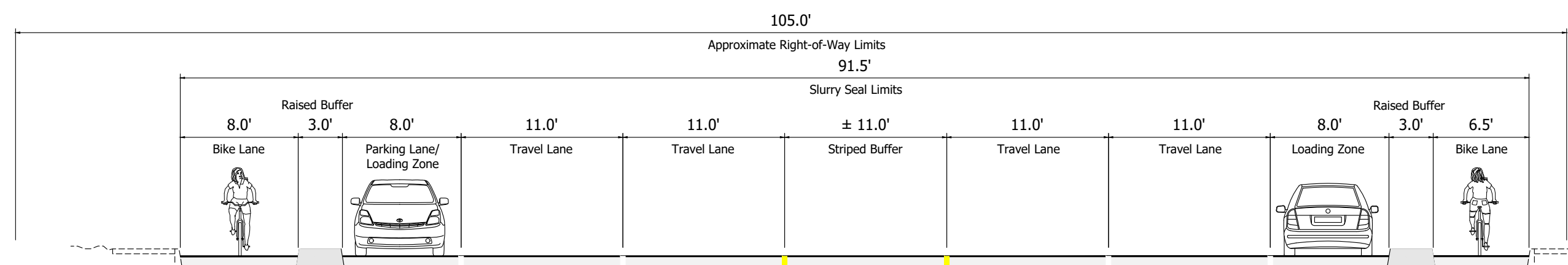

SECTION B-B

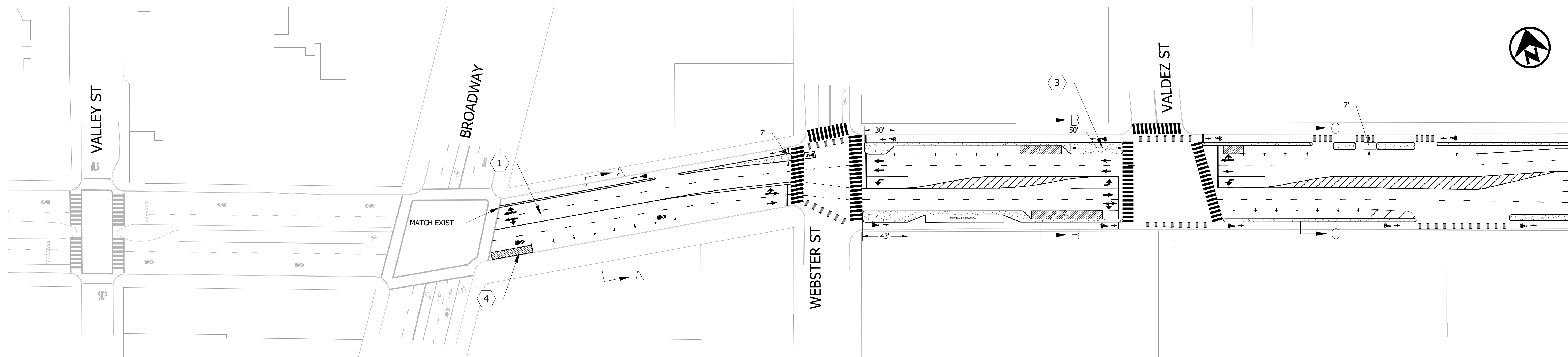

CONSTRUCTION NOTES

- 1 CRACK TREATMENT AND SLURRY SEAL EXISTING PAVEMENT FULL WIDTH (TYP)
- 2 REMOVE EXISTING CURB EXTENSION AND INSTALL NEW CURB RAMP, SIDEWALK, AND CURB
- 3 AC TRANSIT BUS STOP; INSTALL BUS BOARDING ISLAND
- 4 LOADING ZONE "LZ" OR PASSENGER LOADING ZONE "PLZ" (TYP)
- 5 EXISTING RRFB
- 6 AC TRANSIT BUS BOARDING ISLAND; BY OTHER PROJECTS

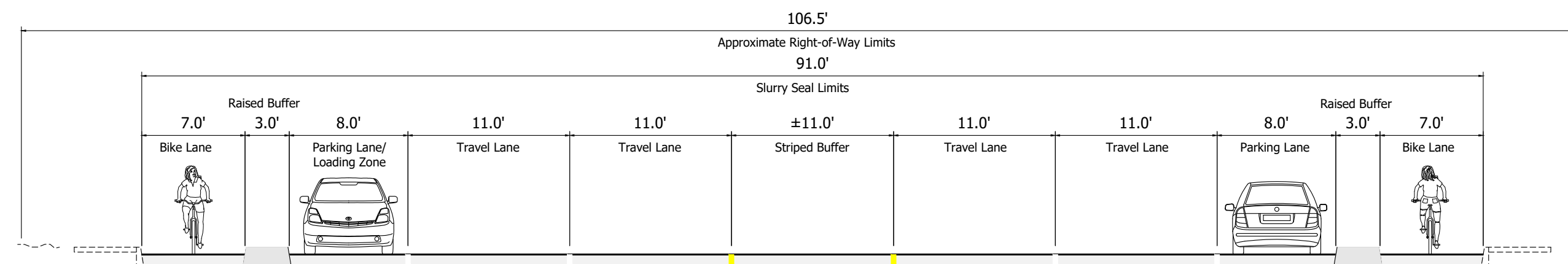

SECTION C-C



	 155 GRAND AVENUE, SUITE 505 OAKLAND, CA 94612 P 510.839.1742 F 510.839.0871	<b>GRAND AVENUE</b>	 <b>CITY OF OAKLAND</b> BUREAU OF ENGINEERING AND CONSTRUCTION SERVICES 250 FRANK OGAWA PLAZA, SUITE 4314 * OAKLAND, CA 94612 (510) 238-3437 * FAX (510) 238-7227 PROJECT NO. _____	CIVIL ENGINEER RCE NO. _____ EXP. _____ CHECKED BY JGA DESIGNED BY MGA DRAWN BY KKD	<table border="1" style="width: 100%; border-collapse: collapse;"> <thead> <tr> <th>No.</th> <th>DATE</th> <th>BY</th> <th>REFERENCE</th> </tr> </thead> <tbody> <tr><td> </td><td> </td><td> </td><td> </td></tr> <tr><td> </td><td> </td><td> </td><td> </td></tr> <tr><td> </td><td> </td><td> </td><td> </td></tr> </tbody> </table>	No.	DATE	BY	REFERENCE													<b>35% CONCEPT PLAN</b> NOT FOR CONSTRUCTION	<b>S1</b>	SCALE: HOR. 1" = 50' VERT. _____ DATE: 04/04/2023 SHEET NO. 1 OF 7
				No.	DATE	BY	REFERENCE																	
DRAWING NAME: H:\2022\2521 - Oakland Transportation On-Call 2018\009 - Oak 35% Design\Grand Ave\design_CD\2521_009G_CD_SIGN&STRIP.dwg PLOT DATE: 04-04-23 PLOTTED BY: Kkd																								

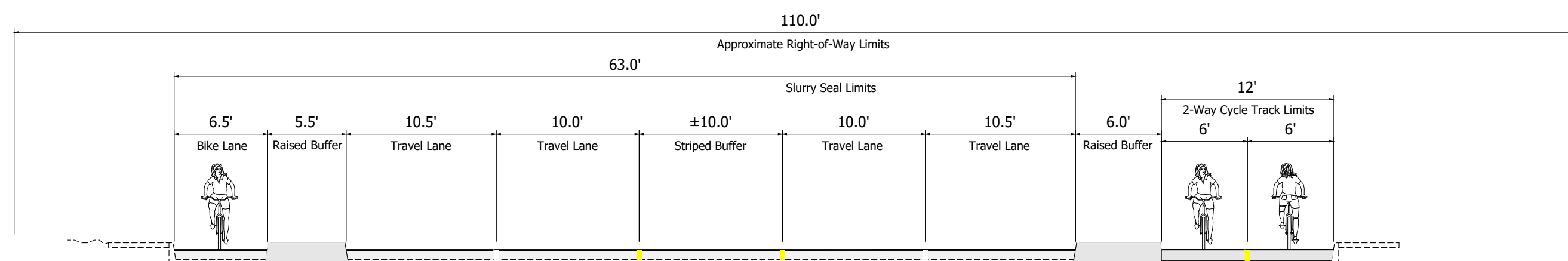

SECTION A-A

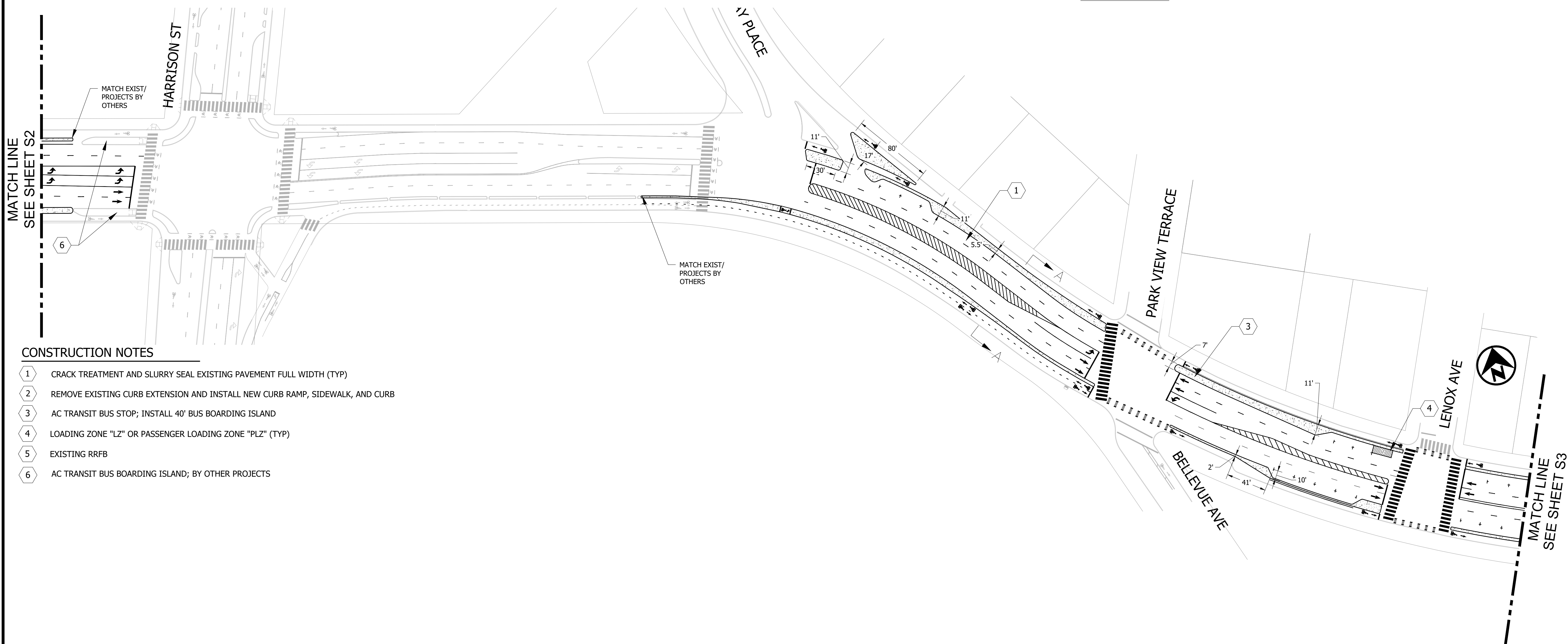

CONSTRUCTION NOTES

- 1 CRACK TREATMENT AND SLURRY SEAL EXISTING PAVEMENT FULL WIDTH (TYP)
- 2 REMOVE EXISTING CURB EXTENSION AND INSTALL NEW CURB RAMP, SIDEWALK, AND CURB
- 3 AC TRANSIT BUS STOP; INSTALL 40' BUS BOARDING ISLAND
- 4 LOADING ZONE "LZ" OR PASSENGER LOADING ZONE "PLZ" (TYP)
- 5 EXISTING RRFB
- 6 AC TRANSIT BUS BOARDING ISLAND; BY OTHER PROJECTS



 155 GRAND AVENUE, SUITE 505 OAKLAND, CA 94612 P 510.839.1742 F 510.839.0871	<b>GRAND AVENUE</b>	 <b>CITY OF OAKLAND</b> BUREAU OF ENGINEERING AND CONSTRUCTION SERVICES 250 FRANK OGAWA PLAZA, SUITE 4314 * OAKLAND, CA 94612 (510) 238-3437 * FAX (510) 238-7227 PROJECT NO. _____	CIVIL ENGINEER	No.	DATE	BY	REFERENCE	35% CONCEPT PLAN NOT FOR CONSTRUCTION	<b>S2</b>	SCALE: HOR. 1" = 50' VERT. _____
			RCE NO. _____ EXP. _____							DATE: 04/04/2023
			CHECKED BY JGA							SHEET NO. 2 OF 7
			DESIGNED BY MGA							
			DRAWN BY KKD							

DRAWING NAME: H:\2022\252521 - Oakland Transportation On-Call 2018\009 - Oak 35% Design\Grand Ave\design\_CD\252521\_009G\_CD\_SIGN&STRIP.dwg  
 PLOT DATE: 04-04-23  
 PLOTTED BY: kkd

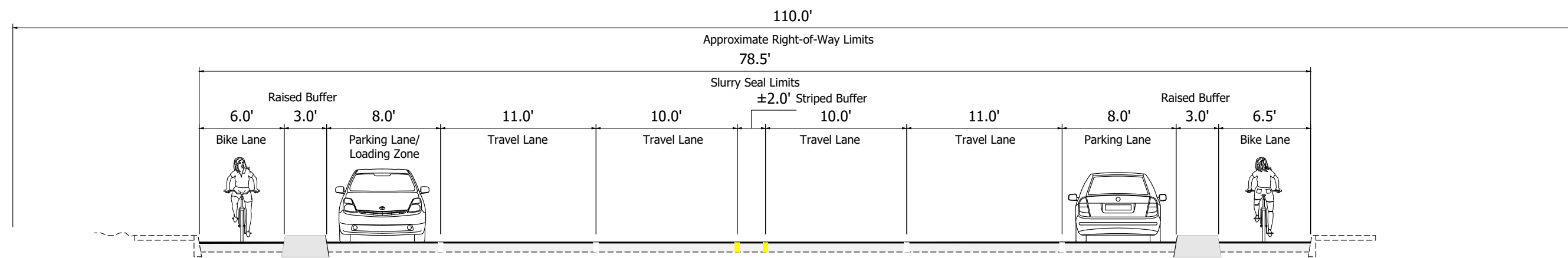

SECTION A-A

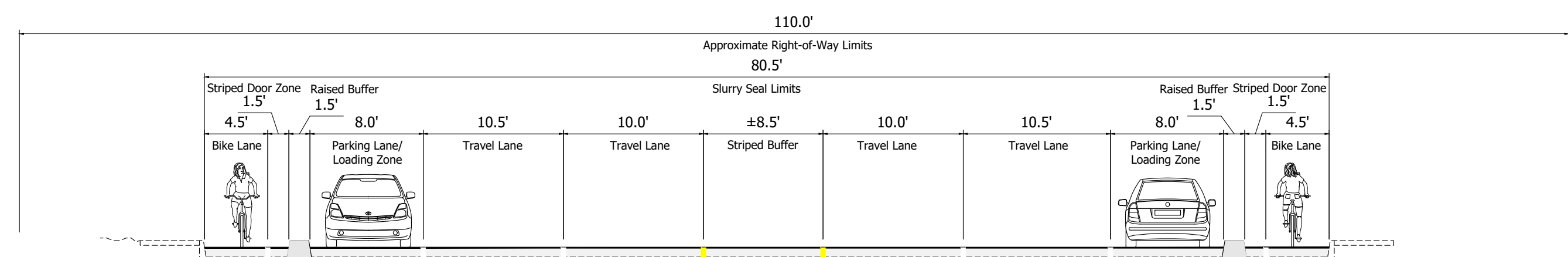

SECTION B-B

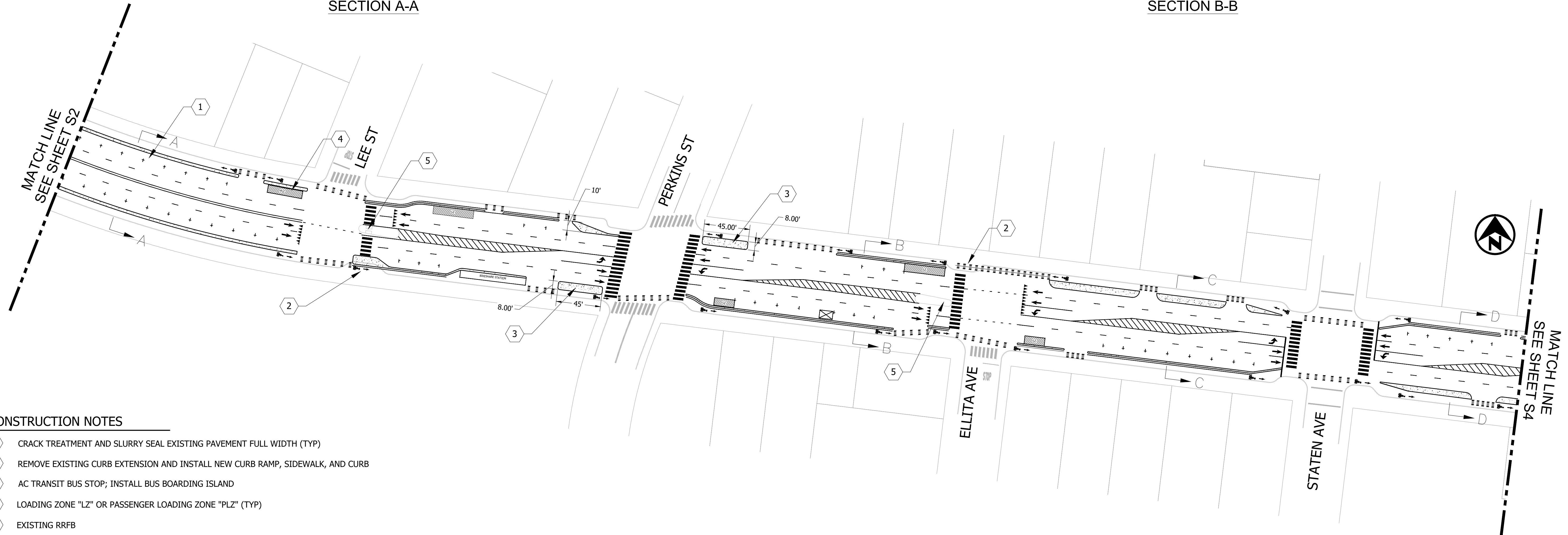

CONSTRUCTION NOTES

- 1 CRACK TREATMENT AND SLURRY SEAL EXISTING PAVEMENT FULL WIDTH (TYP)
- 2 REMOVE EXISTING CURB EXTENSION AND INSTALL NEW CURB RAMP, SIDEWALK, AND CURB
- 3 AC TRANSIT BUS STOP; INSTALL BUS BOARDING ISLAND
- 4 LOADING ZONE "LZ" OR PASSENGER LOADING ZONE "PLZ" (TYP)
- 5 EXISTING RRFB
- 6 AC TRANSIT BUS BOARDING ISLAND; BY OTHER PROJECTS

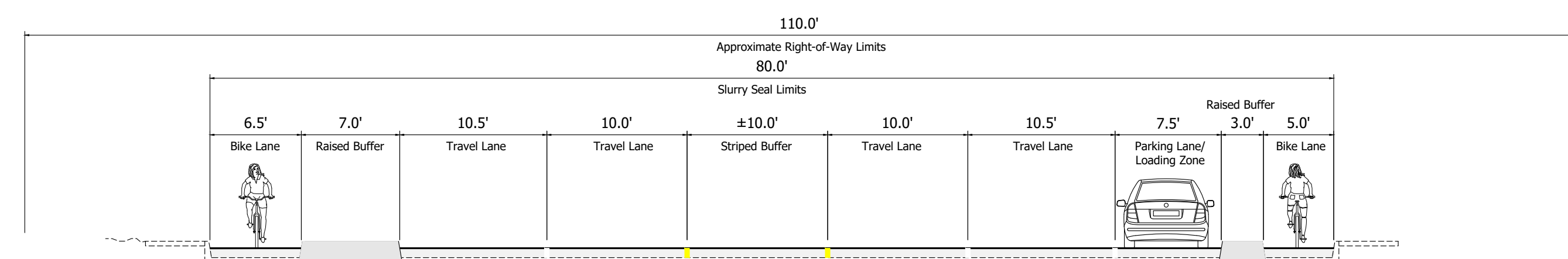

SECTION C-C

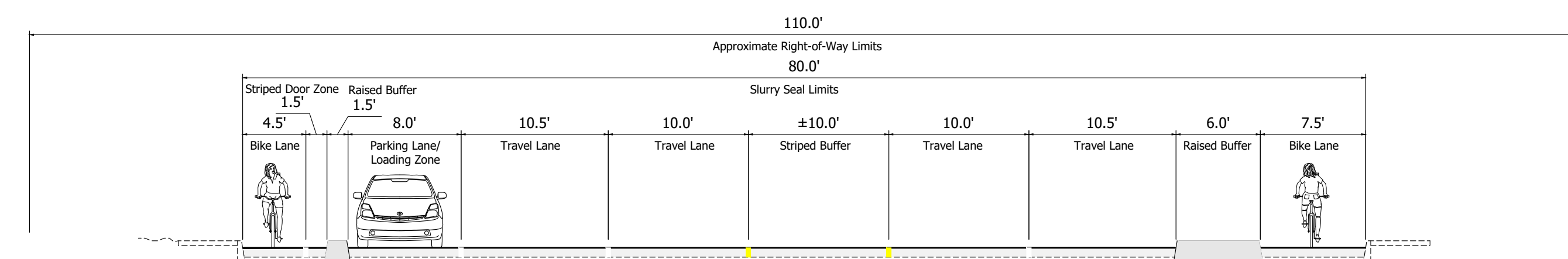

SECTION D-D



	 155 GRAND AVENUE, SUITE 505 OAKLAND, CA 94612 P 510.839.1742 F 510.839.0871	<b>GRAND AVENUE</b>	 <b>CITY OF OAKLAND</b> BUREAU OF ENGINEERING AND CONSTRUCTION SERVICES 250 FRANK OGAWA PLAZA, SUITE 4314 * OAKLAND, CA 94612 (510) 238-3437 * FAX (510) 238-7227 PROJECT NO. _____	CIVIL ENGINEER RCE NO. _____ EXP. _____ CHECKED BY JGA DESIGNED BY MGA DRAWN BY KKD	<table border="1" style="width: 100%; border-collapse: collapse;"> <thead> <tr> <th>No.</th> <th>DATE</th> <th>BY</th> <th>REFERENCE</th> </tr> </thead> <tbody> <tr><td> </td><td> </td><td> </td><td> </td></tr> <tr><td> </td><td> </td><td> </td><td> </td></tr> <tr><td> </td><td> </td><td> </td><td> </td></tr> </tbody> </table>	No.	DATE	BY	REFERENCE													35% CONCEPT PLAN NOT FOR CONSTRUCTION	<b>S3</b>	SCALE: HOR. 1" = 50' VERT. _____ DATE: 04/04/2023 SHEET NO. 4 OF 7
	No.	DATE	BY	REFERENCE																				
DRAWING NAME: H:\2022\252521 - Oakland Transportation On-Call 2018\009 - Oak 35% Design\Grand Ave\design\CD\252521_009G-CD-SIGN&STRIP.dwg PLOT DATE: 04-04-23 PLOTTED BY: KKD																								

**CONSTRUCTION NOTES**

- 1 CRACK TREATMENT AND SLURRY SEAL EXISTING PAVEMENT FULL WIDTH (TYP)
- 2 REMOVE EXISTING CURB EXTENSION AND INSTALL NEW CURB RAMP, SIDEWALK, AND CURB
- 3 AC TRANSIT BUS STOP; INSTALL 40' BUS BOARDING ISLAND
- 4 LOADING ZONE "LZ" OR PASSENGER LOADING ZONE "PLZ" (TYP)
- 5 EXISTING RRFB
- 6 AC TRANSIT BUS BOARDING ISLAND; BY OTHER PROJECTS

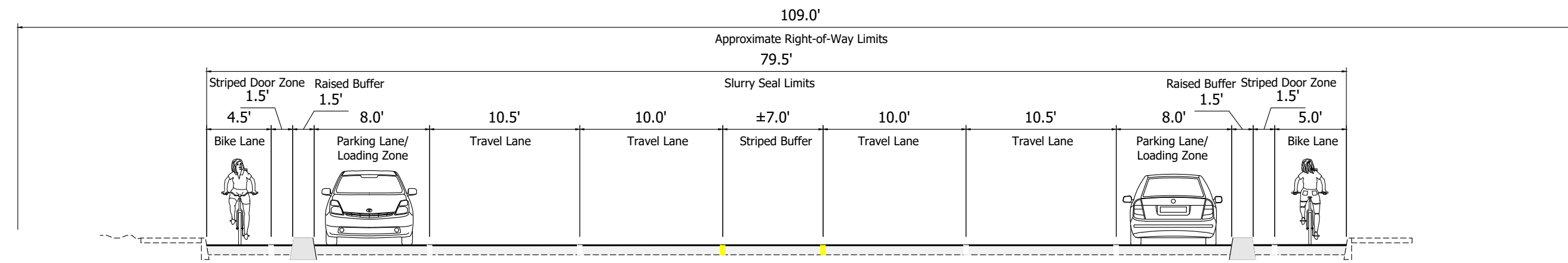

**SECTION A-A**

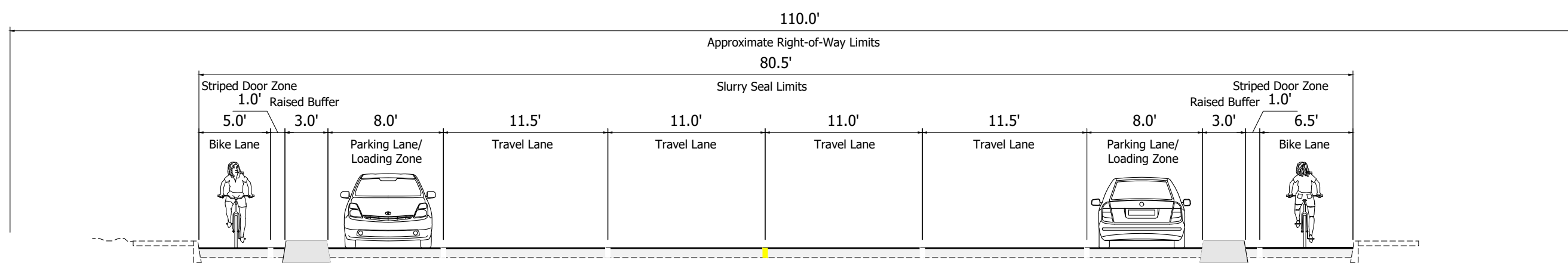

**SECTION B-B**

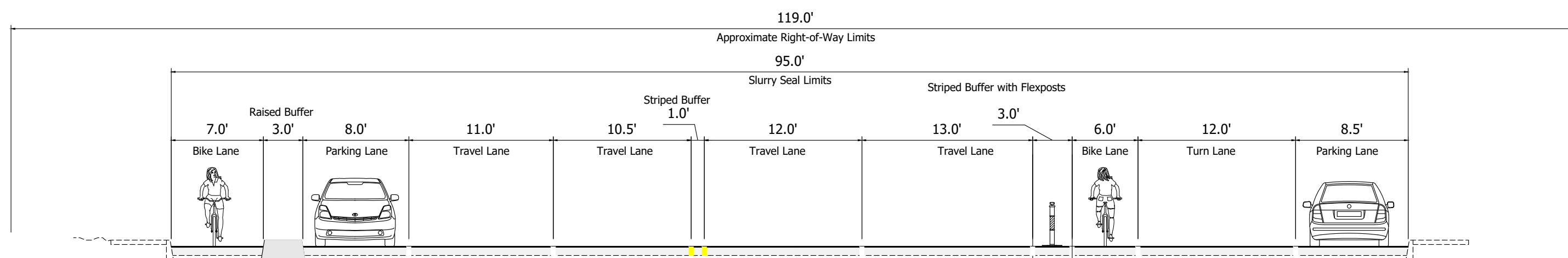

**SECTION C-C**

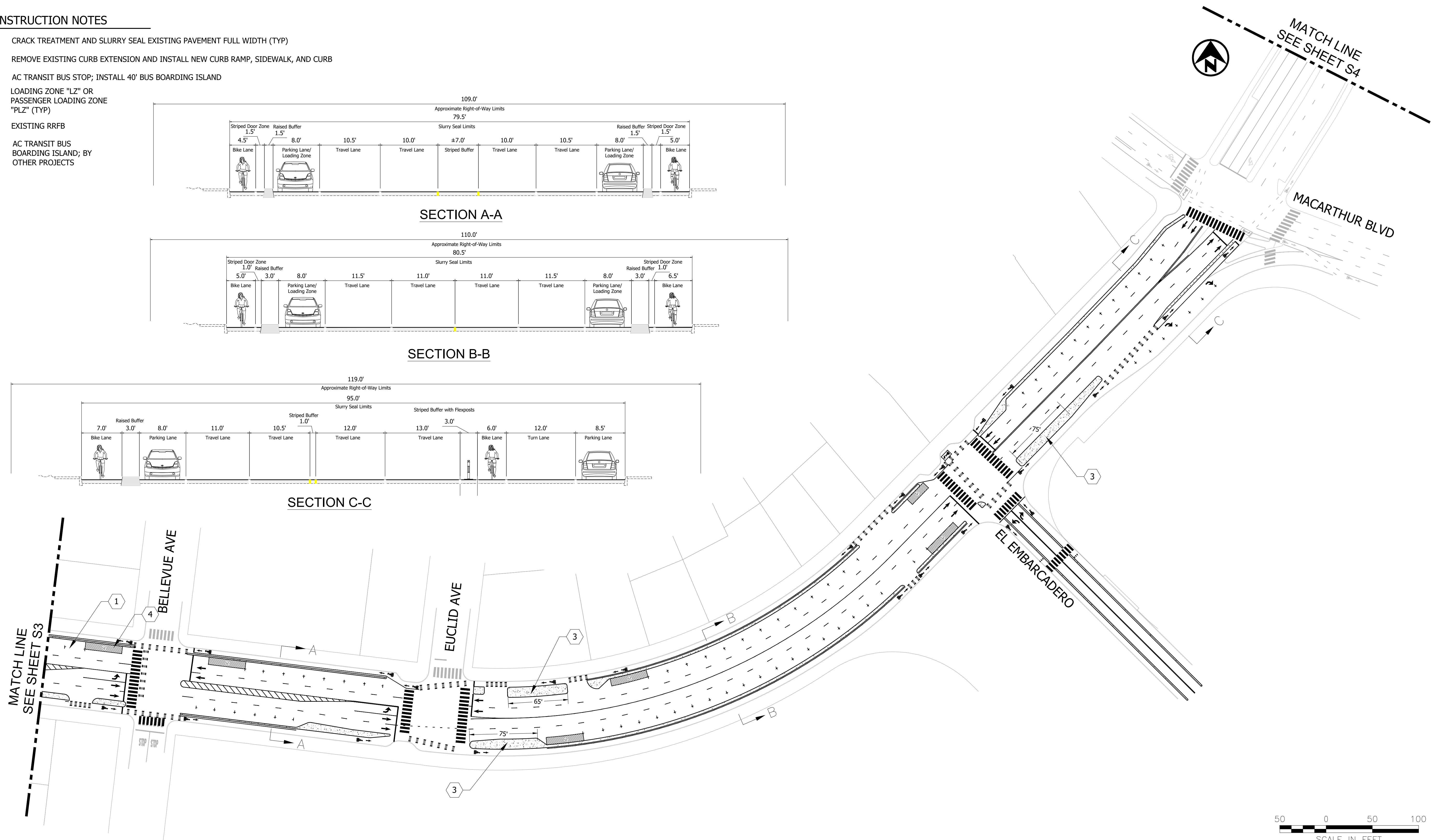

**KITTELSON & ASSOCIATES**  
 155 GRAND AVENUE, SUITE 505  
 OAKLAND, CA 94612  
 P 510.839.1742 F 510.839.0871

**GRAND AVENUE**

**CITY OF OAKLAND**  
 BUREAU OF ENGINEERING AND CONSTRUCTION SERVICES  
 250 FRANK OGAWA PLAZA, SUITE 4314 \* OAKLAND, CA 94612  
 (510) 238-3437 \* FAX (510) 238-7227  
 PROJECT NO. \_\_\_\_\_

CIVIL ENGINEER	No.	DATE	BY	REFERENCE
RCE NO. _____ EXP. _____				
CHECKED BY JGA				
DESIGNED BY MGA				
DRAWN BY KKD				

35% CONCEPT PLAN  
 NOT FOR CONSTRUCTION

**S4**

SCALE:  
 HOR. 1" = 50'  
 VERT. \_\_\_\_\_  
 DATE: 04/04/2023  
 SHEET NO.  
 4 OF 7

DRAWING NAME: H:\22\22521 - Oakland Transportation On-Call 2018\009 - Oak 35% Design\Grand Ave\design\_CD\22521\_009G-CD-SIGN&STRIP.dwg  
 PLOT DATE: 04-04-23  
 PLOTTED BY: Kkd

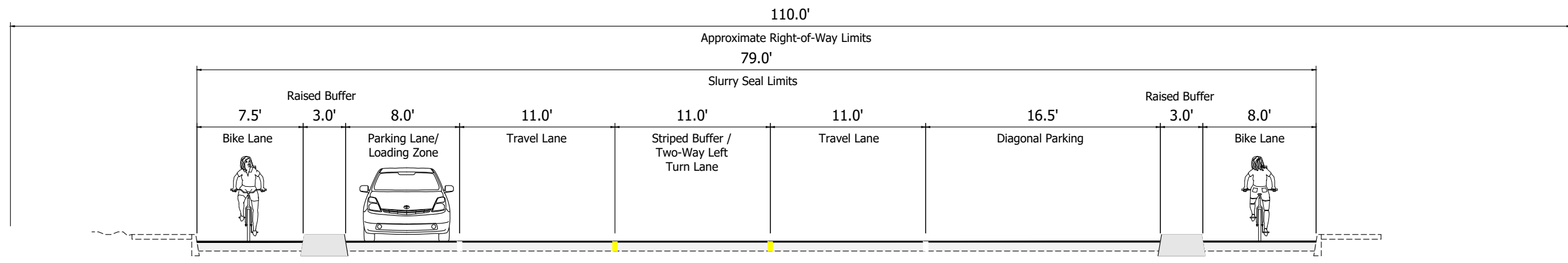

SECTION A-A

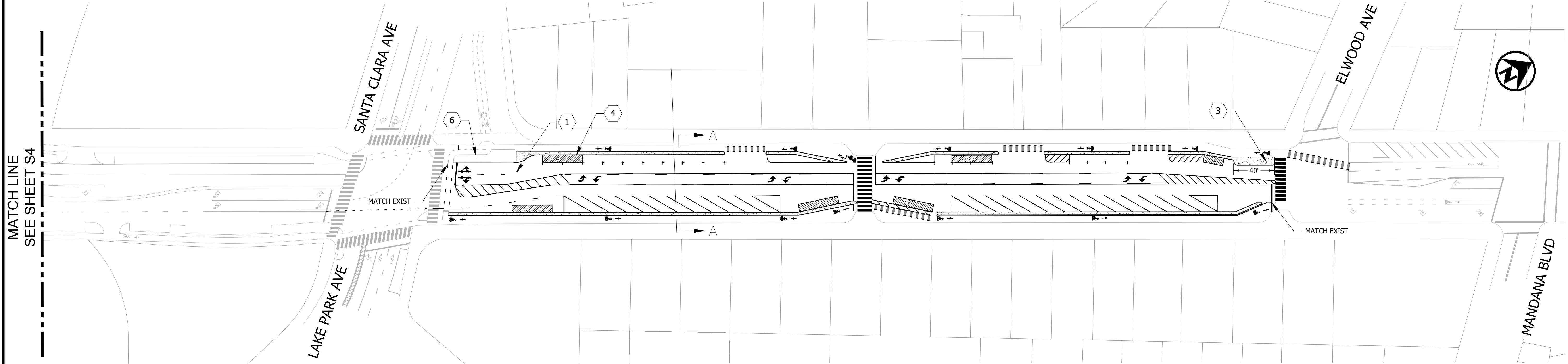

CONSTRUCTION NOTES

- 1 CRACK TREATMENT AND SLURRY SEAL EXISTING PAVEMENT FULL WIDTH (TYP)
- 2 REMOVE EXISTING CURB EXTENSION AND INSTALL NEW CURB RAMP, SIDEWALK, AND CURB
- 3 AC TRANSIT BUS STOP; INSTALL 40' BUS BOARDING ISLAND
- 4 LOADING ZONE "LZ" OR PASSENGER LOADING ZONE "PLZ" (TYP)
- 5 EXISTING RRFB
- 6 AC TRANSIT BUS BOARDING ISLAND; BY OTHER PROJECTS



 155 GRAND AVENUE, SUITE 505 OAKLAND, CA 94612 P 510.839.1742 F 510.839.0871	<b>GRAND AVENUE</b>	 <b>CITY OF OAKLAND</b> BUREAU OF ENGINEERING AND CONSTRUCTION SERVICES 250 FRANK OGAWA PLAZA, SUITE 4314 * OAKLAND, CA 94612 (510) 238-3437 * FAX (510) 238-7227 PROJECT NO. _____	CIVIL ENGINEER	No.	DATE	BY	REFERENCE	35% CONCEPT PLAN NOT FOR CONSTRUCTION	<b>S5</b>	SCALE: HOR. 1" = 50' VERT. _____ DATE: 04/04/2023 SHEET NO. 7 OF 7
			RCE NO. _____ EXP. _____							

DRAWING NAME: H:\2022\252521 - Oakland Transportation On-Call 2018\009 - Oak 35% Design\Grand Ave\design\_CD\252521\_009G\_CD\_SIGN&STRIP.dwg  
 PLOT DATE: 04-04-23  
 PLOTTED BY: Kkd