

ESTUARY PARK

RENOVATION & EXPANSION PROJECT



Community Meeting #2
December 5, 2018

[#OaklandEstuaryPark](#)



HARGREAVES
ASSOCIATES

WHY WE ARE HERE TONIGHT ...

WHERE WE HAVE COME FROM...

- **Community Meeting #1 – October 17 – listening**
- **Over 130 people attended**
- **Over 700 survey responses**

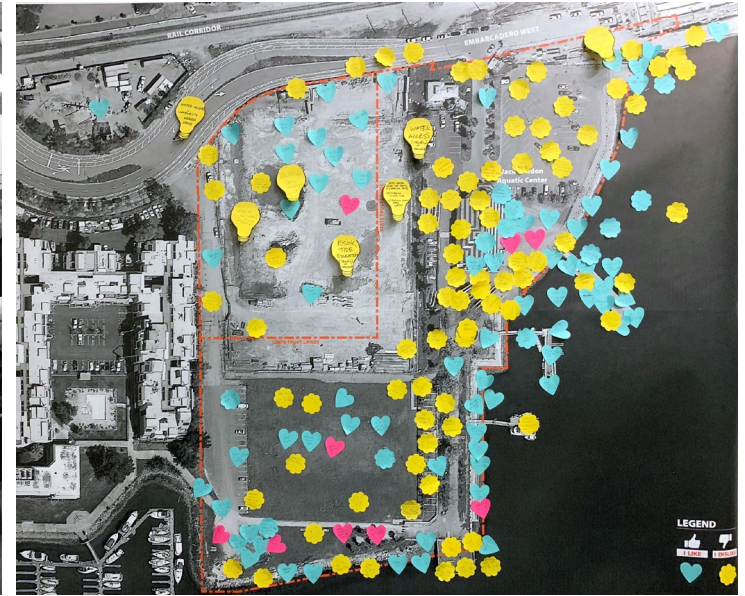

WHERE ARE WE GOING?

- We will use your feedback from this meeting to develop one preferred conceptual direction
- Next Public Park Design Meeting: **MID JANUARY 2019**



Schedule

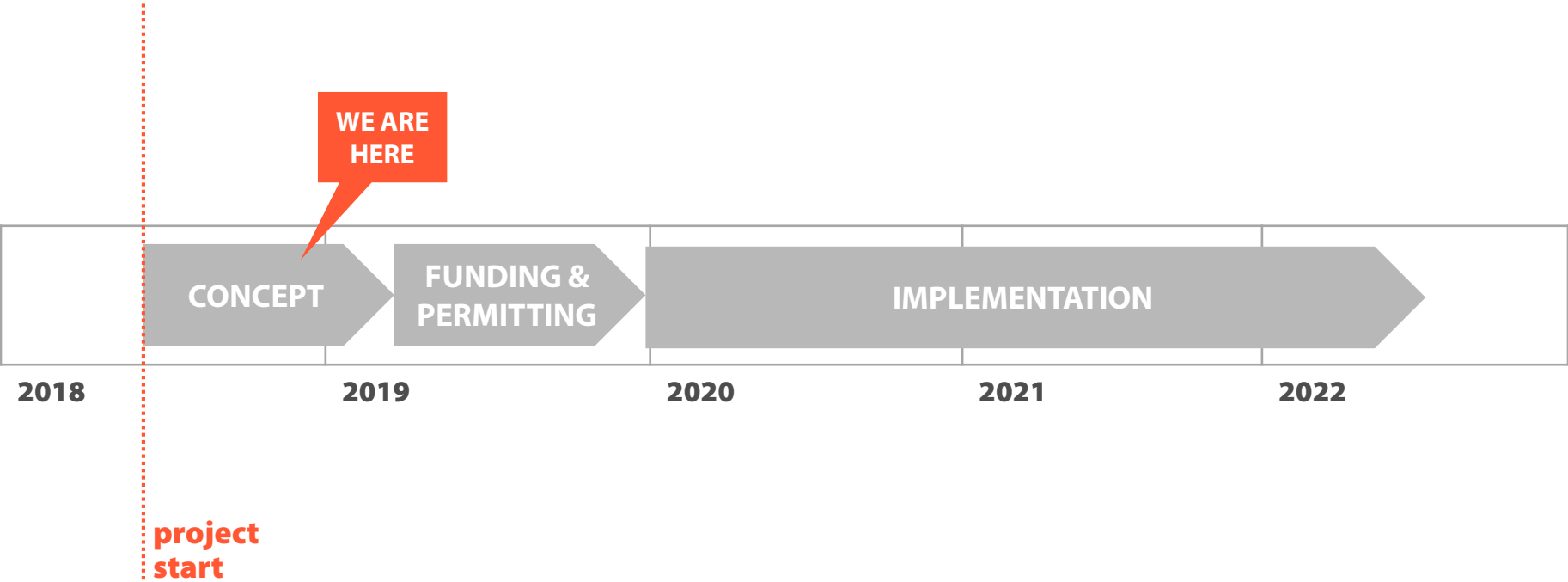

AGENDA

01 understanding site recap

02 what we heard

03 conceptual designs

04 table sessions

Regional Context

LAKESIDE PARK
Completed in 2016

SNOW PARK
Completed in 2017

BOATHOUSE
Completed in 2009

**12TH STREET PARK /
LAKE MERRITT AMPHITHEATER**
Completed in 2013

ESTUARY PARK



SPLASH PAD PARK
Completed in 2013

LAKE MERRITT TRAIL
Completed in 2010

LANEY COLLEGE MP
Updated in 2015

GAP CLOSURE PROJECT
Anticipated construction begins: 2020

BROOKLYN BASIN DEVELOPMENT
Mixed-Use Development
Phase 1 under construction
64 acres total with 30 acres of publicly
accessible parks, trails and marinas

Adjacent Context

BROOKLYN BASIN DEVELOPMENT (Signature Development Group)



ESTUARY PARK (City of Oakland Open Space)

Historical Use 1857

SAN ANTONIO CREEK CALIFORNIA

From a Trigonometrical Survey
under the direction of A.D. BACHE Superintendent of the
SURVEY OF THE COAST OF THE UNITED STATES

Triangulation by R.D. CUTTS Assist. Topography by A.E. RODGERS Sub-Assist.

Hydrography by the Party

under the command of Comdr. JAMES ALDEN U.S.N. Assist.

Scale 50000

1857

The soundings are expressed in feet to 18 feet, or within the dotted surface beyond them in fathoms, and show the depth at the mean of the low water of each 24 hours the plane of reference. The dotted surface beyond low water mark represent the bottom within the respective depths of 6, 12, and 18 feet. The characteristic sounding only are given on the map; they are selected from the numerous soundings taken in the survey, so as to represent the figure of the bottom.

Latitude of San Antonio Creek 34° 42' 27"
Longitude of do. west from Greenwich Obs'y in arc 122° 13' 22"
Longitude of do. do. do. in time 8^h 08^m 53^s

TIDES
Mean Rise and Fall of Tides 4-3.3

Abbreviations used in the soundings
S. for Sound fms. for Fathoms
sft. " " soft
stk. " " stick

**ESTUARY
PARK**

Current shoreline

Historical Use 1929



Historical Use 1976 Concept Design

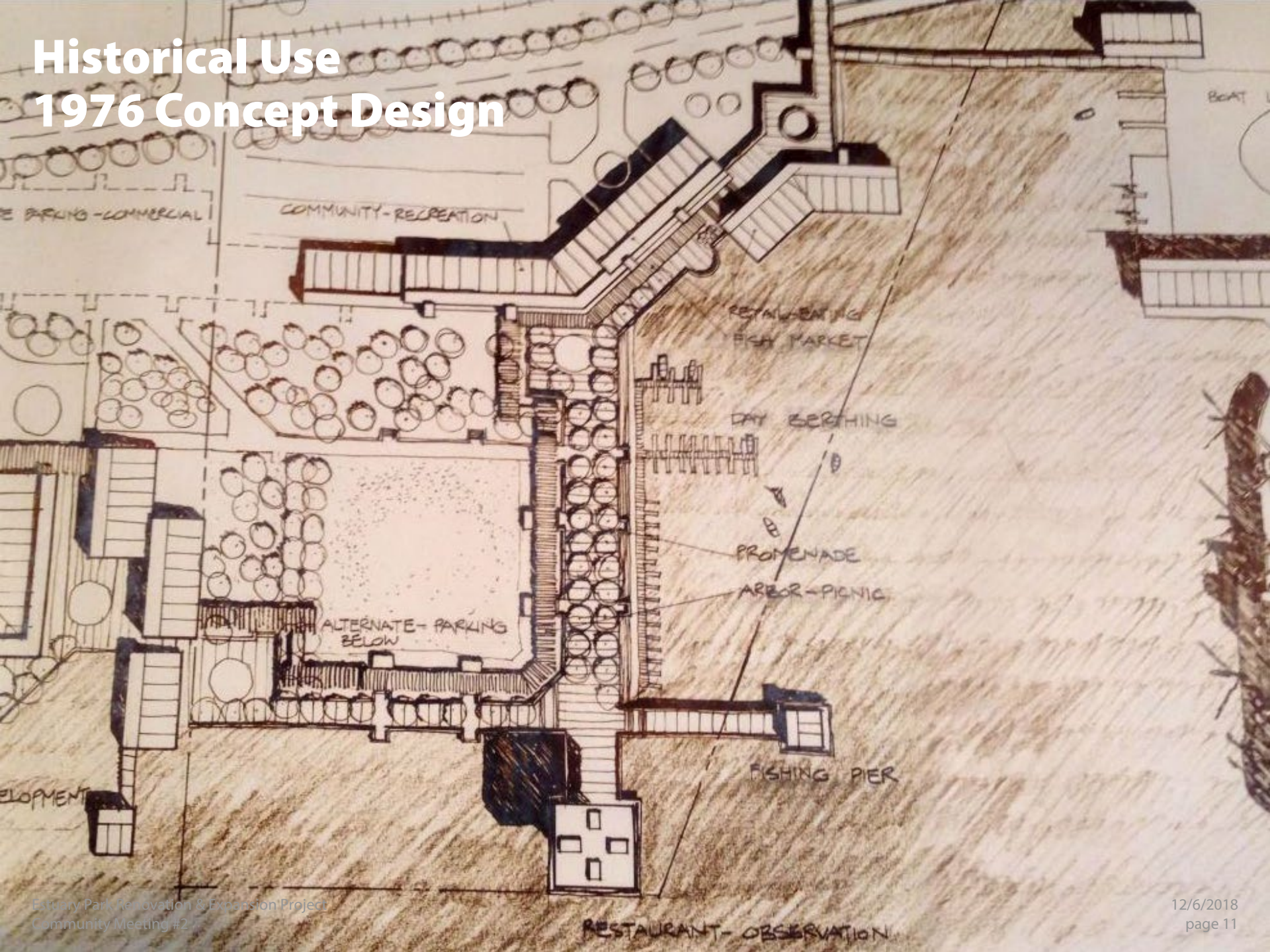



**FUTURE
MIXED-USE
REDEVELOPMENT**

**EMBARCADERO
BRIDGE (UNDER
CONSTRUCTION)**

**TO LAKE
MERRITT
BART STATION
(5 MIN WALK)**

**EXTRA SPACE
STORAGE**

**FUTURE
SHIPPING
CONTAINER
BEER GARDEN**

**SAFE ACCESS
IMPROVEMENTS**

**FUTURE
BROOKLYN
BASIN
DEVELOPMENT**

**ADDITIONAL LAND
(FORMER CASH
AND CARRY SITE)
(4 acres)**

JLAC

**PORTOBELLO
HOMEOWNERS
ASSOCIATION**

**EXISTING
ESTUARY
PARK
(7 acres)**

**OAKLAND
ESTUARY**

**AQUA VIA
APARTMENTS**

KTVU

**EVE'S
WATERFRONT
RESTAURANT**



Site Challenges

USE RESTRICTIONS - State Trust Lands

The use must accommodate or enhance the Statewide's public enjoyment, not merely a local or municipal benefit.

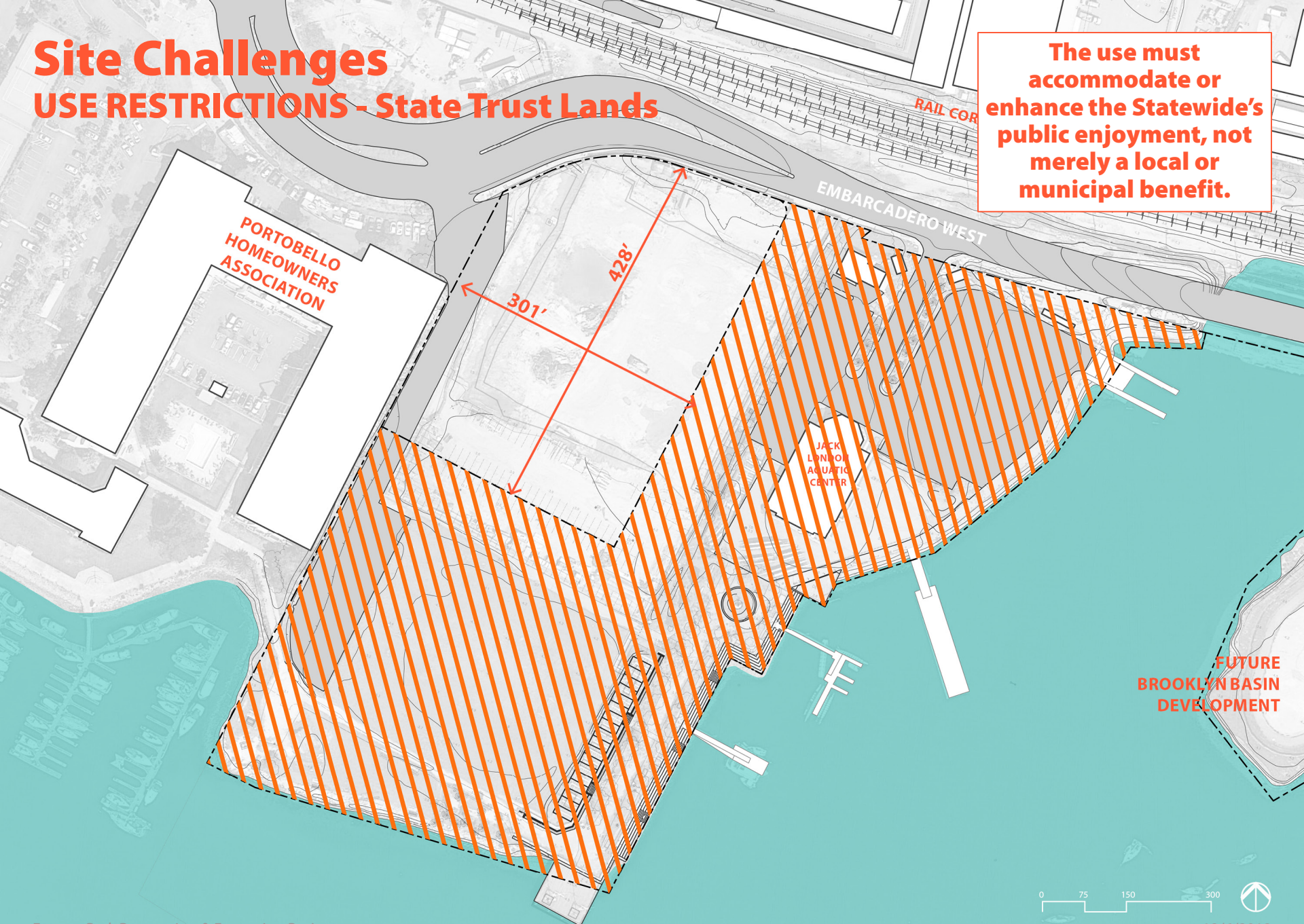

Site Challenges

USE RESTRICTIONS - BCDC

Must provide public waterfront access

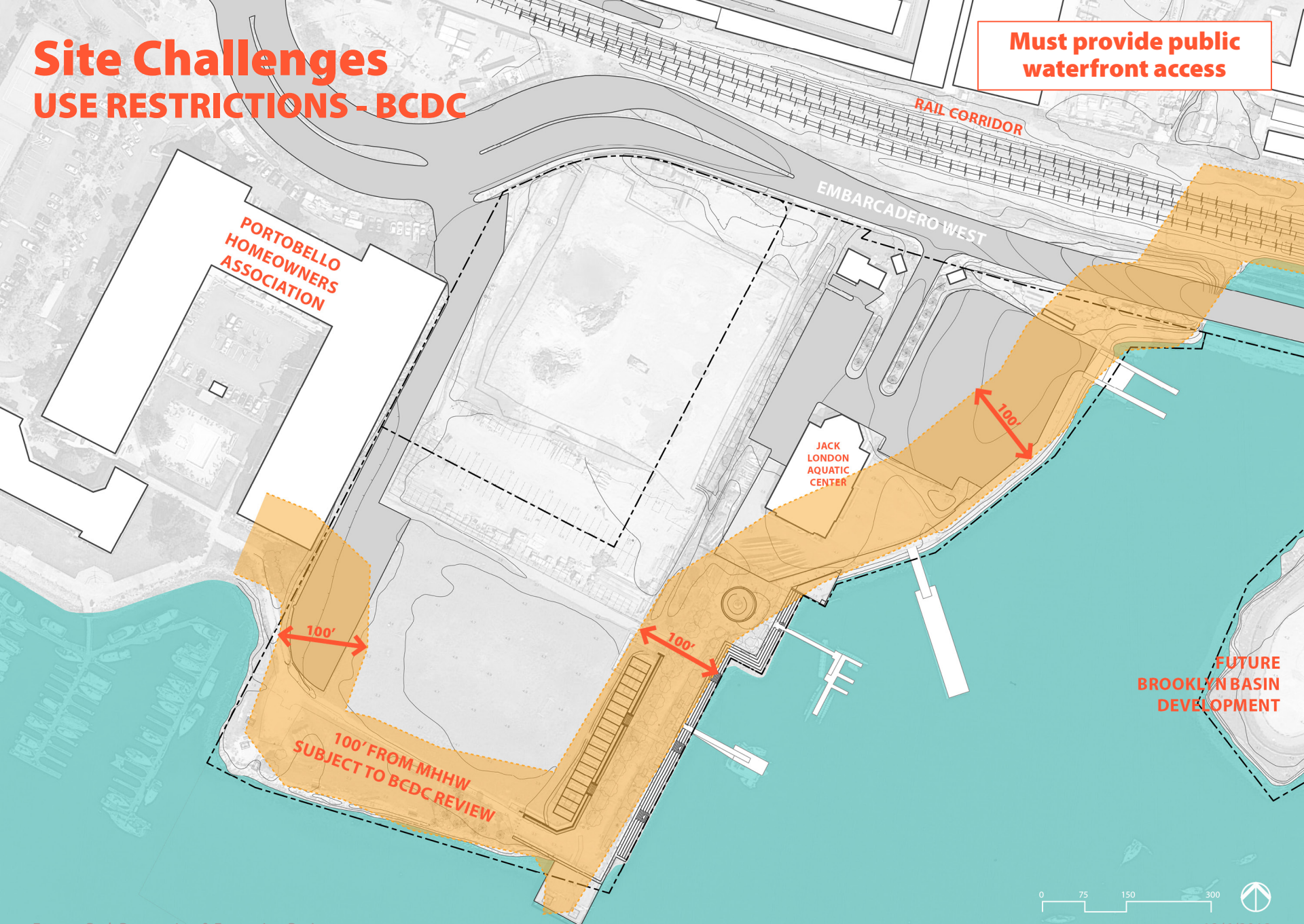

Site Challenges

USE RESTRICTIONS - EBMUD

Non-permanent use only

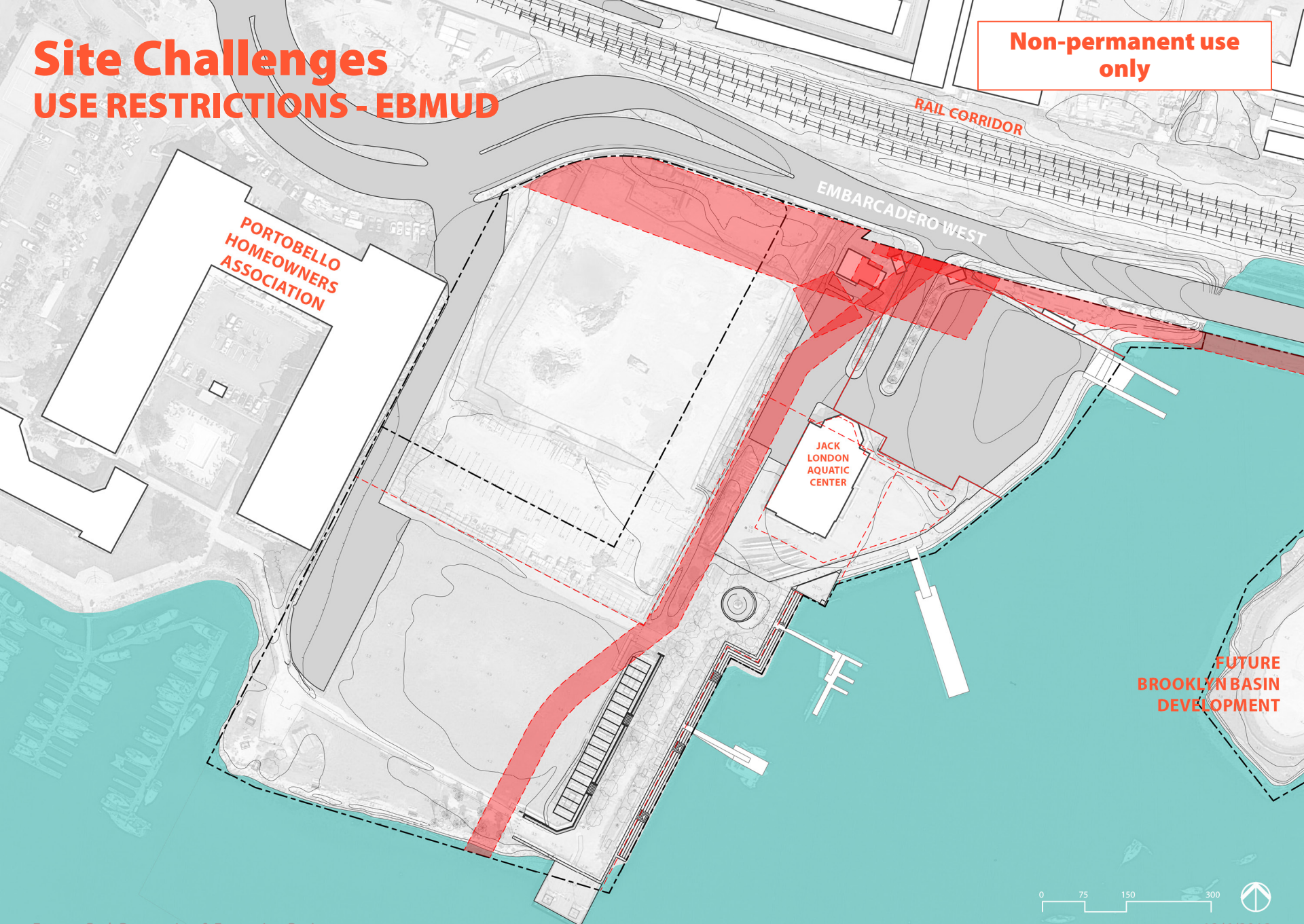

Site Challenges REMEDIATION

All Remediation will be done by others

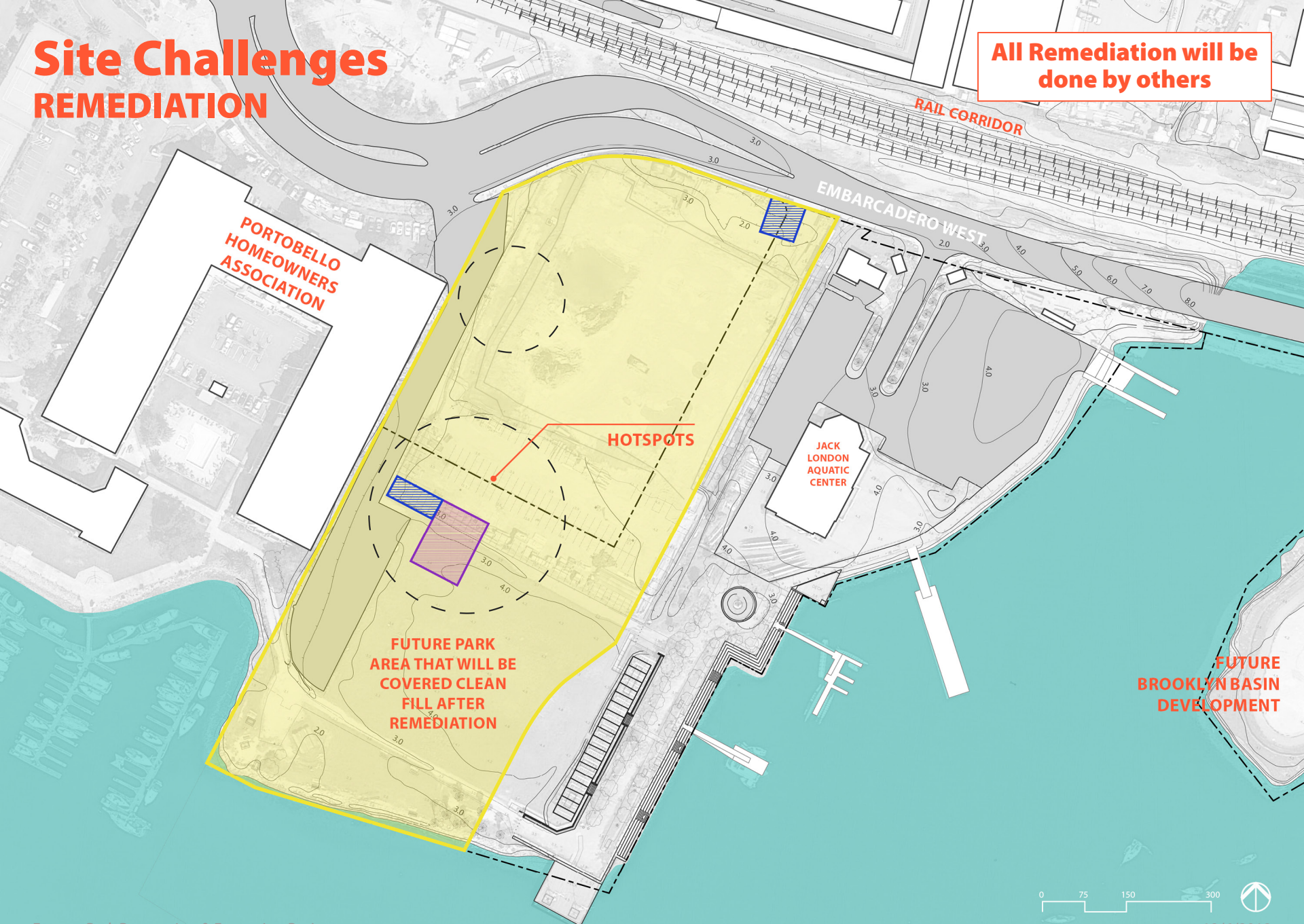

Site Challenges

SEA LEVEL RISE

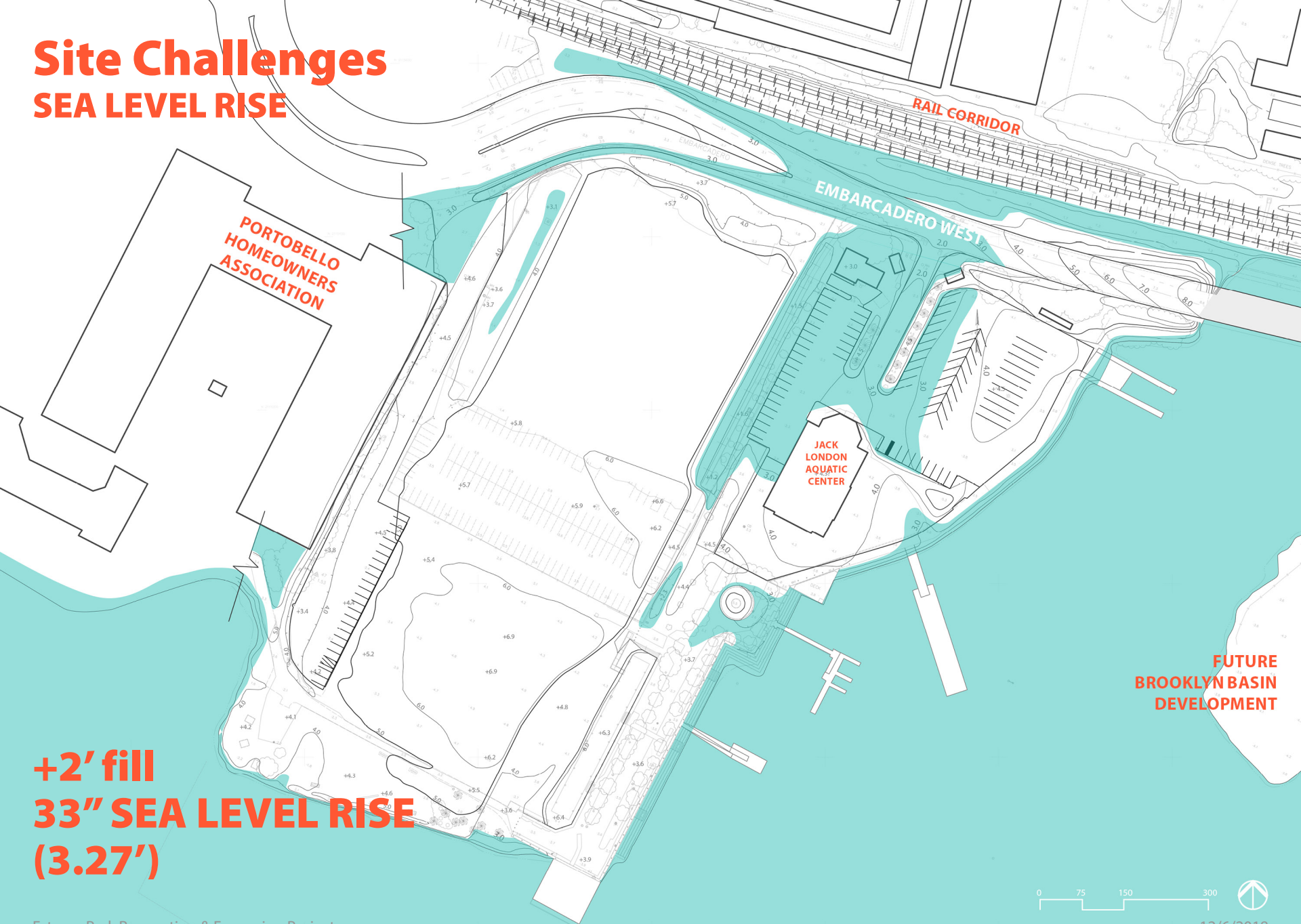

+2' fill
33" SEA LEVEL RISE
(3.27')

Site Challenges

SEA LEVEL RISE

PORTOBELLO
HOMEOWNERS
ASSOCIATION

RAIL CORRIDOR

EMBARCADERO WEST

JACK
LONDON
AQUATIC
CENTER

FUTURE
BROOKLYN BASIN
DEVELOPMENT

+2' fill
33" SEA LEVEL RISE + KING TIDE
(5.06')



AGENDA

01 understanding site recap

02 what we heard

03 conceptual designs

04 table sessions

Community Meeting # 1

over 135 PARTICIPANTS

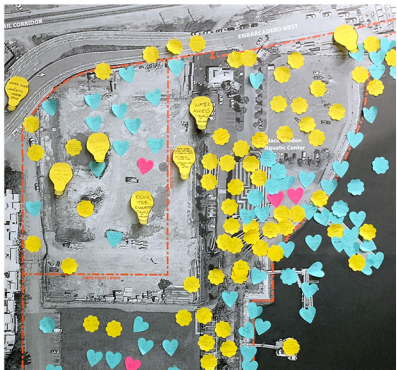

Community Meeting # 1

LET'S MAKE OAKLAND'S ESTUARY PARK BIGGER AND BETTER!

STOP 4
FORMER CASH & CARRY SITE & ACCESS

STOP 1
BOAT RAMP / PARKING LOT

ADDITIONAL LAND (FORMER CASH AND CARRY SITE) (4 acres)

JLAC

EXISTING ESTUARY PARK (7 acres)

STOP 3
WEST EDGE

STOP 2
ESTUARY PARK PIER

PORTOBELLO HOMEOWNER'S ASSOCIATION

OAKLAND ESTUARY

OAK STREET

EMBARCADERO WEST

0 30' 150'

I LIKE _____

I DISLIKE _____

TAKE PHOTOS AND TAG THEM! #OaklandEstuaryPark



"Access to sun, wind, water, views"

"Rowing"

"Views"

"The quiet of the water, access to the waterfront, bird watching on the water"

"Being able to access the water for boating, the sculptures, the open space"



I DISLIKE

"No lighting, no landscaping, deserted soccer field"

"State of disrepair, lack of restrooms, deteriorating building"

"Ugly, dysfunctional picnic area and trellis"

"Steps down to water and rip rap are not used"

"The existence of cars, BAD connectivity, nowhere to stop and have a beer"

"No public restrooms, needs a playground, more landscaping"

Community Meeting # 1

"BRIGHT" Ideas

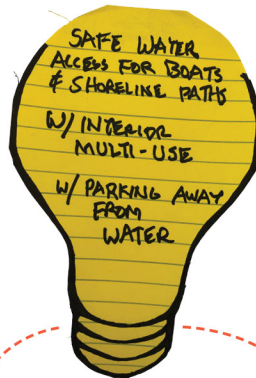
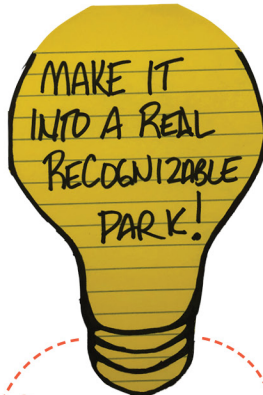
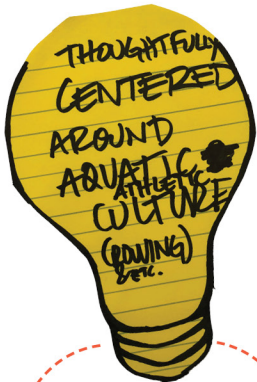
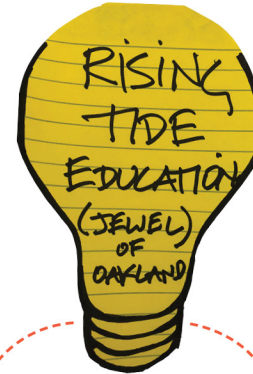
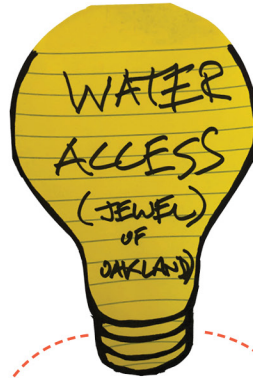
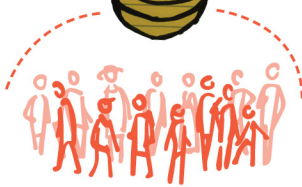

Community Meeting # 1

over 710
RESPONSES



ESTUARY PARK COMMUNITY MEETING #1 ACTIVITIES & AMENITIES SURVEY

QUESTION 01: What would you like to see and do in the park?

Choose 3 *preferred activities* within each category. The park cannot fit everything on the list, but your responses will help identify broad community preferences.

HEALTH & WELLNESS	SPORTS / GAMES / PLAY	SOCIAL / GATHERING / CULTURE
<input type="radio"/> Walking <input type="radio"/> Running / Jogging <input type="radio"/> Stair climbing <input type="radio"/> Cycling <input type="radio"/> Roller skating / blading <input type="radio"/> Exercise circuit <input type="radio"/> Work out classes <input type="radio"/> Sitting <input type="radio"/> Relaxing / Finding peace <input type="radio"/> Enjoying nature / Beauty <input type="radio"/> Tai Chi / Yoga <input type="radio"/> other _____ <input type="radio"/> other _____	<input type="radio"/> Casual Pick-up games (frisbee, catch, kite flying, soccer) <input type="radio"/> Court games <input type="radio"/> Children's play <input type="radio"/> Water play <input type="radio"/> Dog play <input type="radio"/> Chess / Checkers <input type="radio"/> Bocce / Horseshoes <input type="radio"/> Skateboarding <input type="radio"/> Rock climbing <input type="radio"/> Fitness course <input type="radio"/> other _____ <input type="radio"/> other _____	<input type="radio"/> Picnics / Grilling <input type="radio"/> Food trucks <input type="radio"/> Food carts <input type="radio"/> Food Kiosk / Cafe <input type="radio"/> Local farmers market <input type="radio"/> Outdoor family gatherings / birthdays <input type="radio"/> Outdoor weddings <input type="radio"/> Outdoor performances / events <input type="radio"/> Outdoor movies <input type="radio"/> Art festival <input type="radio"/> Senior's classes <input type="radio"/> other _____ <input type="radio"/> other _____

WATERFRONT ACTIVITIES	ART / EDUCATION	SUPPORT & MOBILITY
<input type="radio"/> Human-powered boating <input type="radio"/> Power boating <input type="radio"/> Fishing <input type="radio"/> Bird-watching <input type="radio"/> Viewing area / deck / overlook <input type="radio"/> Kayaking and paddle board rental <input type="radio"/> Rowing <input type="radio"/> Dragon boating <input type="radio"/> Fish cleaning <input type="radio"/> other _____ <input type="radio"/> other _____	<input type="radio"/> Permanent public art/sculpture <input type="radio"/> Temporary art installations / Art walks <input type="radio"/> Outdoor art classes <input type="radio"/> Outdoor environmental education <input type="radio"/> Water conserving gardens <input type="radio"/> Bioswales <input type="radio"/> Youth/school programs <input type="radio"/> Historic interpretations <input type="radio"/> Information kiosks <input type="radio"/> other _____ <input type="radio"/> other _____	<input type="radio"/> Vehicle parking <input type="radio"/> Boat trailer parking <input type="radio"/> Bicycle parking <input type="radio"/> Vehicle drop-off / pick-up <input type="radio"/> Restrooms <input type="radio"/> Showers <input type="radio"/> Park information <input type="radio"/> Bike rentals <input type="radio"/> Staff/Security <input type="radio"/> other _____ <input type="radio"/> other _____

QUESTION 02: What word or phrase best describes what you think Estuary Park should be? _____

QUESTION 03: What is your favorite Oakland Park, and why? _____

QUESTION 04: What is your favorite park anywhere, and why? _____

Zip-code where you live: _____ Your age (choose one): Under 18 18-25 26-35 36-45 46-55 56 - 65 65+

OTHER COMMENTS: _____

TO BE ON OUR MAILING LIST AND KEEP UP-TO DATE ON THIS PROJECT, PLEASE SIGN UP BELOW:

Name: _____
 E-mail: _____

Please visit www.oaklandca.gov/projects/estuary-park to learn more about the project and fill out the online survey!

SURVEY WILL CLOSE ON NOV. 7 at 11:59pm

THANK YOU - LET'S MAKE OAKLAND'S ESTUARY PARK BIGGER AND BETTER!

Community Meeting # 1

**SPORTS /
GAMES /
PLAY**



**SOCIAL /
GATHERING /
CULTURE**



**HEALTH &
WELLNESS**



**WATERFRONT
ACTIVITIES**



**SUPPORT &
MOBILITY**



**ART /
EDUCATION**



What we heard

QUESTION 01: What would you like to see and do in the park?

HEALTH & WELLNESS

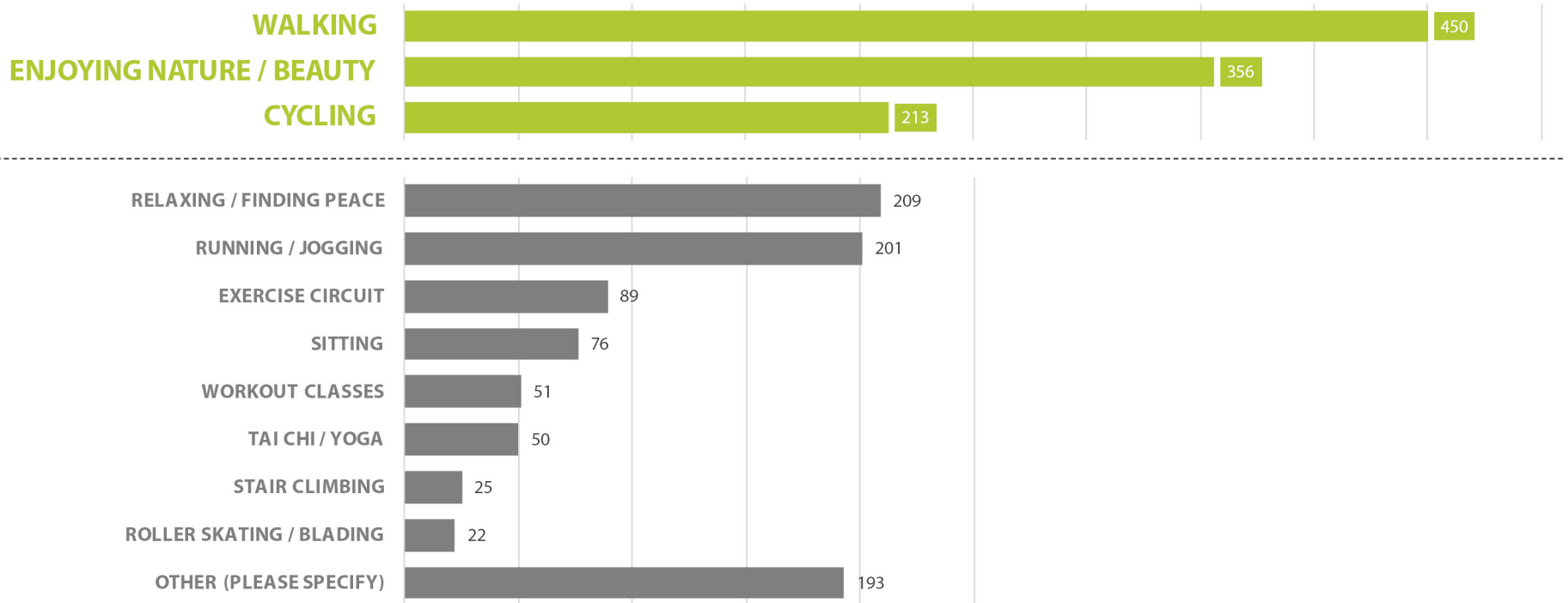

What we heard

QUESTION 01: What would you like to see and do in the park?

SPORTS / GAMES / PLAY

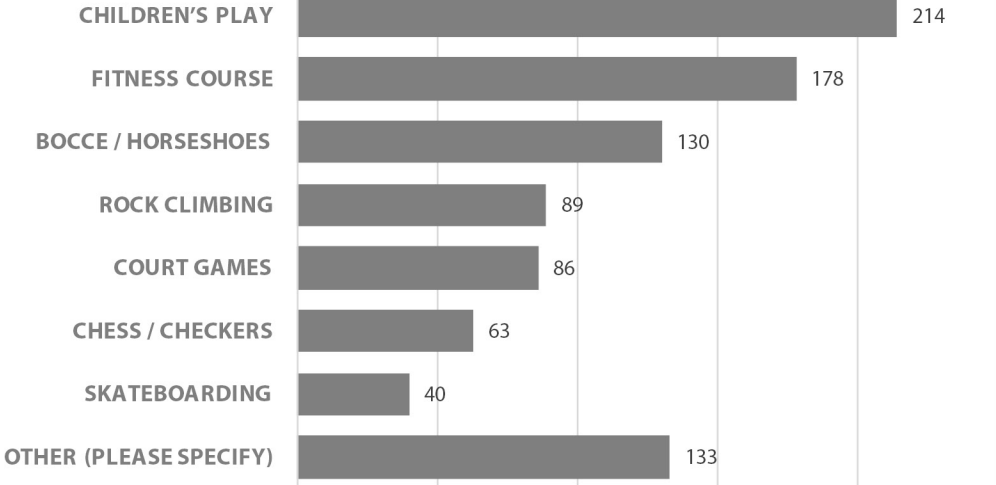

What we heard

QUESTION 01: What would you like to see and do in the park?

SOCIAL / GATHERING / CULTURE

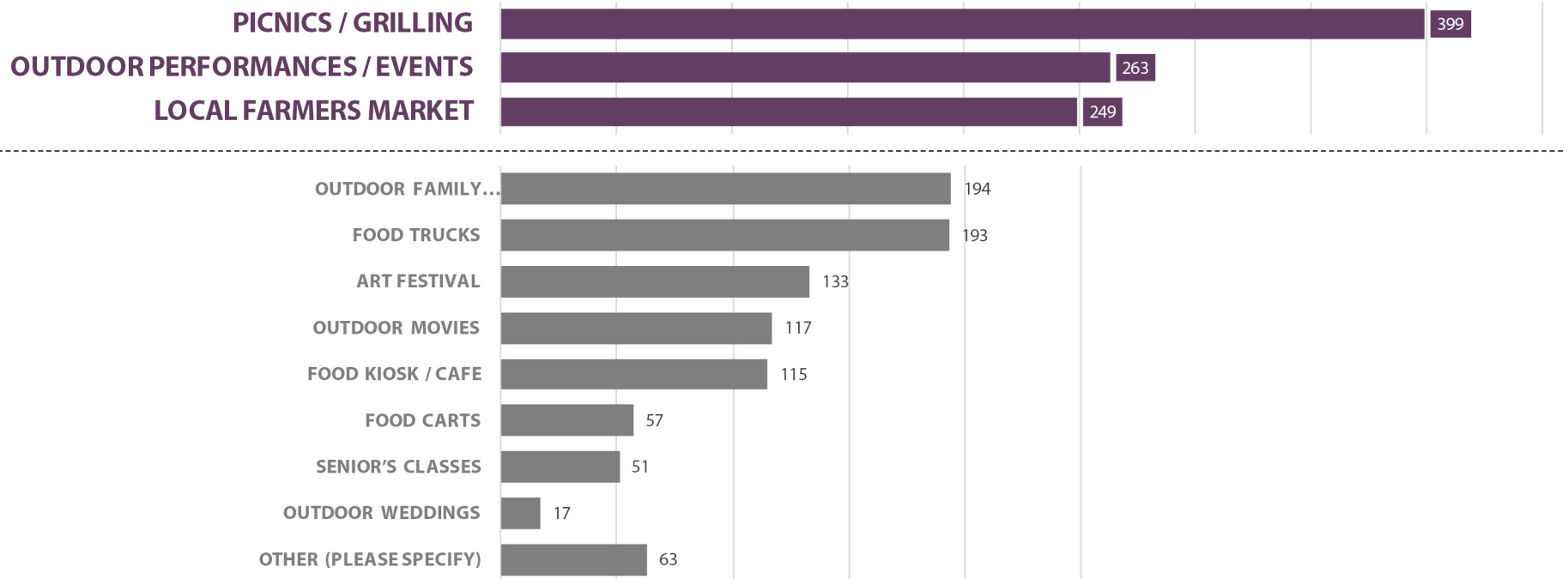

What we heard

QUESTION 01: What would you like to see and do in the park?

WATERFRONT ACTIVITIES

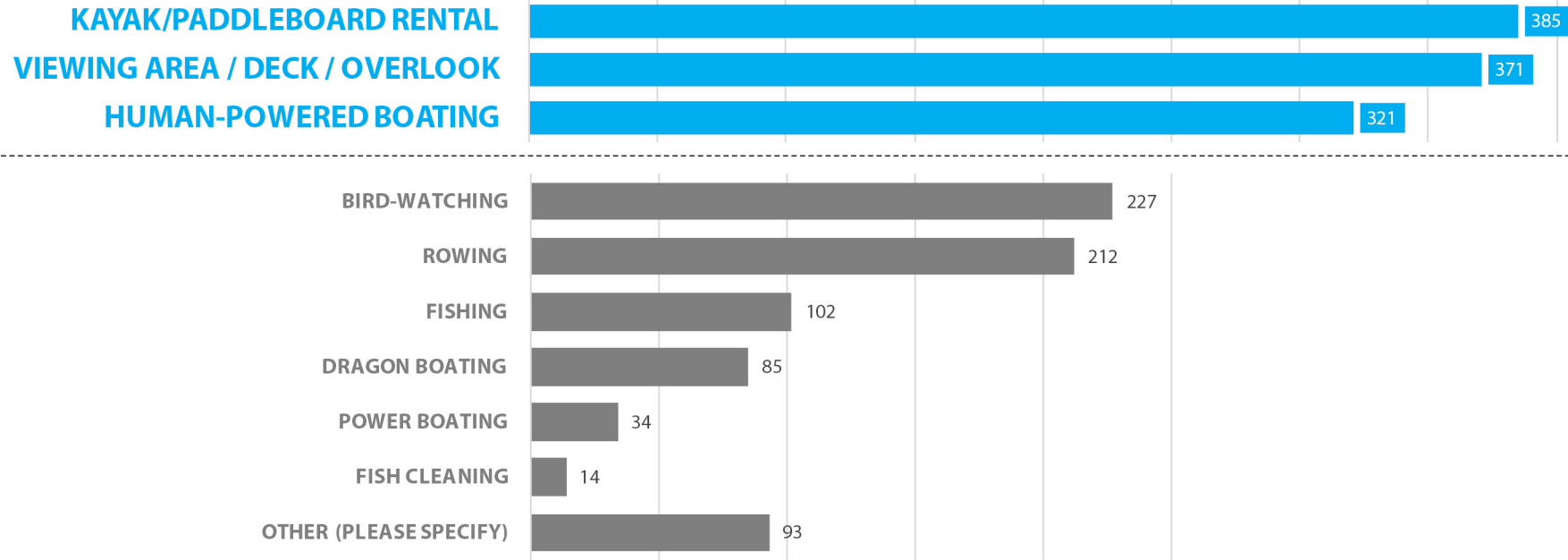

What we heard

QUESTION 01: What would you like to see and do in the park?

ART / EDUCATION

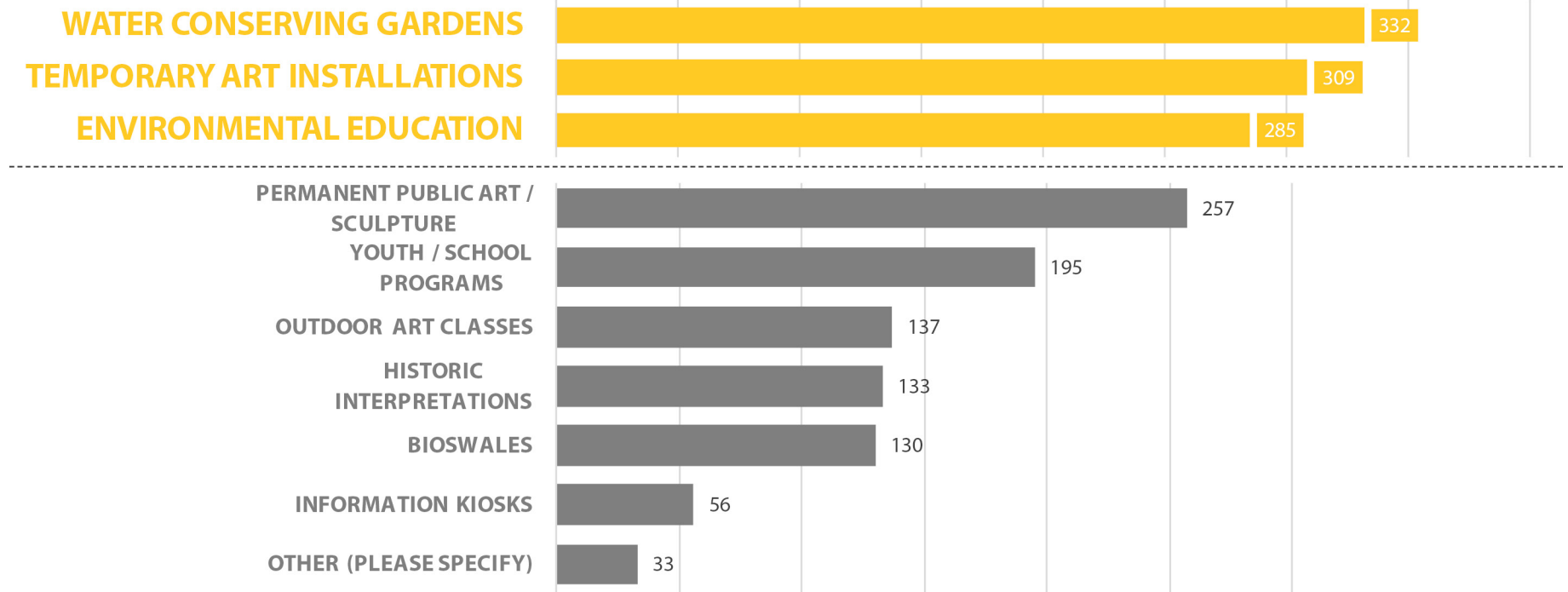

What we heard

QUESTION 01: What would you like to see and do in the park?

SUPPORT & MOBILITY

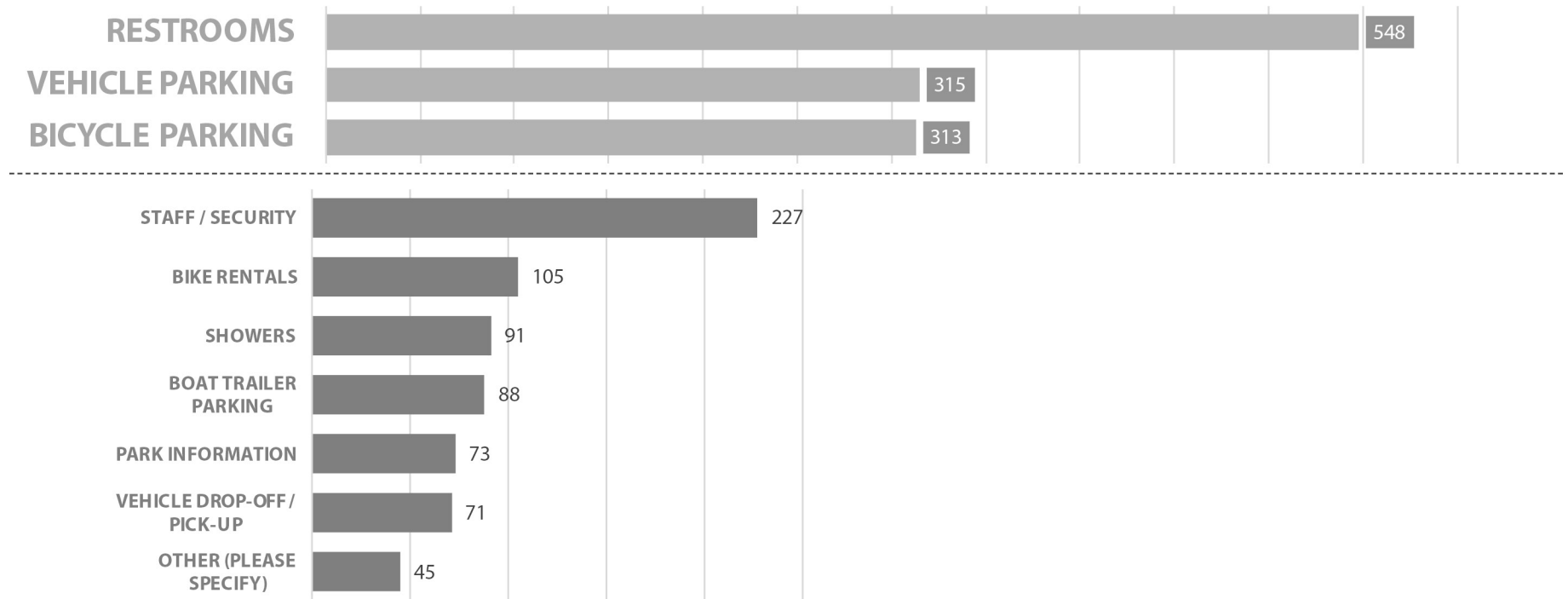

What we heard

QUESTION 01: What would you like to see and do in the park?

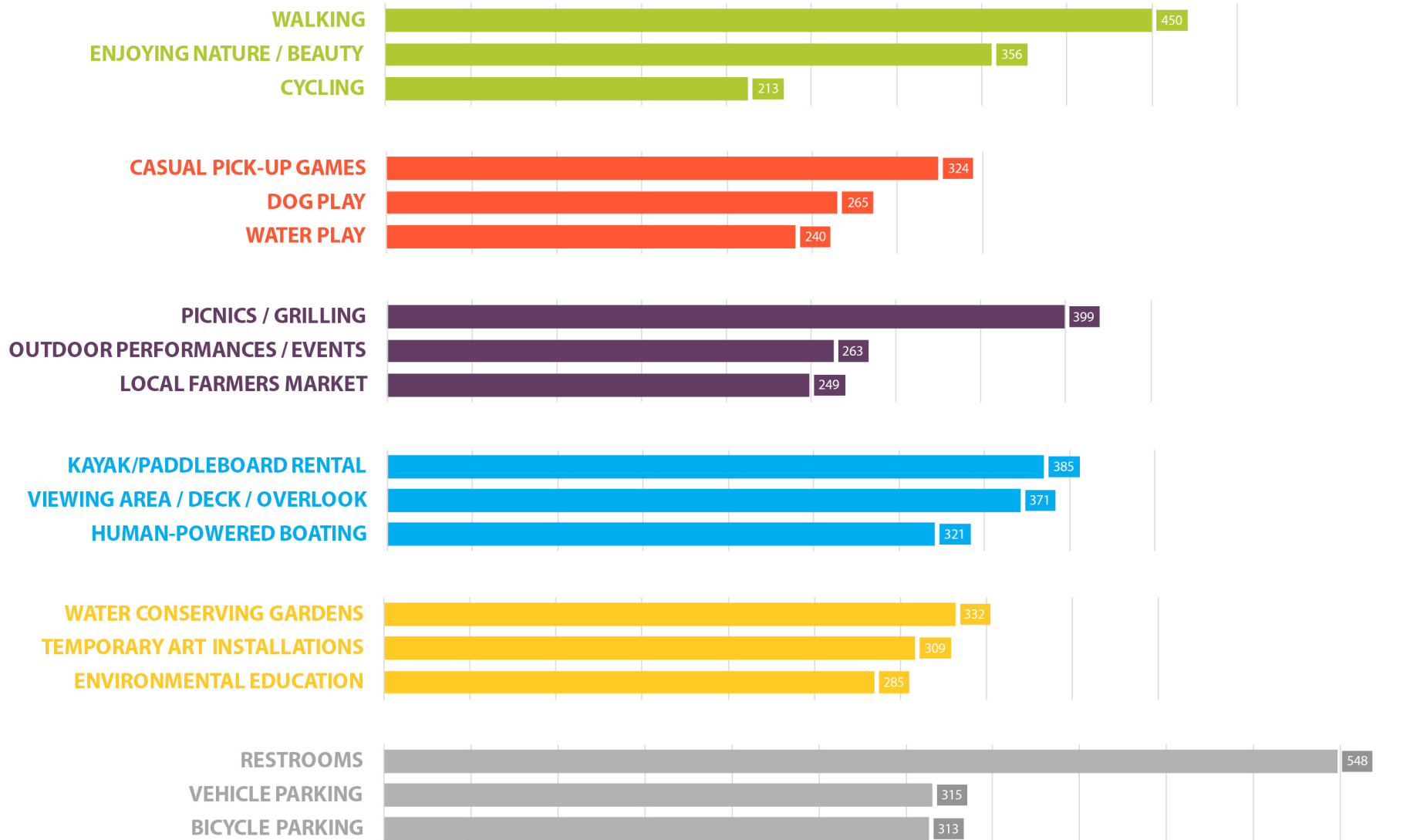

What we heard

QUESTION 02: What word or phrase best describes what you think Estuary Park should be?



What we heard

QUESTION 03: What is your favourite Oakland Park, and why?



What we heard

QUESTION 04: What is your favourite park anywhere, and why?



KEY THEMES

Key Themes: Natural Respite



environmental education

Key Themes: Community



events

Key Themes: Water Access



Key Themes: Water Oriented



resiliency to sea level rise

Key Themes: Community



a place to bring your dog



picnic / bbq

Key Themes: Tranquil & Peaceful



Key Themes: Fun & Family Friendly



children's play

Key Themes: Accessible & Safe



AGENDA

01 understanding site recap

02 what we heard

03 conceptual designs

04 table sessions

Approach

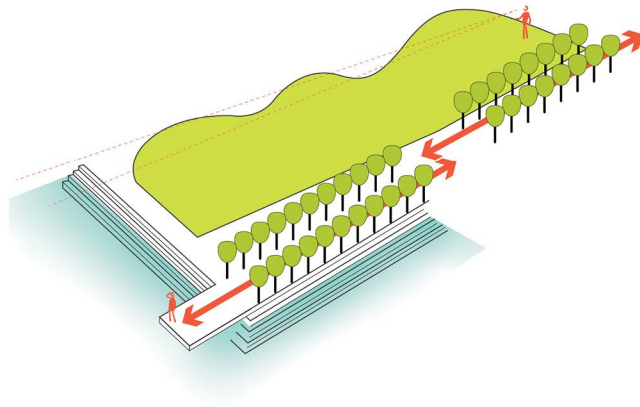

concept 01

URBAN GREEN

historical reference
long open space
hard water edge

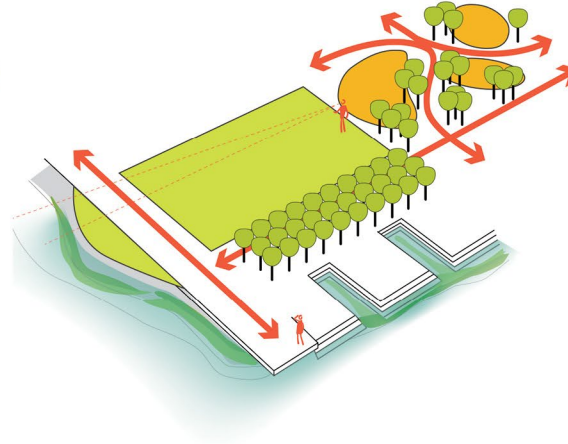

concept 02

LANDSCAPE GREEN

sequential
outdoor rooms
landscape water edge



concept 03

TIDAL GREEN

meandering
blended
soft, tidal edge

concept 01

URBAN GREEN

concept 01: URBAN GREEN

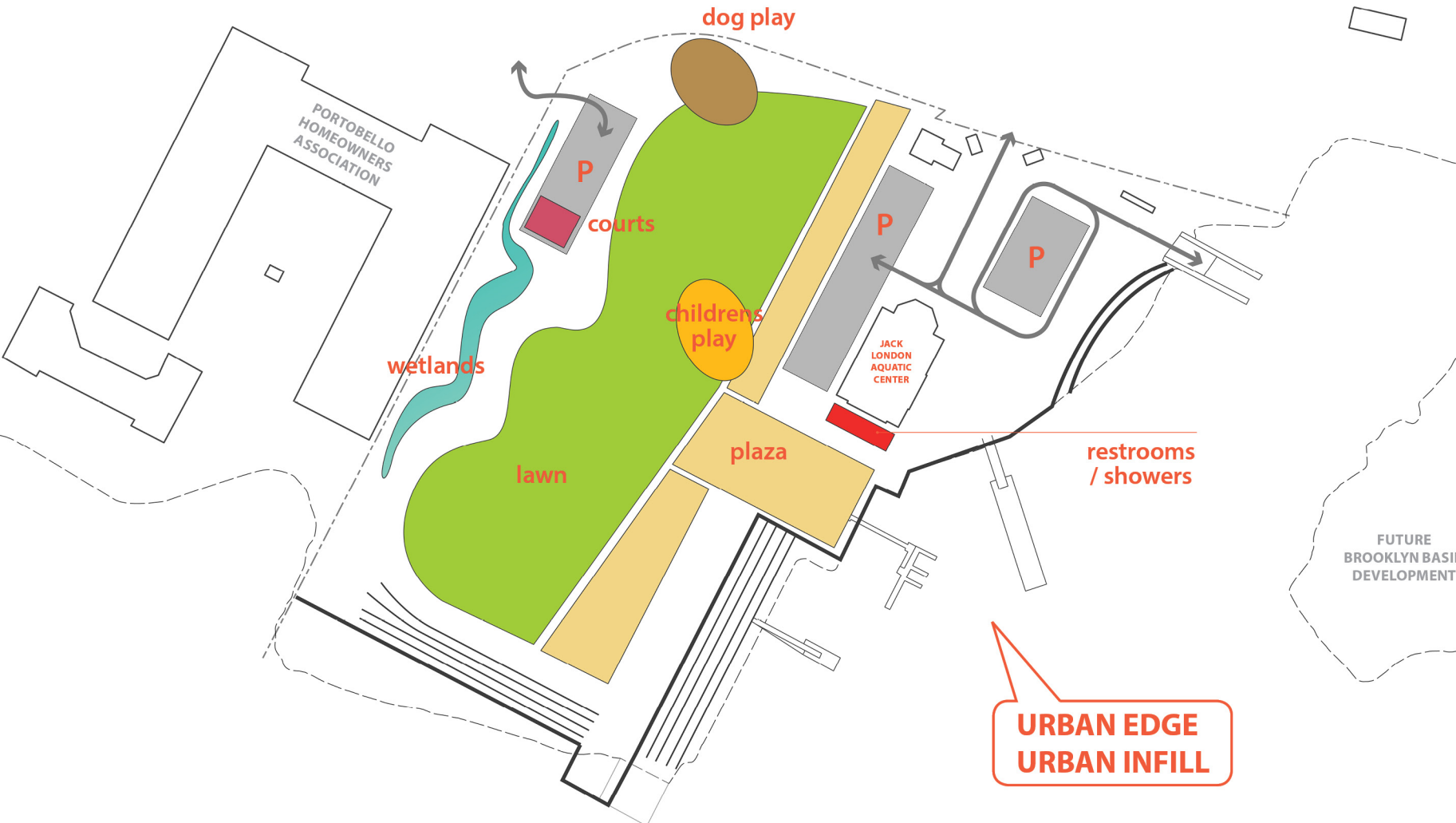

concept 01: **URBAN GREEN**

LOOK & FEEL

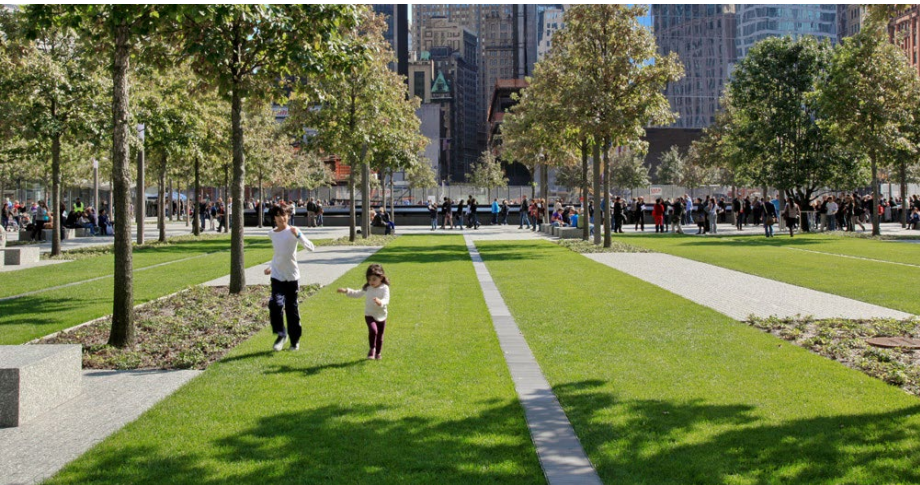

concept 01: URBAN GREEN

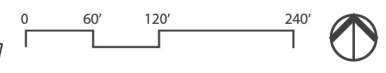

concept 01: **URBAN GREEN**



concept 01: **URBAN GREEN**

PROGRAM & SPACES



concept 01: **URBAN GREEN**

EDGES



concept 01: **URBAN GREEN**

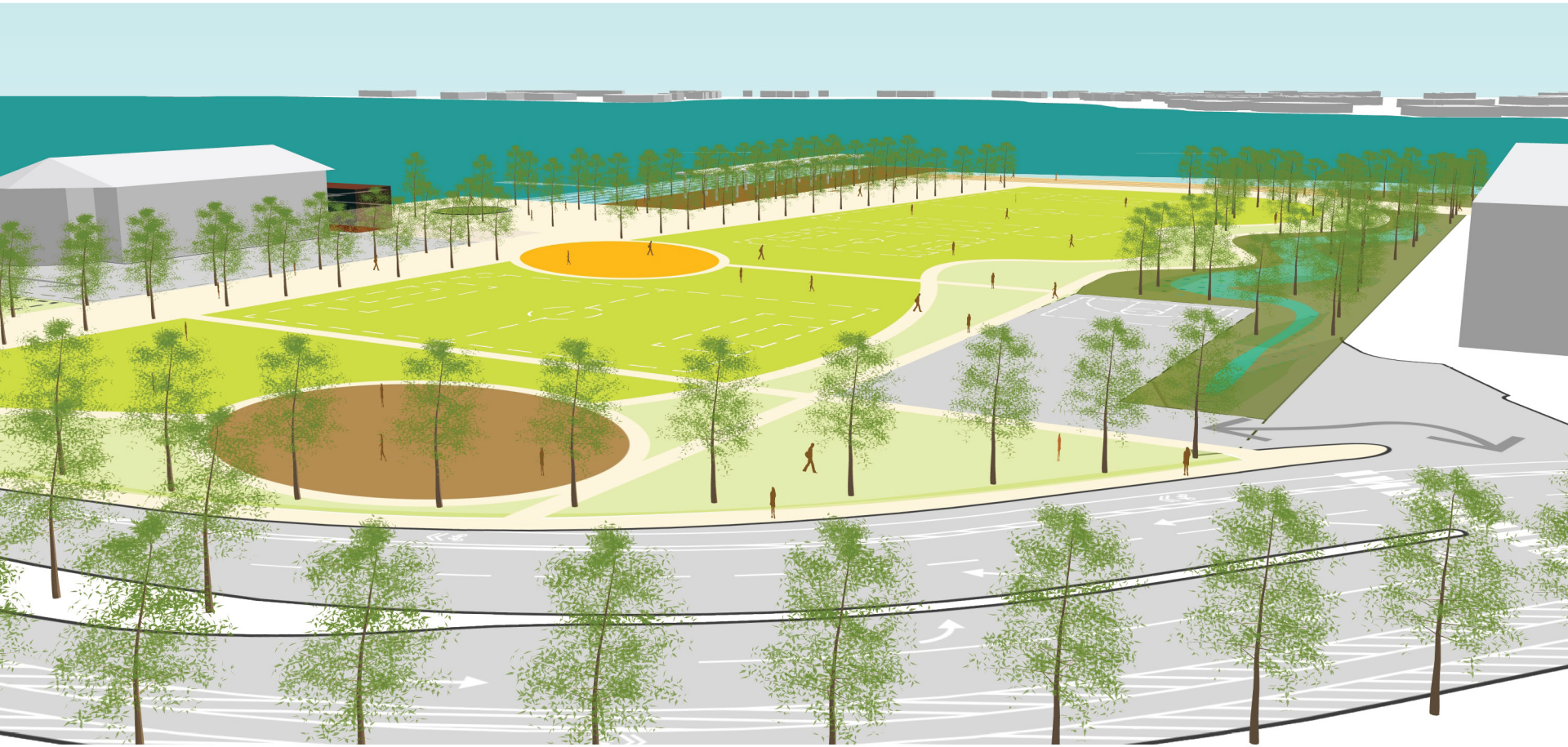

concept 02

LANDSCAPE GREEN

concept 02: LANDSCAPE GREEN

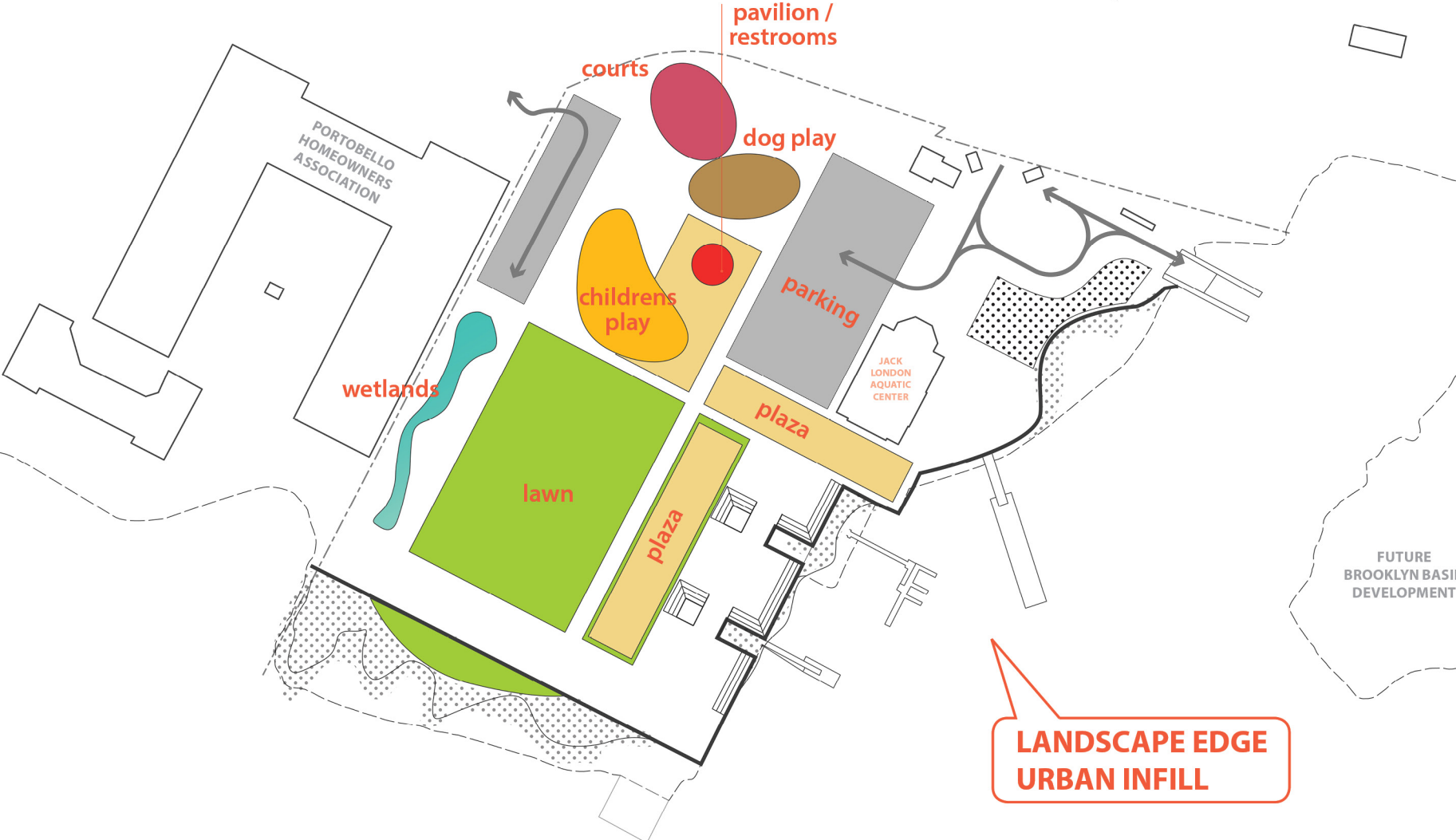

concept 02: **LANDSCAPE GREEN**

LOOK & FEEL



concept 02: LANDSCAPE GREEN

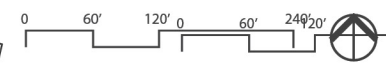

concept 02: **LANDSCAPE GREEN**

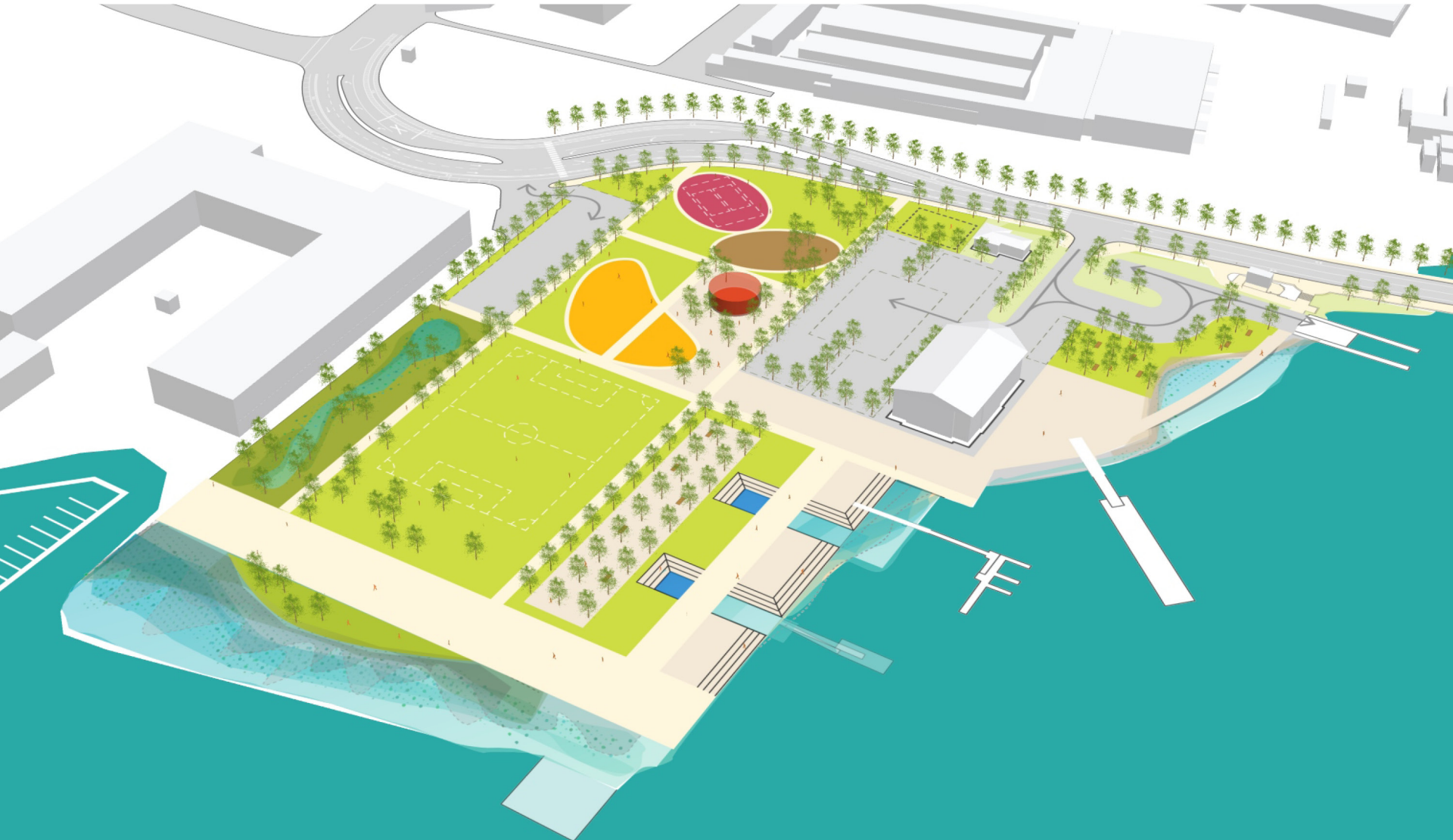

concept 02: **LANDSCAPE GREEN**

PROGRAM & SPACES



concept 02: LANDSCAPE GREEN

EDGES



concept 02: **LANDSCAPE GREEN**

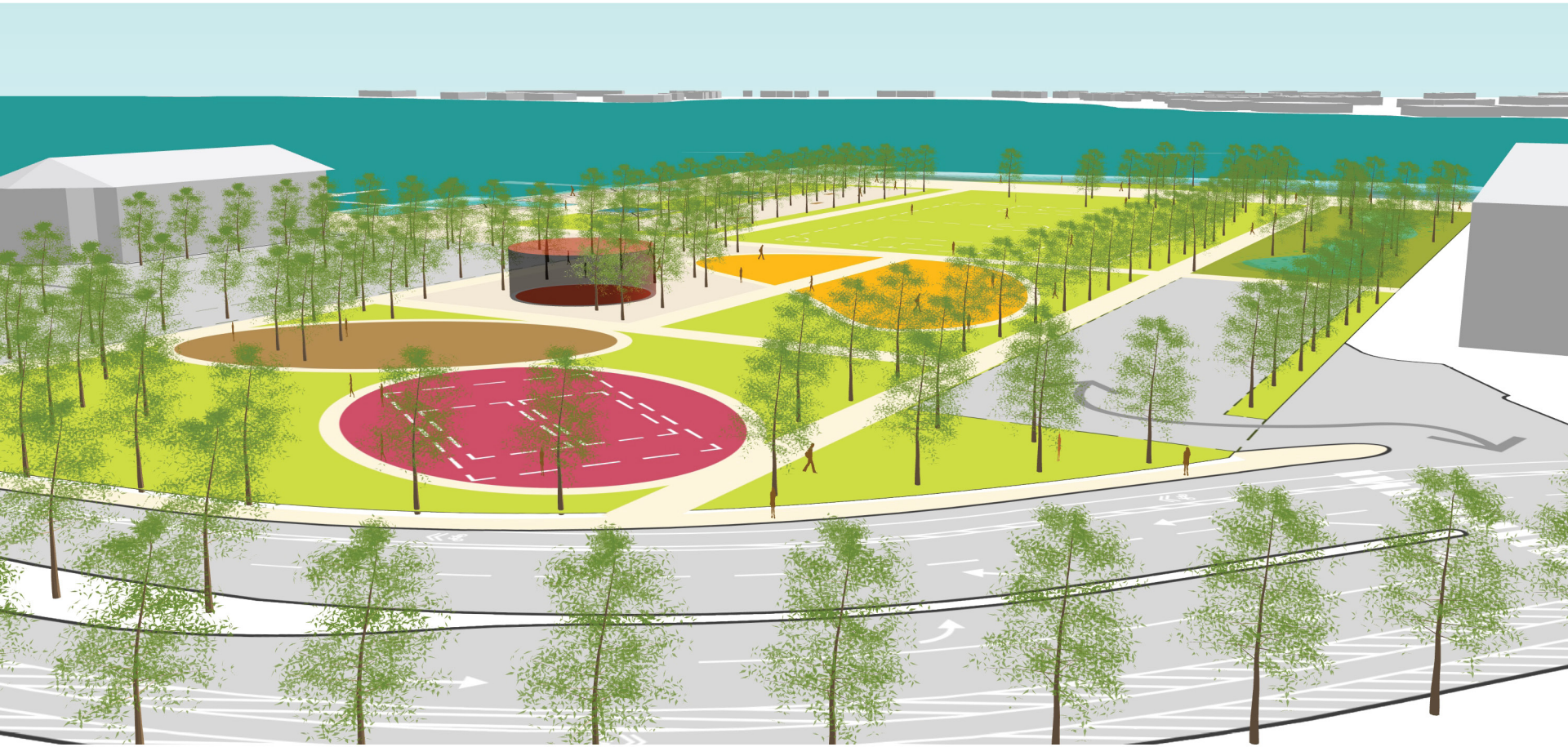

concept 03

TIDAL GREEN

concept 03: TIDAL GREEN

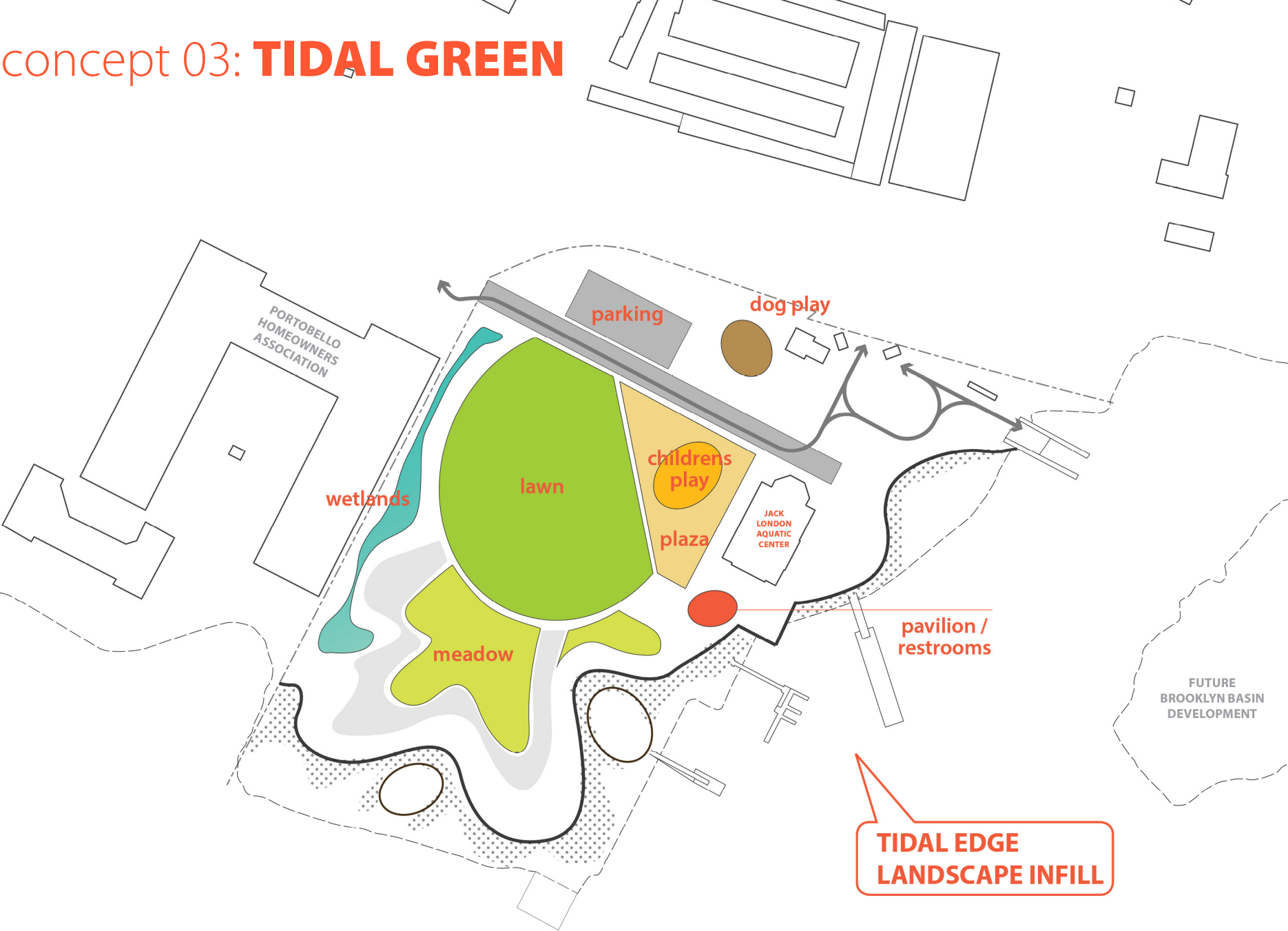

concept 03: TIDAL GREEN

LOOK & FEEL



concept 03: TIDAL GREEN

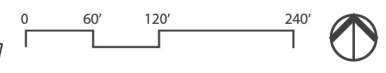

concept 03: **TIDAL GREEN**



concept 03: **TIDAL GREEN**

PROGRAM & SPACES



concept 03: TIDAL GREEN

EDGES



concept 03: **TIDAL GREEN**

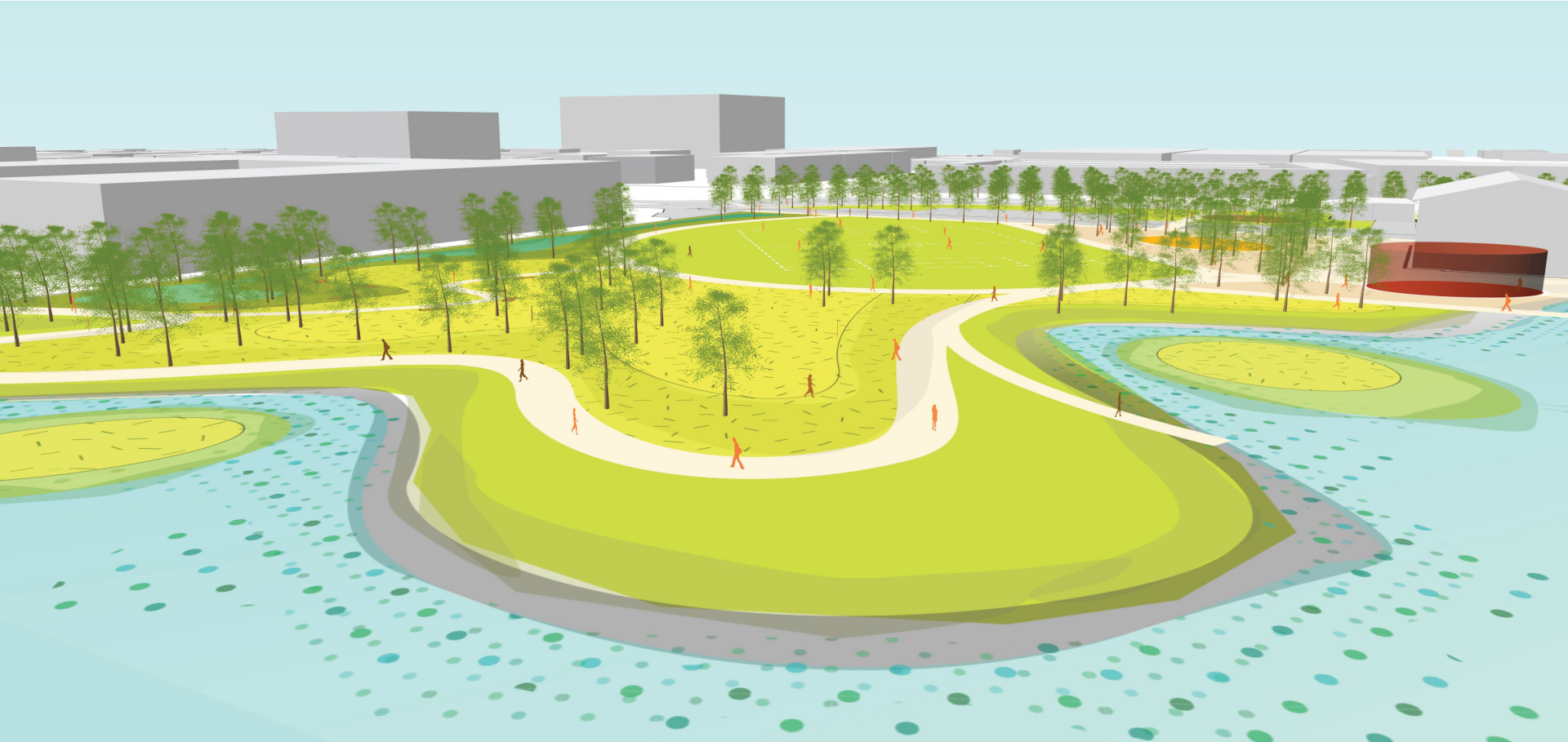

Three Conceptual Designs

concept 01
URBAN GREEN

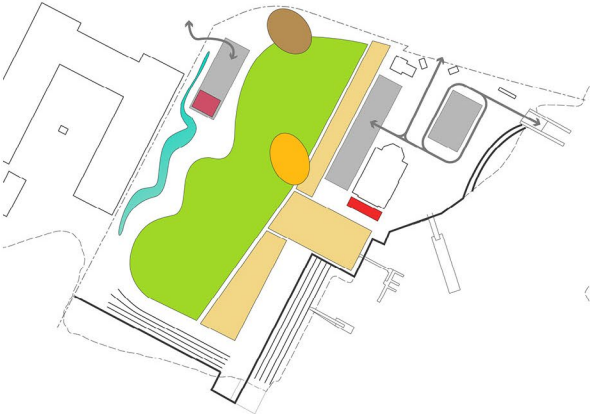

concept 02
LANDSCAPE GREEN

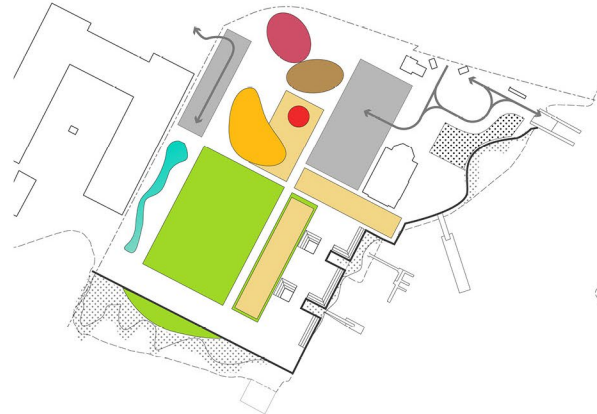

concept 03
TIDAL GREEN



AGENDA

01 understanding site recap

02 what we heard

03 conceptual designs

04 table sessions

Community Collaboration

- Please share what you **MOST LIKE** and **LEAST LIKE** about each design option

concept 01 **URBAN GREEN**

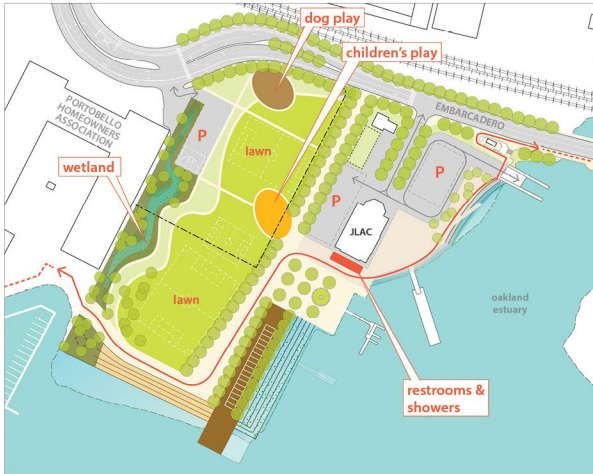



 _____
MOST LIKE

 _____
LEAST LIKE

concept 02 **LANDSCAPE GREEN**



 _____
MOST LIKE

 _____
LEAST LIKE

concept 03 **TIDAL GREEN**



 _____
MOST LIKE

 _____
LEAST LIKE

TABLE SESSIONS
(25 mins)

REPORT BACK
(2 mins each)

NEXT STEPS

Next Steps

- **Encourage others to take the survey about the new park online. Survey will be open until January 2 at 11:59pm**
<https://www.surveymonkey.com/r/BSF7QT7>
- **Community Meeting #3 – Preferred Concept**
January, location TBD
- **For more details about the Estuary Park project and for upcoming events, please go to:**
<https://www.oaklandca.gov/projects/estuary-park>
- Please contact **Ali Schwarz**: aschwarz@oaklandca.gov if you have any questions.

**THANK YOU – LET’S MAKE OAKLAND’S
ESTUARY PARK BIGGER & BETTER**

#OaklandEstuaryPark