

# ESTUARY PARK

## RENOVATION & EXPANSION PROJECT



Community Meeting #3

January 31, 2019

[#OaklandEstuaryPark](#)



HARGREAVES  
ASSOCIATES

# **WHY WE ARE HERE TONIGHT ...**

# WHERE WE ARE

**135 attendees**  
**700 survey responses**

**MEETING #1**  
**October 17**

***CLARIFY  
CHALLENGE***

## **What are we trying to do?**

- introduction
- share analysis
- discuss
- summarize
- post online

**80 attendees**  
**600 survey responses**

**MEETING #2**  
**December 05**

***CREATE  
OPTIONS***

## **What are our options?**

- recap
- share 3 design options
- discuss
- summarize
- post online

**WE ARE  
HERE**

**MEETING #3**  
**January 29, 2019**

***CONSOLIDATE  
PREFERENCE***

## **What is our recommendation?**

- recap
- share preferred design
- discuss
- summarize
- post online

# **UNDERSTANDING THE SITE RECAP**

# Regional Context

**LAKESIDE PARK**  
Completed in 2016

**SNOW PARK**  
Completed in 2017

**BOATHOUSE**  
Completed in 2009

**12TH STREET PARK /  
LAKE MERRITT AMPHITHEATER**  
Completed in 2013

**ESTUARY PARK**



**SPLASH PAD PARK**  
Completed in 2013

**LAKE MERRITT TRAIL**  
Completed in 2010

**LANEY COLLEGE MP**  
Updated in 2015

**GAP CLOSURE PROJECT**  
Anticipated construction begins: 2020

**BROOKLYN BASIN DEVELOPMENT**  
Mixed-Use Development  
Phase 1 under construction  
64 acres total with 30 acres of publicly  
accessible parks, trails and marinas

# Adjacent Context

## BROOKLYN BASIN DEVELOPMENT (Signature Development Group)



**ESTUARY PARK (City of Oakland Open Space)**

OAKLAND ESTUARY



# Historical Use 1857

## SAN ANTONIO CREEK CALIFORNIA

From a Trigonometrical Survey  
under the direction of A.D. BACHE, Superintendent of the  
SURVEY OF THE COAST OF THE UNITED STATES

Triangulation by R.D. CUTTS, Assist. Topography by A.F. RODGERS, Sub-Assist.

Hydrography by the Party

under the command of Comdr. JAMES ALDEN, U.S.N. Assist.

Scale 1:5000

1857

The soundings are expressed in feet to 18 feet, or within the dotted surface; beyond them in fathoms and show the depth at the mean of the low water of each 24 hours the plane of reference. The dotted surface beyond low water mark represent the bottom within the respective depths of 6, 12, and 18 feet. The characteristic sounding only are given on the map; they are selected from the numerous soundings taken in the survey, so as to represent the figure of the bottom.

Latitude of San Antonio Creek 34° 42' 27"  
Longitude of do. west from Greenwich Observatory in arc 122° 13' 22"  
Longitude of do. do. do. in time 8<sup>h</sup> 07' 53<sup>s</sup>.

The triangulation was executed in 1851 A.D.  
The Topography do. in 1854  
The Hydrography do. in 1855

TIDES  
Mean Rise and Fall of Tides 4-5.3

Abbreviations used in the bottom  
S. for Sand sfl. for shells  
stc. for sticks

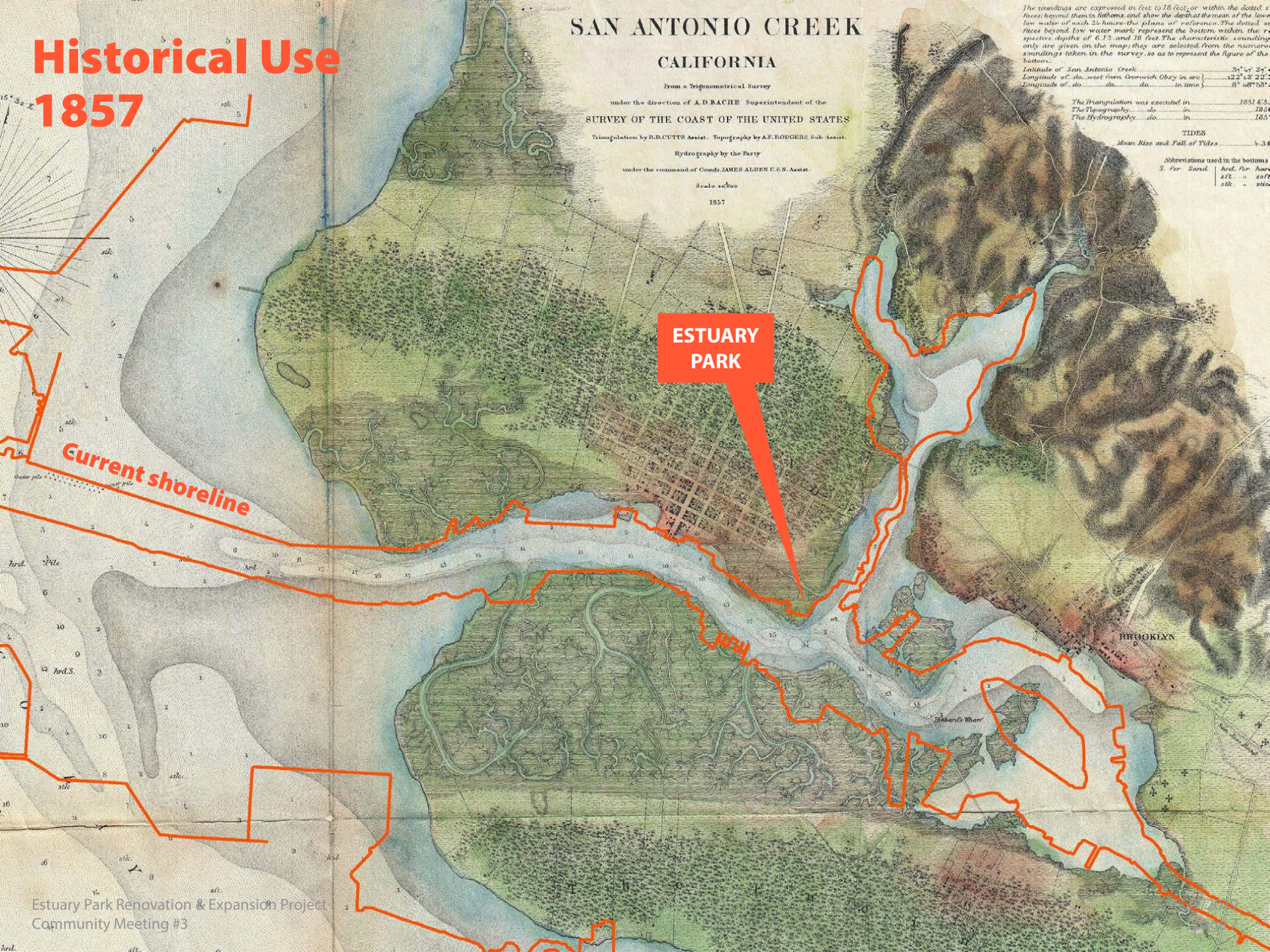

Current shoreline

ESTUARY  
PARK

# Historical Use 1929





# Historical Use 1976 Concept Design

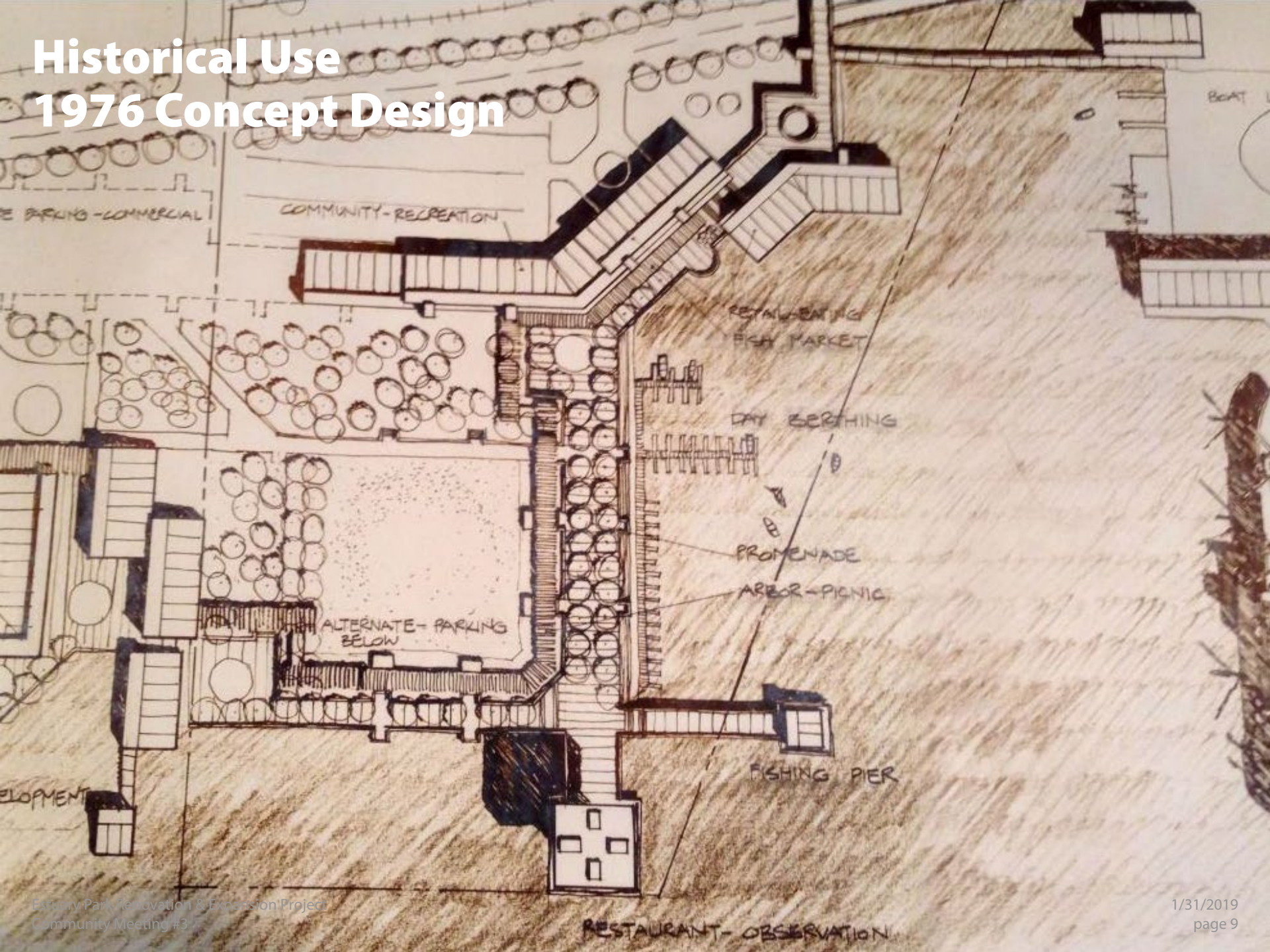



**FUTURE MIXED-USE REDEVELOPMENT**

**EMBARCADERO BRIDGE (UNDER CONSTRUCTION)**

**TO LAKE MERRITT BART STATION (5 MIN WALK)**

**EXTRA SPACE STORAGE**

**AQUA VIA APARTMENTS**

**FUTURE SHIPPING CONTAINER BEER GARDEN**

**FUTURE BROOKLYN BASIN DEVELOPMENT**

**ADDITIONAL LAND (FORMER CASH AND CARRY SITE) (4 acres)**

**PORTOBELLO HOMEOWNERS ASSOCIATION**

**EXISTING ESTUARY PARK (7 acres)**

**KTVU**

**OAKLAND ESTUARY**

**EVE'S WATERFRONT RESTAURANT**

# Site Challenges

## USE RESTRICTIONS - State Trust Lands

The use must accommodate or enhance the Statewide's public enjoyment, not merely a local or municipal benefit.

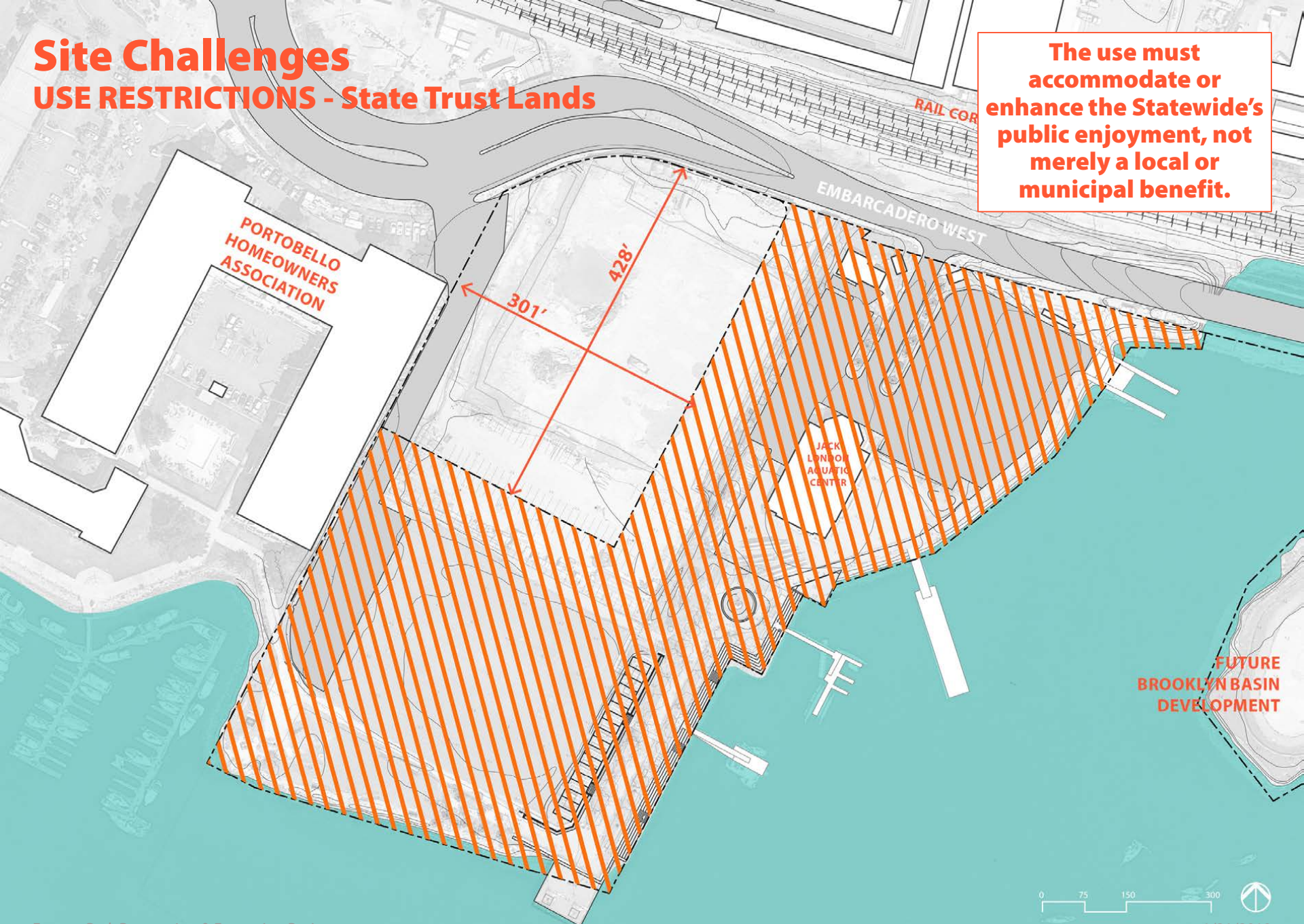

# Site Challenges

## USE RESTRICTIONS - BCDC

Must provide public waterfront access

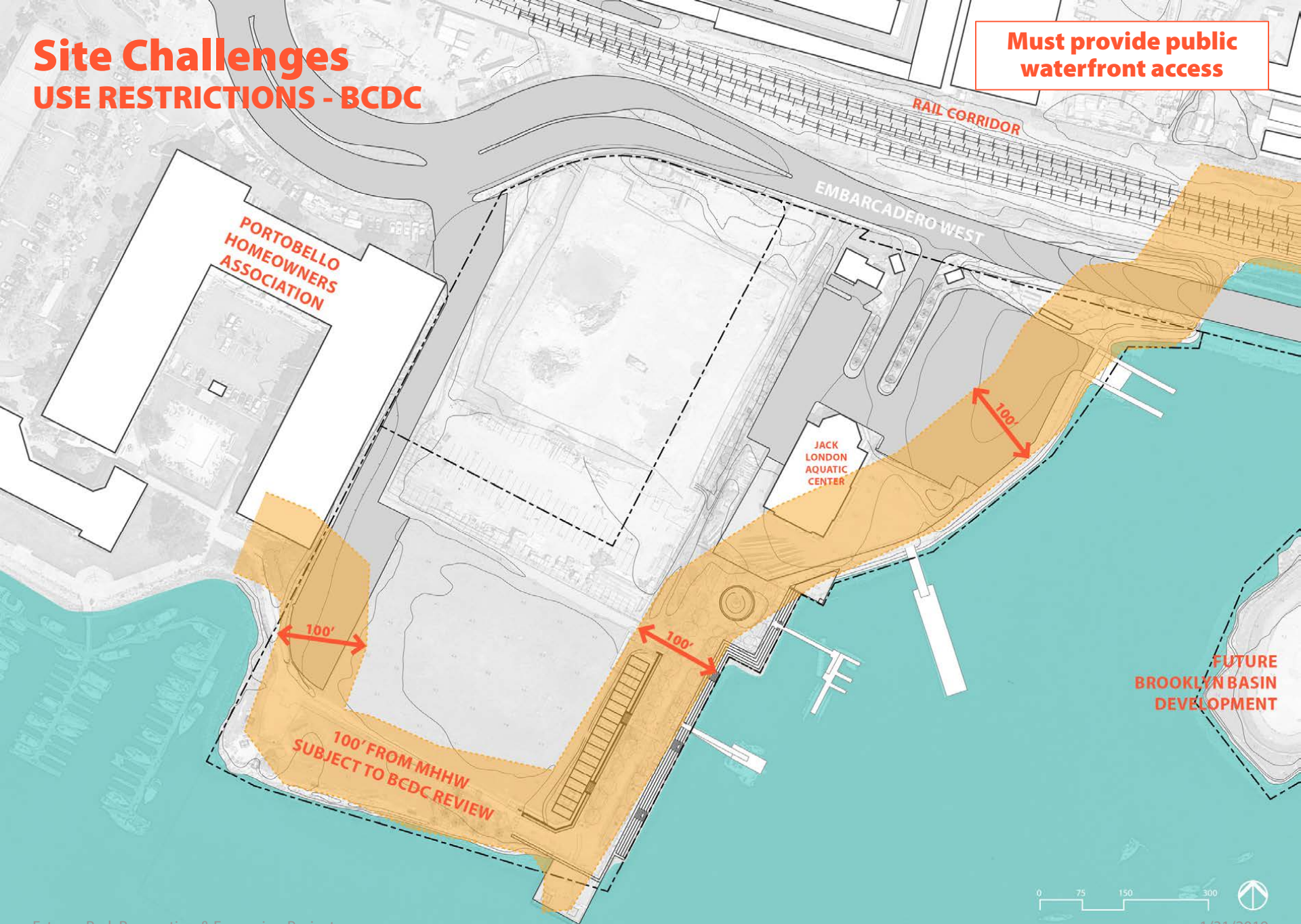

# Site Challenges

## USE RESTRICTIONS - EBMUD

Non-permanent use only

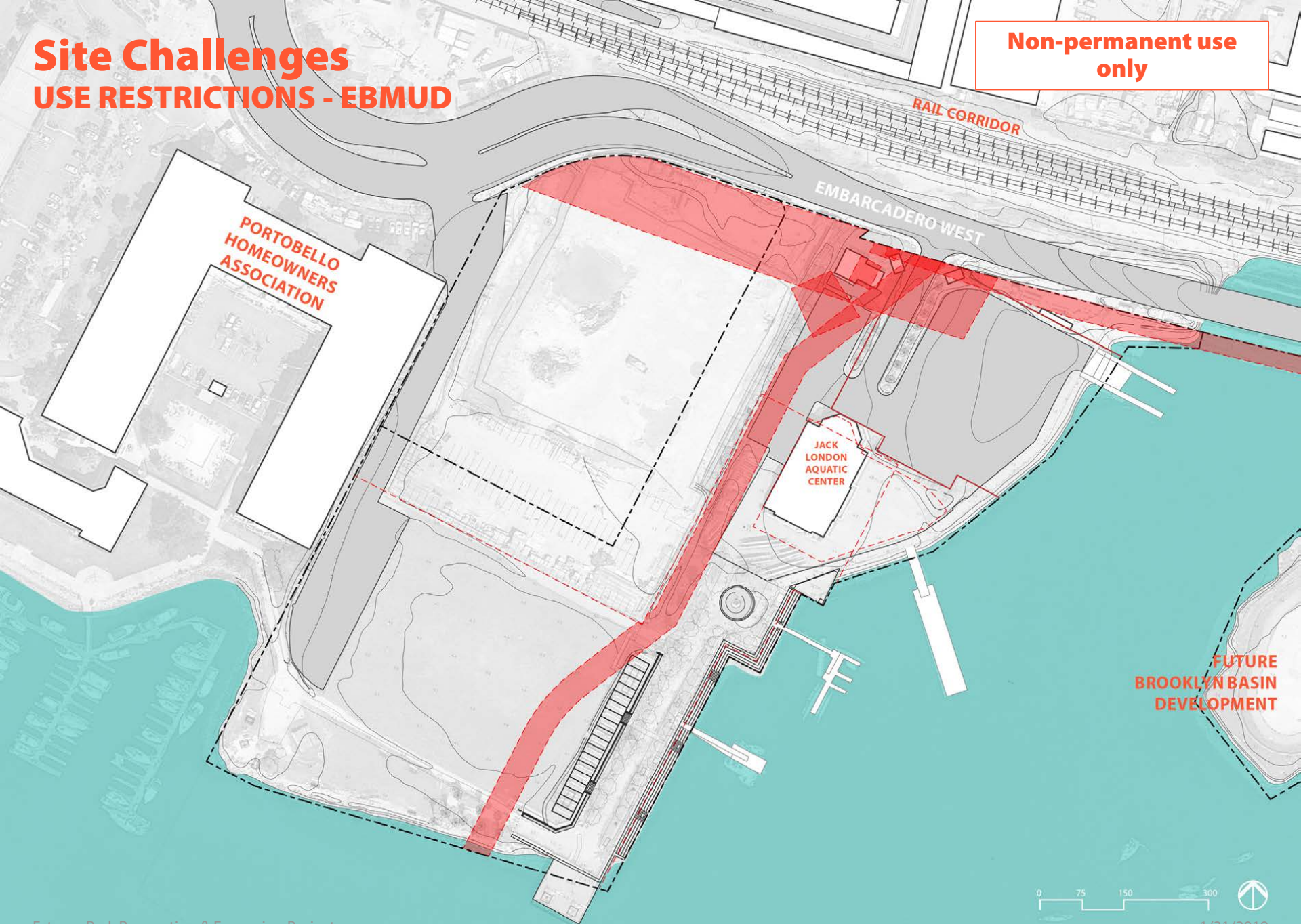

# Site Challenges REMEDIATION

All Remediation will be done by others

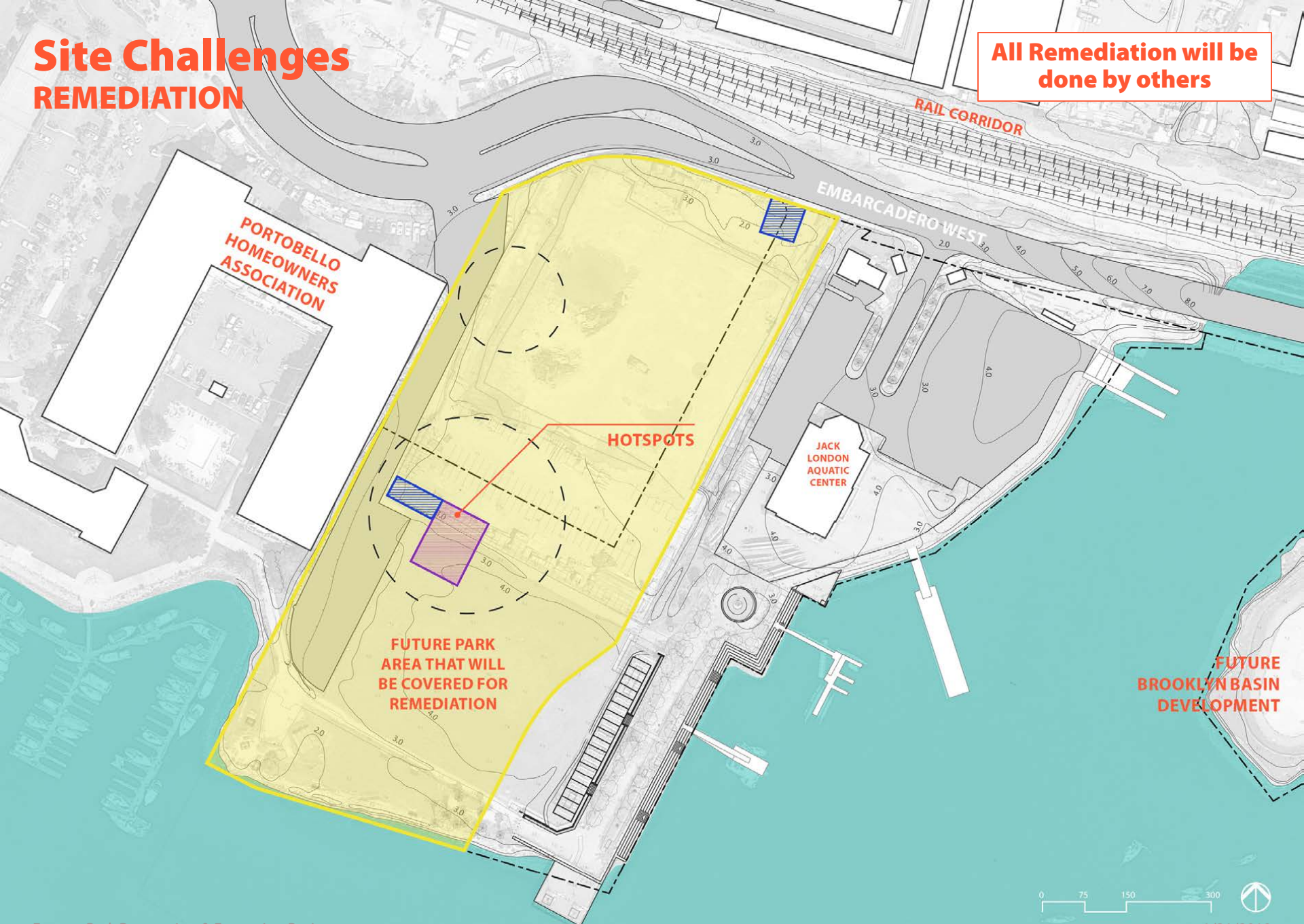

# Site Challenges

## SEA LEVEL RISE

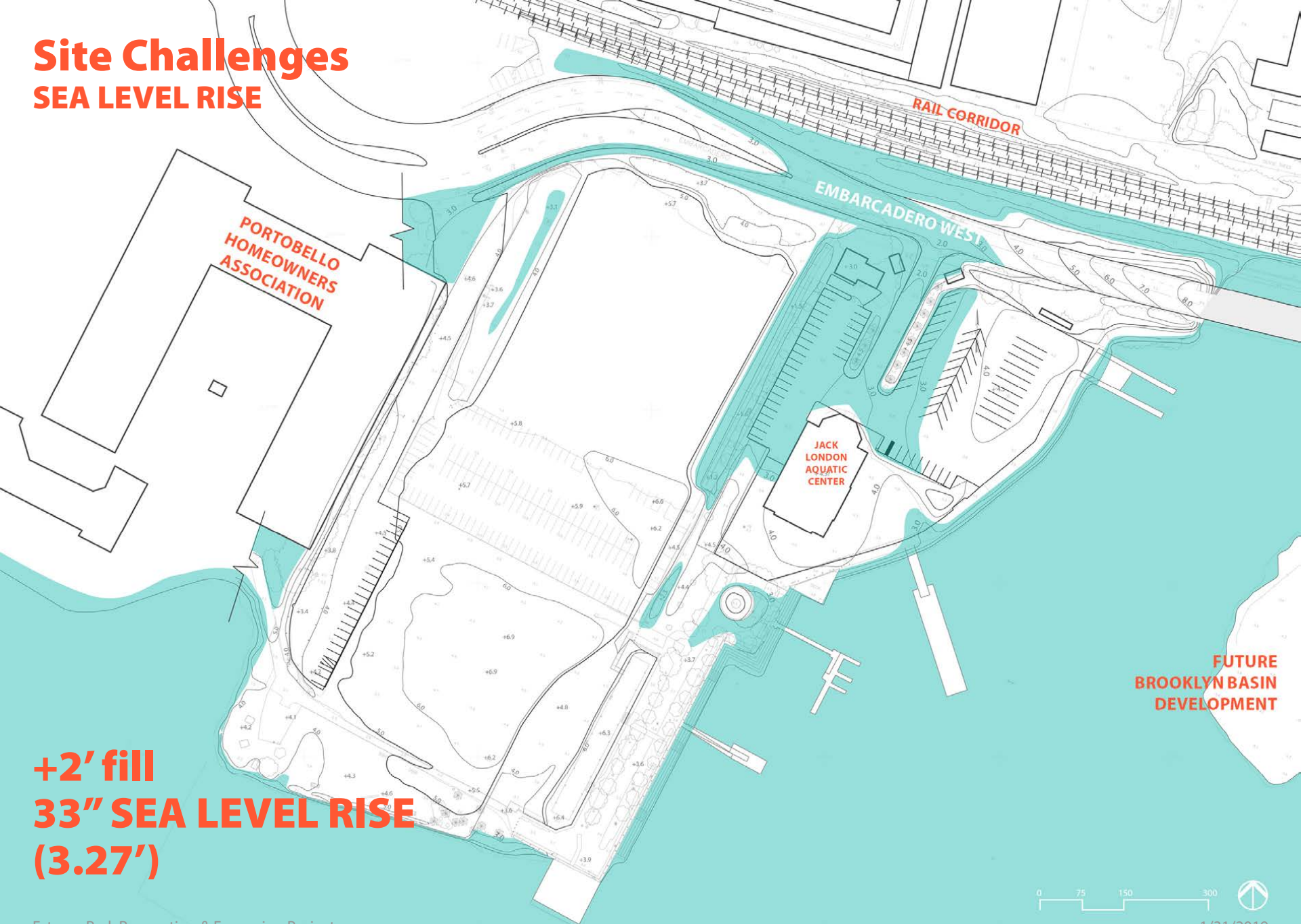

**+2' fill**  
**33" SEA LEVEL RISE**  
**(3.27')**

**FUTURE  
BROOKLYN BASIN  
DEVELOPMENT**

# Site Challenges

## SEA LEVEL RISE

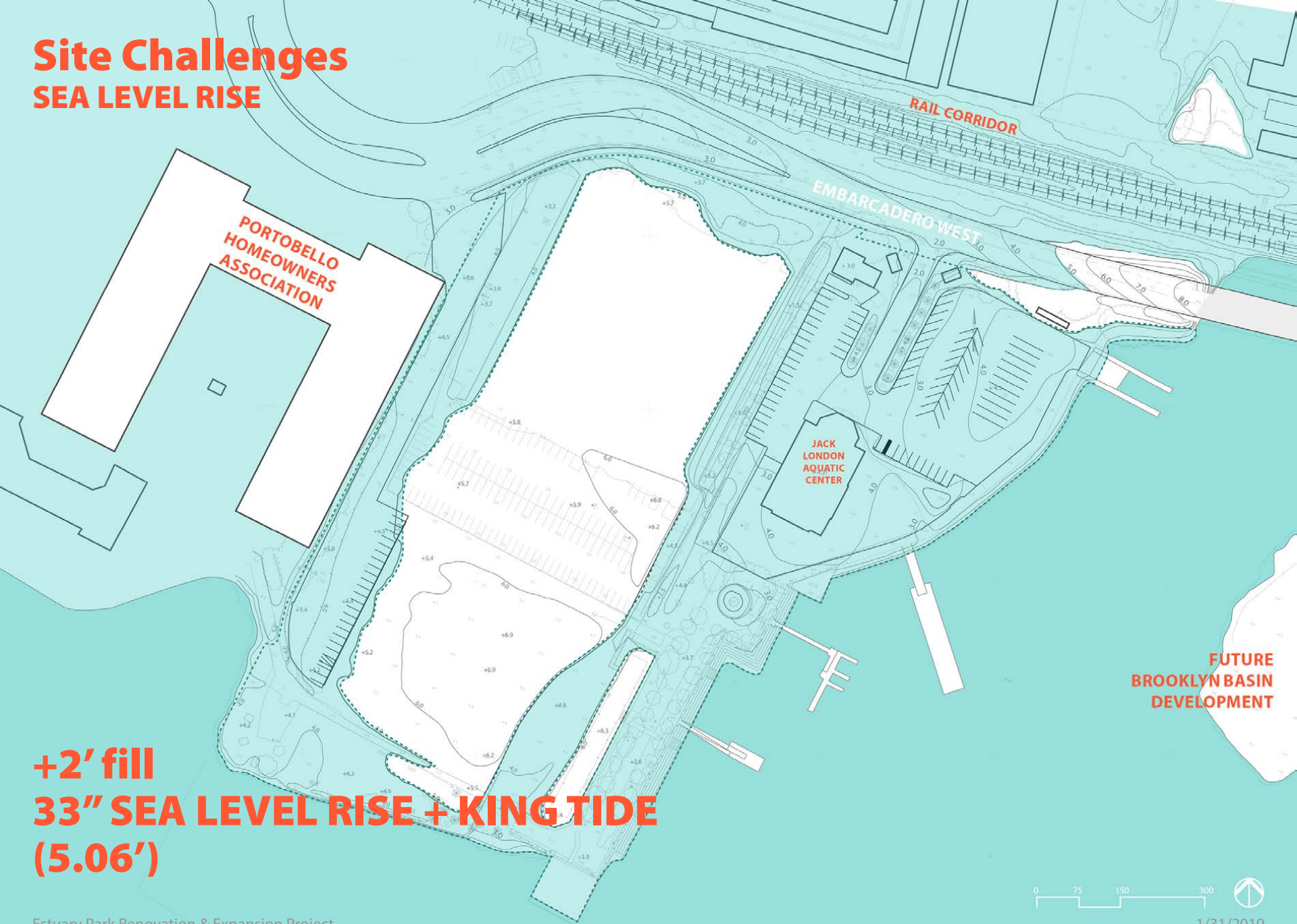

**+2' fill**  
**33" SEA LEVEL RISE + KING TIDE**  
**(5.06')**





# **COMMUNITY OUTREACH RECAP**

# Public Process

## MEETING 1

October 17, 2018

over **135**  
PARTICIPANTS



## MEETING 2

December 5, 2018

over **80**  
PARTICIPANTS



# Community Meeting # 1

over 710  
RESPONSES

DD
Measure

## ESTUARY PARK COMMUNITY MEETING #1

### ACTIVITIES & AMENITIES SURVEY

**QUESTION 01: What would you like to see and do in the park?**  
Choose 3 *preferred activities* within each category. The park cannot fit everything on the list, but your responses will help identify broad community preferences.

HEALTH & WELLNESS	SPORTS / GAMES / PLAY	SOCIAL / GATHERING / CULTURE
<ul style="list-style-type: none"> <li><input type="radio"/> Walking</li> <li><input type="radio"/> Running / Jogging</li> <li><input type="radio"/> Stair climbing</li> <li><input type="radio"/> Cycling</li> <li><input type="radio"/> Roller skating / blading</li> <li><input type="radio"/> Exercise circuit</li> <li><input type="radio"/> Work out classes</li> <li><input type="radio"/> Sitting</li> <li><input type="radio"/> Relaxing / Finding peace</li> <li><input type="radio"/> Enjoying nature / Beauty</li> <li><input type="radio"/> Tai Chi / Yoga</li> <li><input type="radio"/> other _____</li> <li><input type="radio"/> other _____</li> </ul>	<ul style="list-style-type: none"> <li><input type="radio"/> Casual Pick-up games (frisbee, catch, kite flying, soccer)</li> <li><input type="radio"/> Court games</li> <li><input type="radio"/> Children's play</li> <li><input type="radio"/> Water play</li> <li><input type="radio"/> Dog play</li> <li><input type="radio"/> Chess / Checkers</li> <li><input type="radio"/> Bocce / Horseshoes</li> <li><input type="radio"/> Skateboarding</li> <li><input type="radio"/> Rock climbing</li> <li><input type="radio"/> Fitness course</li> <li><input type="radio"/> other _____</li> <li><input type="radio"/> other _____</li> </ul>	<ul style="list-style-type: none"> <li><input type="radio"/> Picnics / Grilling</li> <li><input type="radio"/> Food trucks</li> <li><input type="radio"/> Food carts</li> <li><input type="radio"/> Food Kiosk / Cafe</li> <li><input type="radio"/> Local farmers market</li> <li><input type="radio"/> Outdoor family gatherings / birthdays</li> <li><input type="radio"/> Outdoor weddings</li> <li><input type="radio"/> Outdoor performances / events</li> <li><input type="radio"/> Outdoor movies</li> <li><input type="radio"/> Art festival</li> <li><input type="radio"/> Senior's classes</li> <li><input type="radio"/> other _____</li> <li><input type="radio"/> other _____</li> </ul>
WATERFRONT ACTIVITIES	ART / EDUCATION	SUPPORT & MOBILITY
<ul style="list-style-type: none"> <li><input type="radio"/> Human-powered boating</li> <li><input type="radio"/> Power boating</li> <li><input type="radio"/> Fishing</li> <li><input type="radio"/> Bird-watching</li> <li><input type="radio"/> Viewing area / deck / overlook</li> <li><input type="radio"/> Kayaking and paddle board rental</li> <li><input type="radio"/> Rowing</li> <li><input type="radio"/> Dragon boating</li> <li><input type="radio"/> Fish cleaning</li> <li><input type="radio"/> other _____</li> <li><input type="radio"/> other _____</li> </ul>	<ul style="list-style-type: none"> <li><input type="radio"/> Permanent public art/sculpture</li> <li><input type="radio"/> Temporary art installations / Art walks</li> <li><input type="radio"/> Outdoor art classes</li> <li><input type="radio"/> Outdoor environmental education</li> <li><input type="radio"/> Water conserving gardens</li> <li><input type="radio"/> Bioswales</li> <li><input type="radio"/> Youth/school programs</li> <li><input type="radio"/> Historic interpretations</li> <li><input type="radio"/> Information kiosks</li> <li><input type="radio"/> other _____</li> <li><input type="radio"/> other _____</li> </ul>	<ul style="list-style-type: none"> <li><input type="radio"/> Vehicle parking</li> <li><input type="radio"/> Boat trailer parking</li> <li><input type="radio"/> Bicycle parking</li> <li><input type="radio"/> Vehicle drop-off / pick-up</li> <li><input type="radio"/> Restrooms</li> <li><input type="radio"/> Showers</li> <li><input type="radio"/> Park information</li> <li><input type="radio"/> Bike rentals</li> <li><input type="radio"/> Staff/Security</li> <li><input type="radio"/> other _____</li> <li><input type="radio"/> other _____</li> </ul>

**QUESTION 02:** What word or phrase best describes what you think Estuary Park should be? \_\_\_\_\_

**QUESTION 03:** What is your favorite Oakland Park, and why? \_\_\_\_\_

**QUESTION 04:** What is your favorite park anywhere, and why? \_\_\_\_\_

Zip-code where you live: \_\_\_\_\_ Your age (choose one):  Under 18  18-25  26-35  36-45  46-55  56 - 65  65+

**OTHER COMMENTS:** \_\_\_\_\_

\_\_\_\_\_

\_\_\_\_\_

**TO BE ON OUR MAILING LIST AND KEEP UP-TO DATE ON THIS PROJECT, PLEASE SIGN UP BELOW:**

Name: \_\_\_\_\_

E-mail: \_\_\_\_\_

Please visit [www.oaklandca.gov/projects/estuary-park](http://www.oaklandca.gov/projects/estuary-park) to learn more about the project and fill out the online survey!

**SURVEY WILL CLOSE ON NOV. 7 at 11:59pm**

THANK YOU - LET'S MAKE OAKLAND'S ESTUARY PARK BIGGER AND BETTER!

# Community Meeting #1 Top Priorities

QUESTION 01: What would you like to see and do in the park?

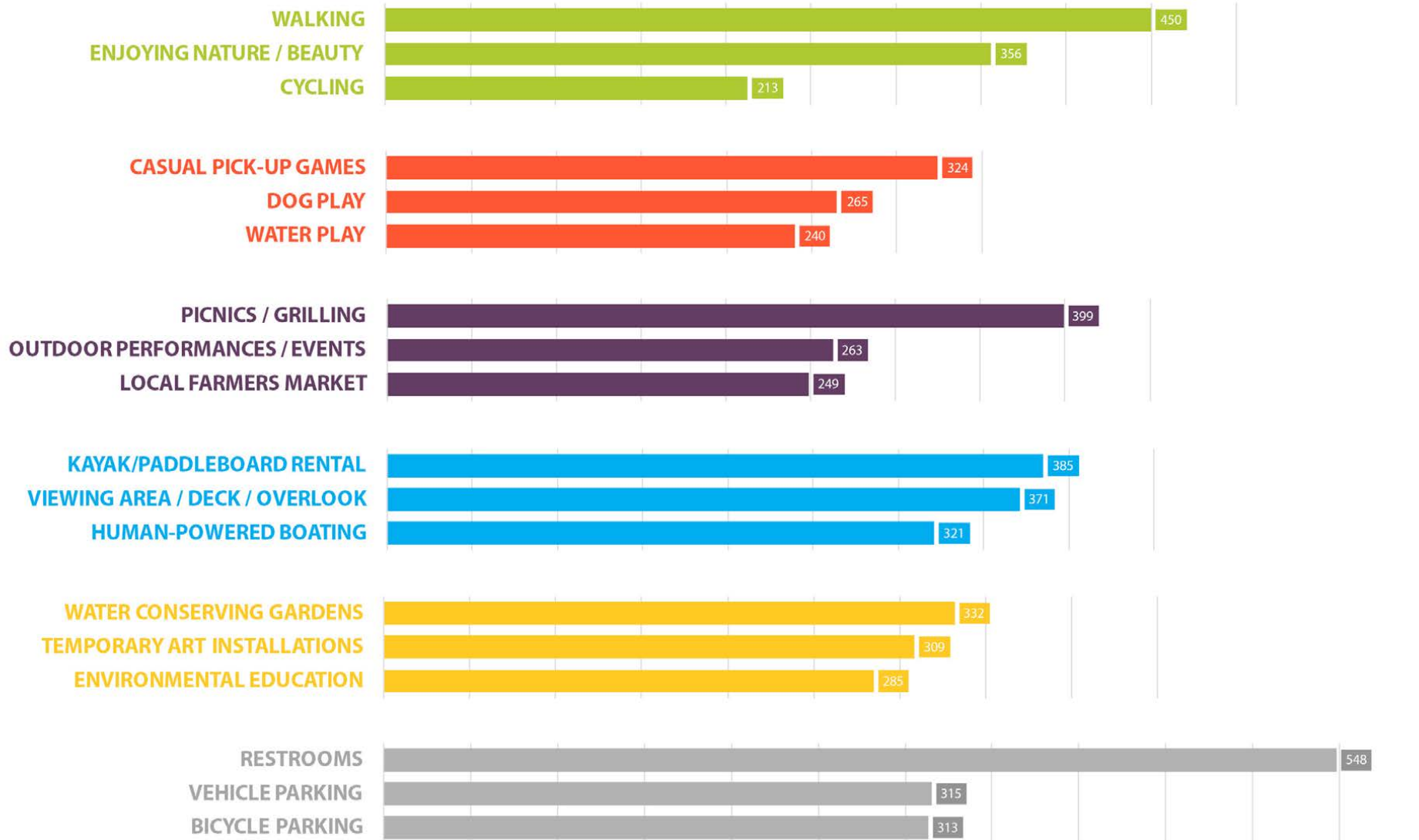

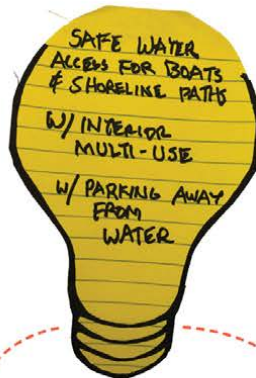
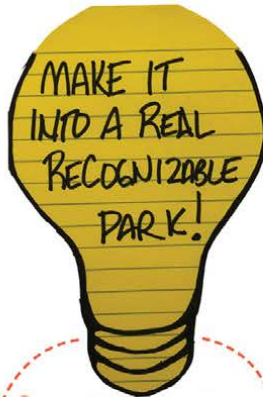
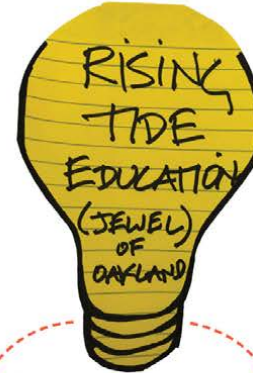

# Community Meeting # 2

## Recap

concept 01 **URBAN GREEN**

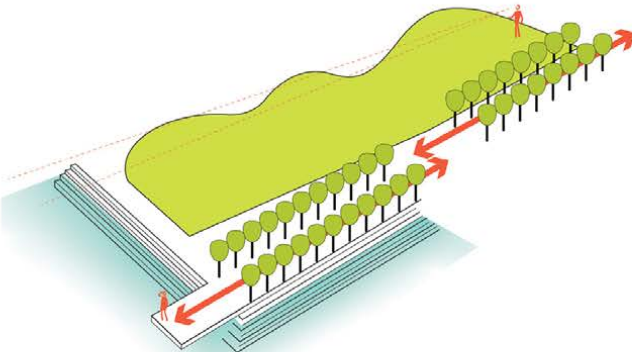

**historical reference**  
**long open space**  
**hard water edge**

concept 02 **LANDSCAPE GREEN**

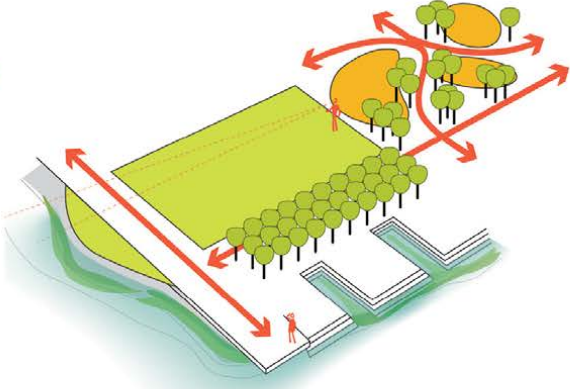

**sequential**  
**outdoor rooms**  
**landscape water edge**

concept 03 **TIDAL GREEN**



**meandering**  
**blended**  
**soft, tidal edge**

# Community Meeting # 2 Recap

over 600  
RESPONSES

DD

## ESTUARY PARK COMMUNITY MEETING #2 DESIGN OPTIONS SURVEY

Zip-code where you live: \_\_\_\_\_  
Your age (choose one):  Under 18  18-25  26-35  36-45  46-55  56 - 65  65+



TO BE ON OUR MAILING LIST AND KEEP UP-TO DATE ON THIS PROJECT, PLEASE SIGN UP BELOW:

Name: \_\_\_\_\_  
E-mail: \_\_\_\_\_

The following three design concepts for Estuary Park set out an overall landscape framework for the park. While each of these concepts contain roughly the same types and quantities of program elements, they differ in the way that they are organized, creating three unique and different experiences for the user.

Each concept will, as a baseline, provide the following: adequate space and access to the docks for existing boat crews, adequate storage space needed for boating equipment on site, no net loss of parking and a bay trail connection through the park for pedestrians and cyclists.

We want to learn what you like and dislike about the features of the three different approaches to improving the park. This is not a vote for any one concept, but instead will be used to help us understand the strengths of each approach, which will then be synthesized into a single preferred design concept. Please fill out the following survey and share your ideas!

Please list below what you **MOST LIKE** and **LEAST LIKE** of each concept design option

### concept 01 URBAN GREEN

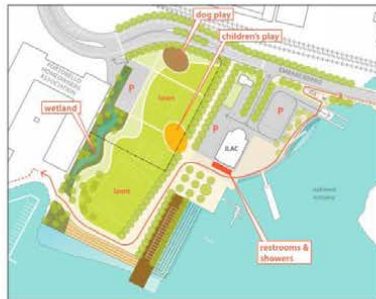

The first concept, Urban Green, is organized around a large lawn that extends from the Embarcadero to the waterfront, creating an open vista from the north to the south.

**Program and Organization:** The formality of Lawrence Halprin's 1970's plan is preserved and enhanced through design elements such as the linear tree lined promenade and the existing trellis pier. The large lawn, delineated by the wetland on the west, could be used for both passive and active recreation as well as hosting large and small scale events. Extending out from the lawn there are pockets of smaller program areas including dog play and a children's playground. New restroom and shower facilities are located on the southern end of the existing Jack London Aquatic Center. All existing sculptures remain in this concept.

**Water's Edge:** The waterfront is defined by a hard edge that includes a large seating wharf to the south and a promenade and pier to the east. A small kayak launch, where users are able to get into the water, is located on the north east part of the shoreline, next to the boat ramp.

\_\_\_\_\_  
**MOST LIKE**

\_\_\_\_\_  
**LEAST LIKE**

### concept 02 LANDSCAPE GREEN



Landscape Green is the most active of formal and informal pathway, sequential series of outdoor rooms.

**Program and Organization:** From the Embarcadero, programmed rooms, or pods, lead you into the site. The pods host several different programmatic activities, including a large playground, a multi-use court, and a dog play area. A new pavilion, restrooms and showers are centrally located in the plaza and draw people into the park. To the south, an open lawn connects the wetlands on the west and picnic grove on the east. The open lawn can be used for both passive and active recreation and can also be used for small and large scale events.

**Water's Edge:** The edge condition is combination of both hard and soft features. Along the southern edge, a grass lookout extends above a tidal slope, gently allowing water to enter the park. The eastern edge emphasizes the concrete terraces and cuts tidal canals into the park. Around the boat ramp, a small beach is cut into the shoreline where people are able to access the water.

\_\_\_\_\_  
**MOST LIKE**

\_\_\_\_\_  
**LEAST LIKE**

### concept 03 TIDAL GREEN



Tidal Green, is the most nature-based of the three concepts. It organizes the park elements around a series of meandering pathways.

**Program and Organization:** Anchored by parking on the north, the large oval lawn extends through the middle of the park. Sized for outdoor activities including pick-up sports, the lawn is also a place for the community to gather during small and large scale events. An informal playground and a plaza which includes a new park pavilion with restrooms and showers is located nearby. A small dog play area is next to the Embarcadero. The meandering pathways stretch from the wetlands, through the meadow, ending at the plaza. The meadow and shoreline provide a much-needed natural respite from the City, which can be used for passive relaxation all year around.

**Water's Edge:** The water's edge is about retreat – cutting into the existing land to allow water to come in. The soft edge wraps the entire park from the south to the east creating a meandering shoreline that can allow new vegetation. Small habitat islands also emerge with lush vegetation and ecosystems for wildlife. A kayak launch is centrally located, and the new shoreline creates a perfect place for adventure and exploration.

\_\_\_\_\_  
**MOST LIKE**

\_\_\_\_\_  
**LEAST LIKE**

Please visit [www.oaklandca.gov/projects/estuary-park](http://www.oaklandca.gov/projects/estuary-park) to learn more about the project and fill out the online survey!  
**SURVEY WILL CLOSE ON JAN 2 at 11:59pm** [#OaklandEstuaryPark](https://twitter.com/OaklandEstuaryPark)

# Community Meeting # 2

## Recap

concept 01  
**URBAN GREEN**

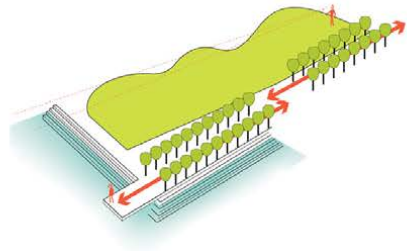

- + LARGE, GREEN AREA
- + OPEN SPACE
- + REFERENCE TO HISTORICAL ELEMENTS
- + SIMPLE
- + FLEXIBLE / MULTI-PURPOSE
- + SEATING AT WATER'S EDGE



- TOO MUCH HARD SPACE
- LAWN IS TOO BIG TO MAINTAIN
- TOO FORMAL
- TOO SQUARE
- NOT ENOUGH TREES
- NOT NATURAL



# Community Meeting # 2

## Recap

concept 02

### LANDSCAPE GREEN

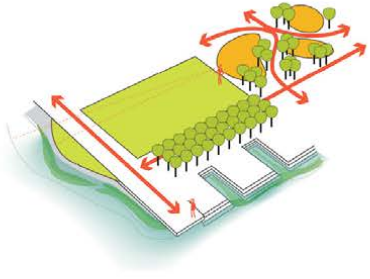

**MOST  
LIKE**

- + MIX OF HARD AND SOFT EDGES
- + BEACH SPACE
- + MULTI-USE / SOMETHING FOR EVERYONE
- + VERY ACTIVE



**LEAST  
LIKE**

- OVER PROGRAMMED / TOO MUCH ACTIVITY
- TOO DIVIDED
- RESTROOM LOCATION TOO FAR FROM JLAC
- TOO MUCH HARD EDGE / TOO RIGID
- TIDAL CUTS ARE HARD TO MAINTAIN
- LESS SEATING AT WATER'S EDGE
- VISIBILITY / SAFETY

# Community Meeting # 2

## Recap

concept 03

### TIDAL GREEN



**MOST  
LIKE**

- + HABITAT BASED
- + NATURAL SHORELINE
- + ORGANIC FORM
- + PARKING LOCATION AT EMBARCADERO
- + DOG PARK SEPARATION
- + THE MEADOW
- + INTEGRATION OF SPACES



**LEAST  
LIKE**

- LOSS OF PARK SPACE
- PROGRAMMING AREAS TOO SMALL
- MAINTENANCE & HOMELESS CONCERNS
- LACK OF SEATING AT EDGE
- DOG AREA SIZE AND LOCATION

# Community Meeting # 2 Recap

concept 01  
**URBAN GREEN**

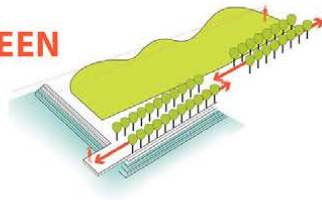

concept 02  
**LANDSCAPE GREEN**

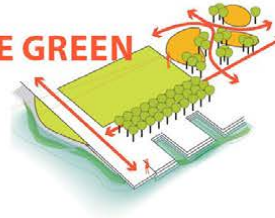

concept 3  
**TIDAL GREEN**



- + Large, green area
- + Open visibility
- + Reference to historical elements
- + Simple
- + Flexible / multi-purpose
- + Seating at water's edge

- + Mix of hard and soft edges
- + Beach space
- + Multi-use / something for everyone
- + Very active

- + Habitat based
- + Natural shoreline
- + Organic form
- + Parking location at embarcadero
- + Dog park separation
- + The meadow
- + Integration of spaces



- Too much hard space
- Too much pavement
- Lawn is too big to maintain
- Too formal
- Not enough trees
- Not natural
- Too square

- Over programmed / too much activity
- Too many single use spaces
- Restroom location too far from JLAC
- Too much hard edge / too rigid
- Tidal cuts are hard to maintain
- Less seating at water's edge
- Visibility / safety

- Loss of park space
- Programming areas too small
- Maintenance & homeless concerns
- Lack of seating at edge
- Dog area size and location

**= HYBRID SOLUTION**

# Other outreach efforts



# Other outreach efforts



- TOP 3:**
- 1. Playground**
  - 2. Court Games**
  - 3. Rock Climbing**

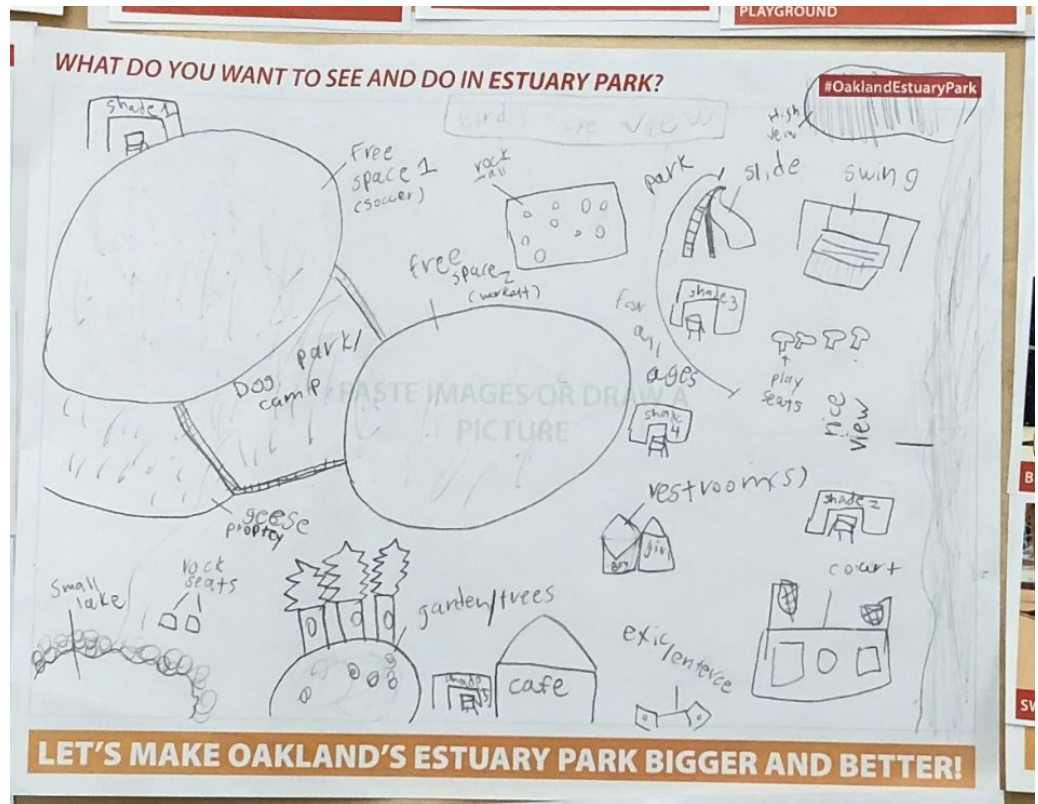

# Total outreach efforts

## To get the word out:

- E-mailed and mailed over 1500 invitations
- Attended standing Neighborhood Council Meetings
- Attended over 15 events across Oakland including community meetings, markets and festivals
- Attended schools to get youth participation
- Advertised on social media

## Outcome:

- Meetings: over **200 attendees**
- Surveys: over **1300 responses**

# **ESTUARY PARK CONCEPT**

# Community Word Cloud





# Mission & Goals

The Project's mission is to make the Park bigger and better to create a **great waterfront park** – a place to celebrate and enjoy Oakland's Estuary at, on and in the water.

---

*The Park aims to become a place that is more;*

- **Lively year-round** – programmed for community needs at the water
- **Connected** - improved vehicle, water-craft, pedestrian and bicycle access and parking
- **Safe, healthy and comfortable** – through active use, lighting, and conveniences
- **Meaningful** – a sense of place, a sense of community, history & art interpretation
- **Enterprising** – complementary visitor services and partnership opportunities
- **Sustaining** – Bay-Friendly greener infrastructure and habitat restoration
- **Resilient** – adapted to both drought and Sea Level Rise
- **Valuable** – returns a net public benefit for the cost
- **Manageable** – able to be cared for
- **Deliverable** – able to be implemented in phases

# Climate and Views

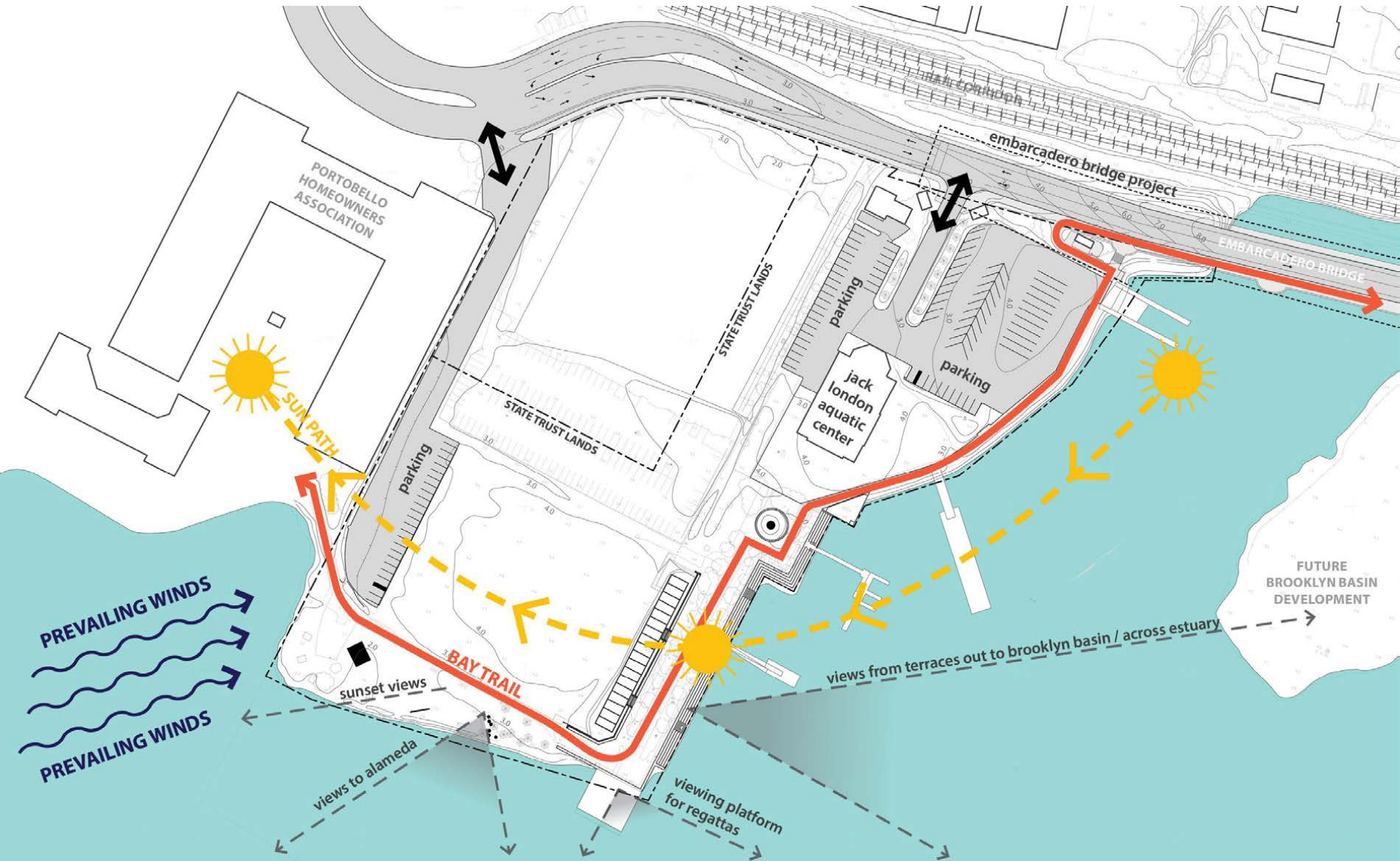

# The Estuary



The site is neither sea nor river – it is by the **Oakland Estuary**. The Park should reflect the essential nature of an estuary as a rich productive landscape driven by the **gradation** and **balance** of expansive fresh & salt water, sediment layers, tidal fluctuations, and abundant life.

# The Estuary

Gradient between a **neighborhood park**, a **community park**, and a **regional park**

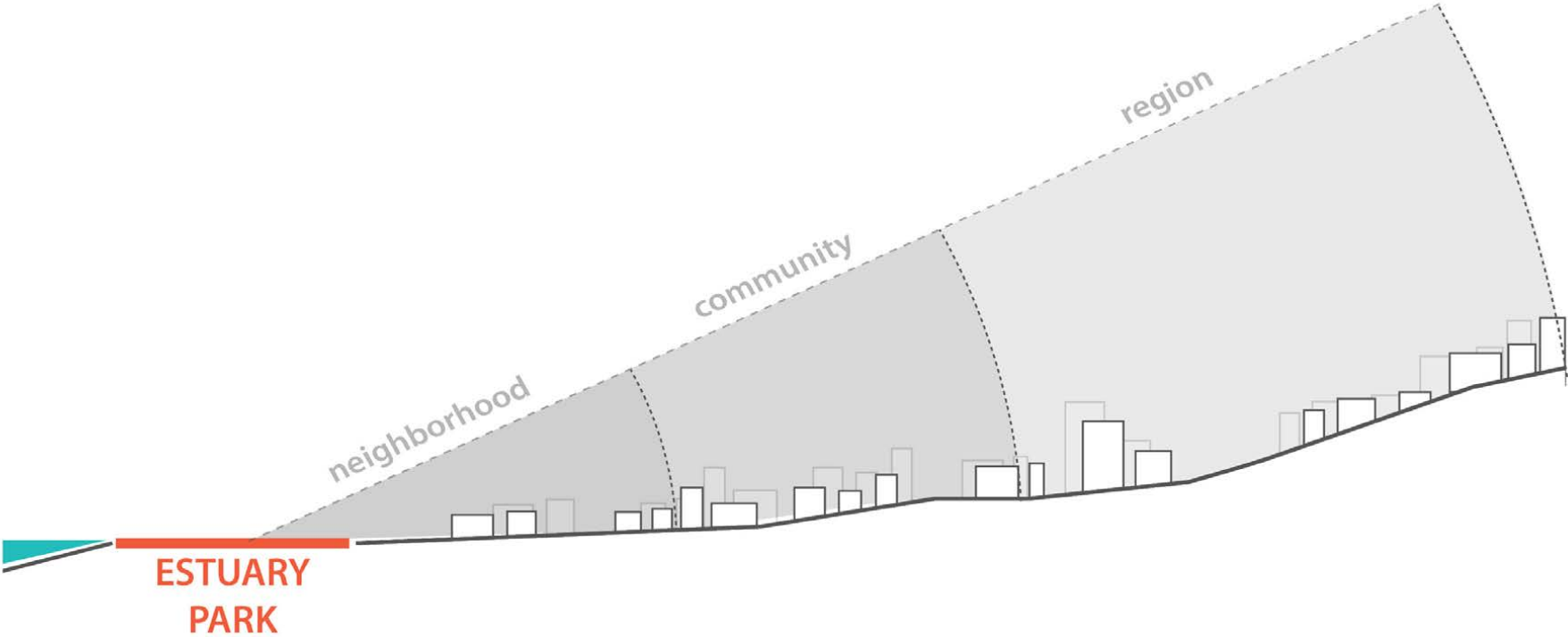

# The Estuary

Gradient between **fresh** and **salt** water

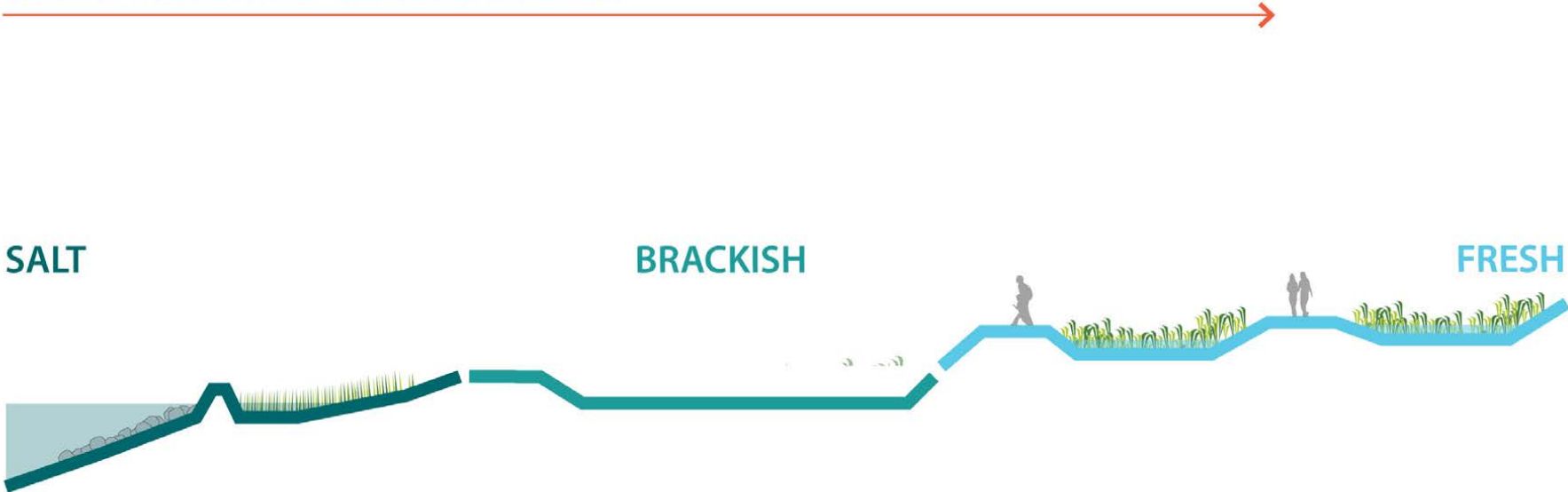

# The Estuary

*Gradation of prospect and refuge*

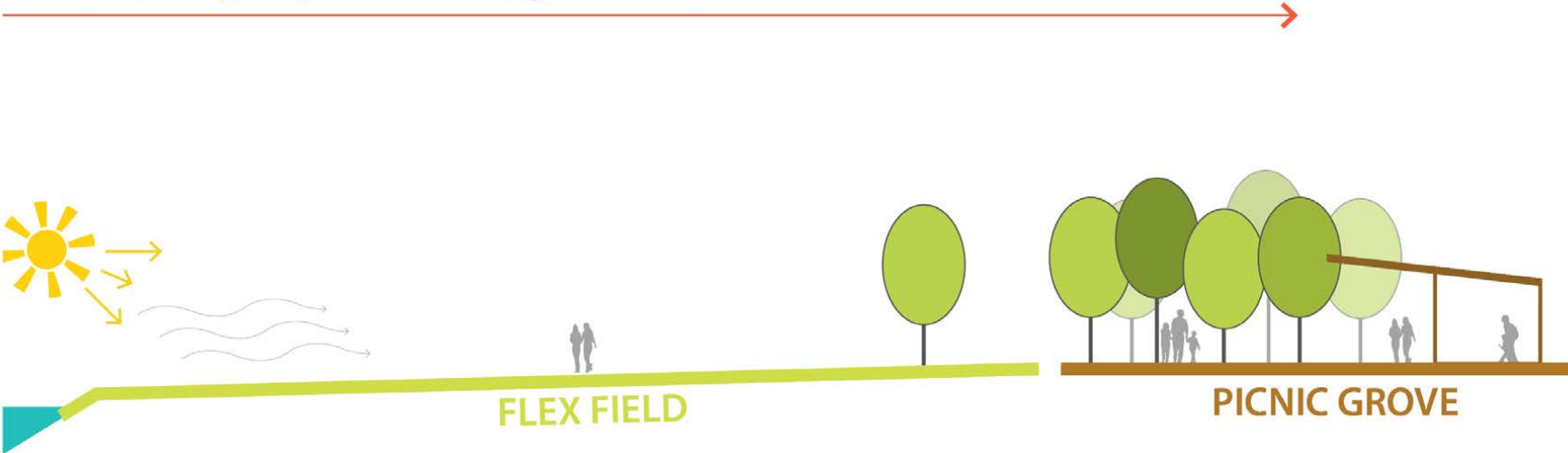

# The Estuary

## Gradation of water-based activities

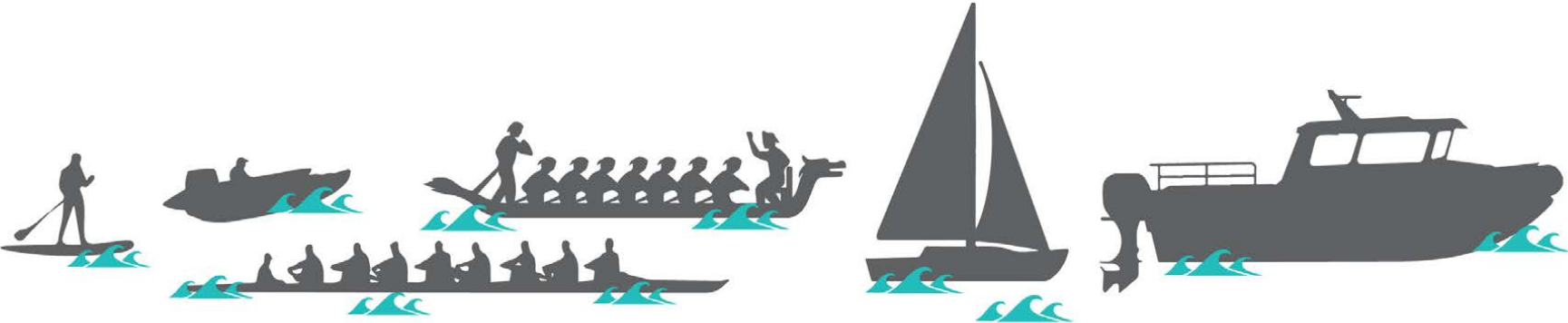

# The Estuary

## Gradation of mobility

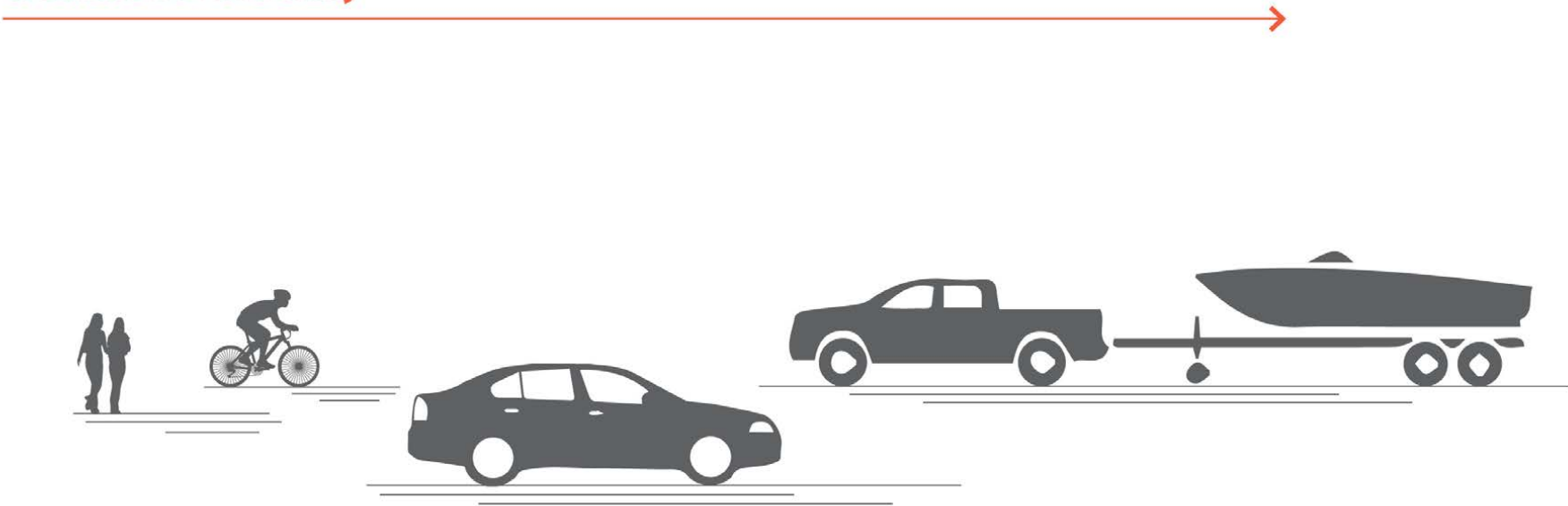



# The Estuary

*Gradation of **past** to the future*



*tidal marsh*

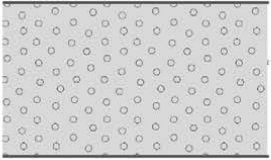

*industrial fill*

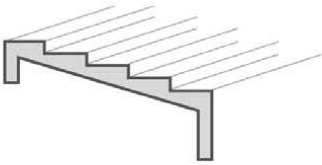

*terraces*

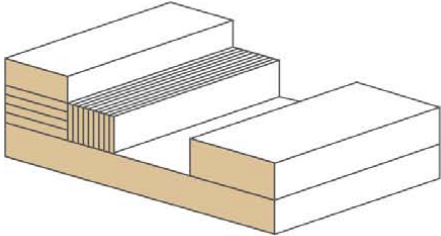

*artwork*

# **ESTUARY PARK PLAN**



# Estuary Park



PARK PAVILION

GREEN LOT

PICNIC GROVE

STREETSCAPE

JACK LONDON AQUATIC CENTER

PEBBLE BEACH

FLEX FIELD

WATER-WISE GARDENS

OVERLOOK

LIVING SHORELINE

LIVING SHORELINE

lake merritt

oakland estuary

# KEY SPACES

# Program Strategy

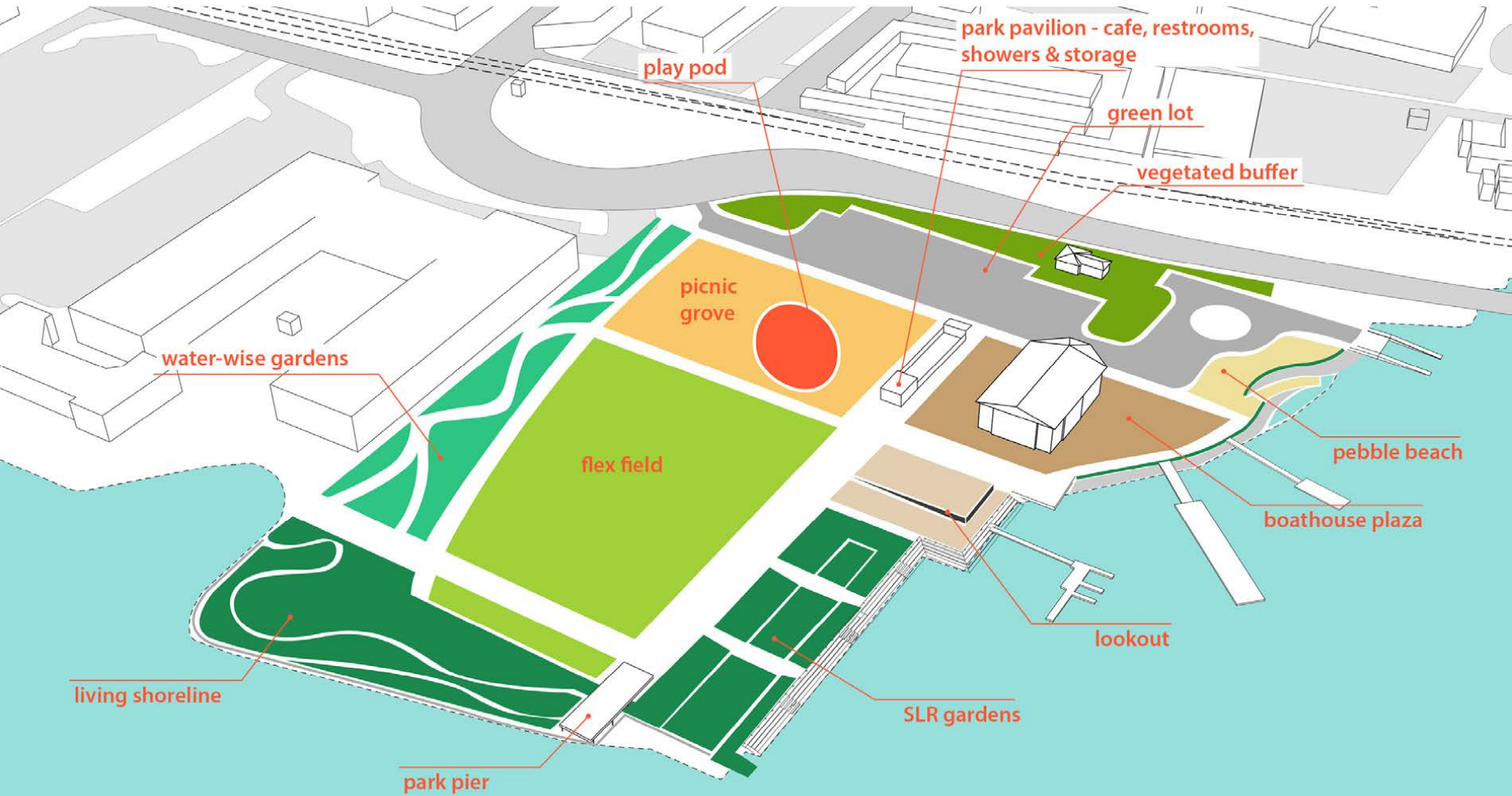

# Program Balance

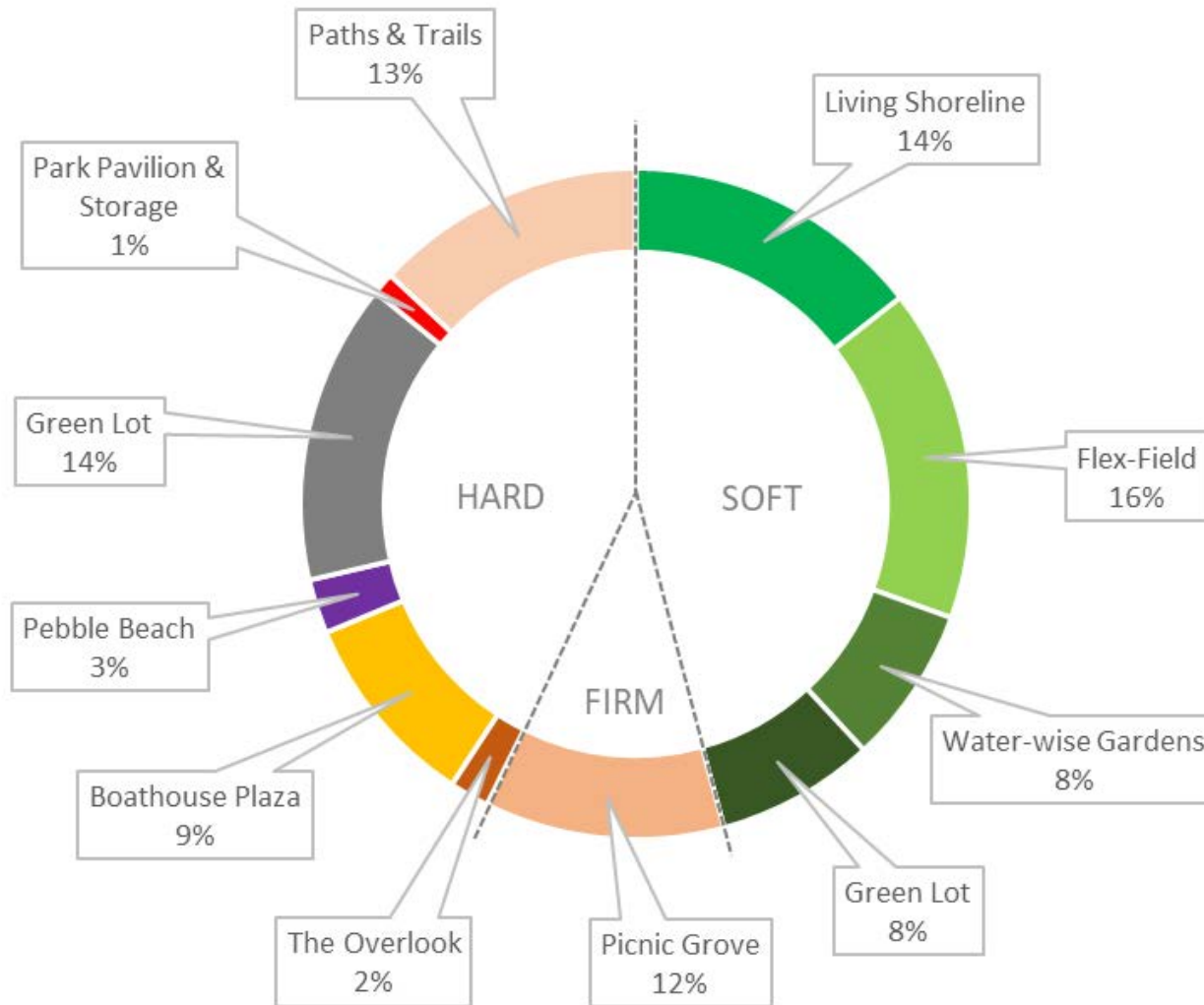

# Living Shoreline





# Living Shoreline

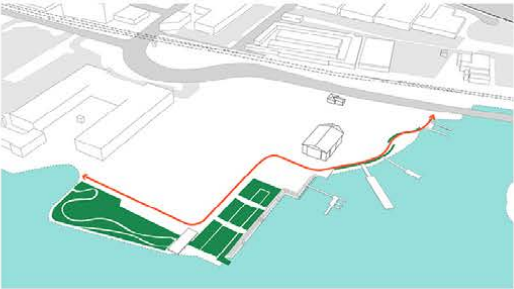

# Living Shoreline



- SHORELINE PROTECTION STRUCTURE (HARD EDGE)**
- ENGINEERED LEVEL (HARD EDGE)**
- BERM/NATURAL EDGE**

Source: SFEI 2016. *San Francisco Bay Shore Inventory: Mapping for Sea Level Rise Planning*. SFEI Publication #779. San Francisco Estuary Institute-Aquatic Science Center, Richmond, CA  
Estuary Park Renovation & Expansion Project  
Community Meeting #3

# Living Shoreline

Source: *Natural and Structural Measures for Shoreline Stabilization*. Prepared by SAGE. Developed with support and funding from SAGE, NOAA and USACE; February 2015



Bay-Friendly



San Francisco Estuary Institute

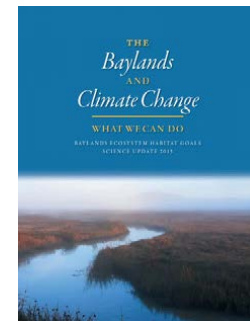

Bay Goals

# Living Shoreline

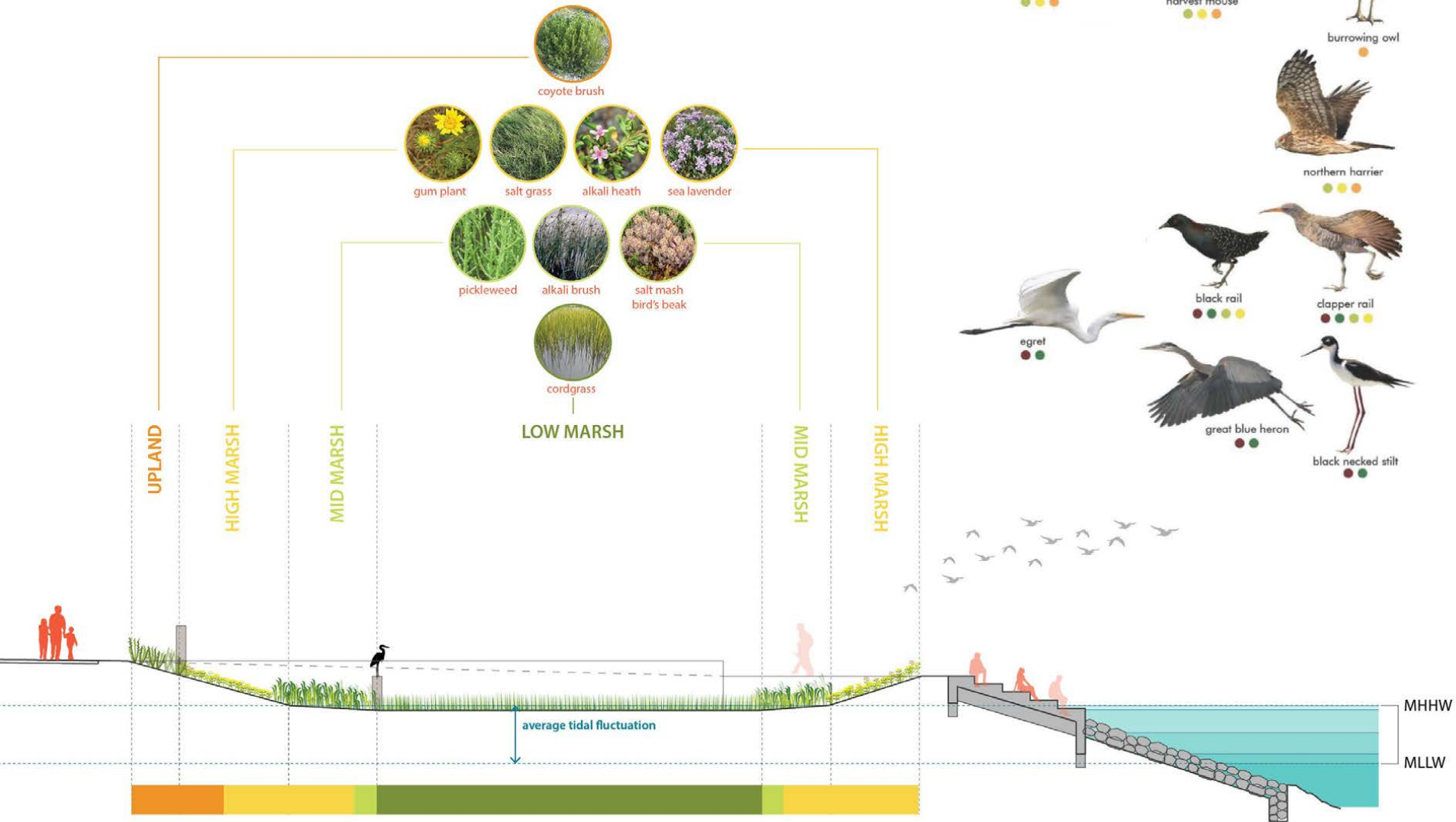

## SLR Gardens

# Flex Field



# Flex Field

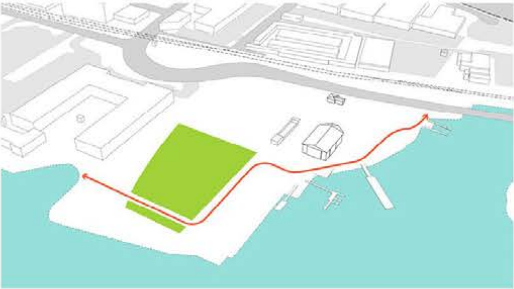

# Water-Wise Gardens



# Water-Wise Gardens

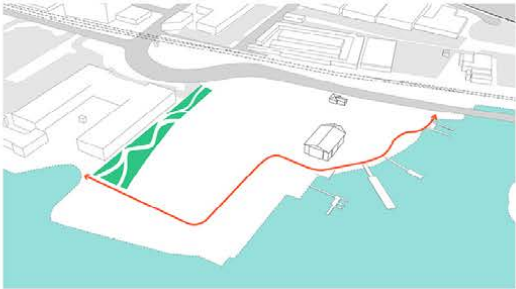



# Picnic Grove



# Picnic Grove

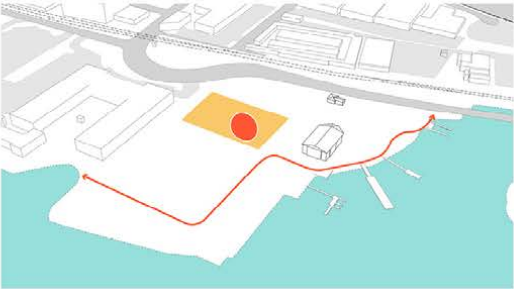

# Picnic Grove – Play Pod

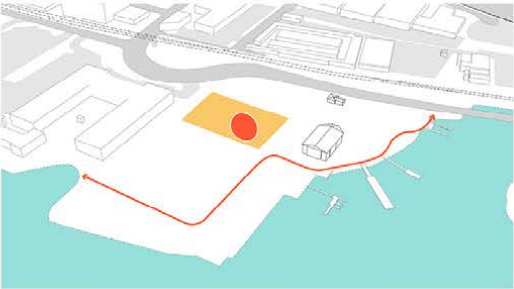

# Overlook

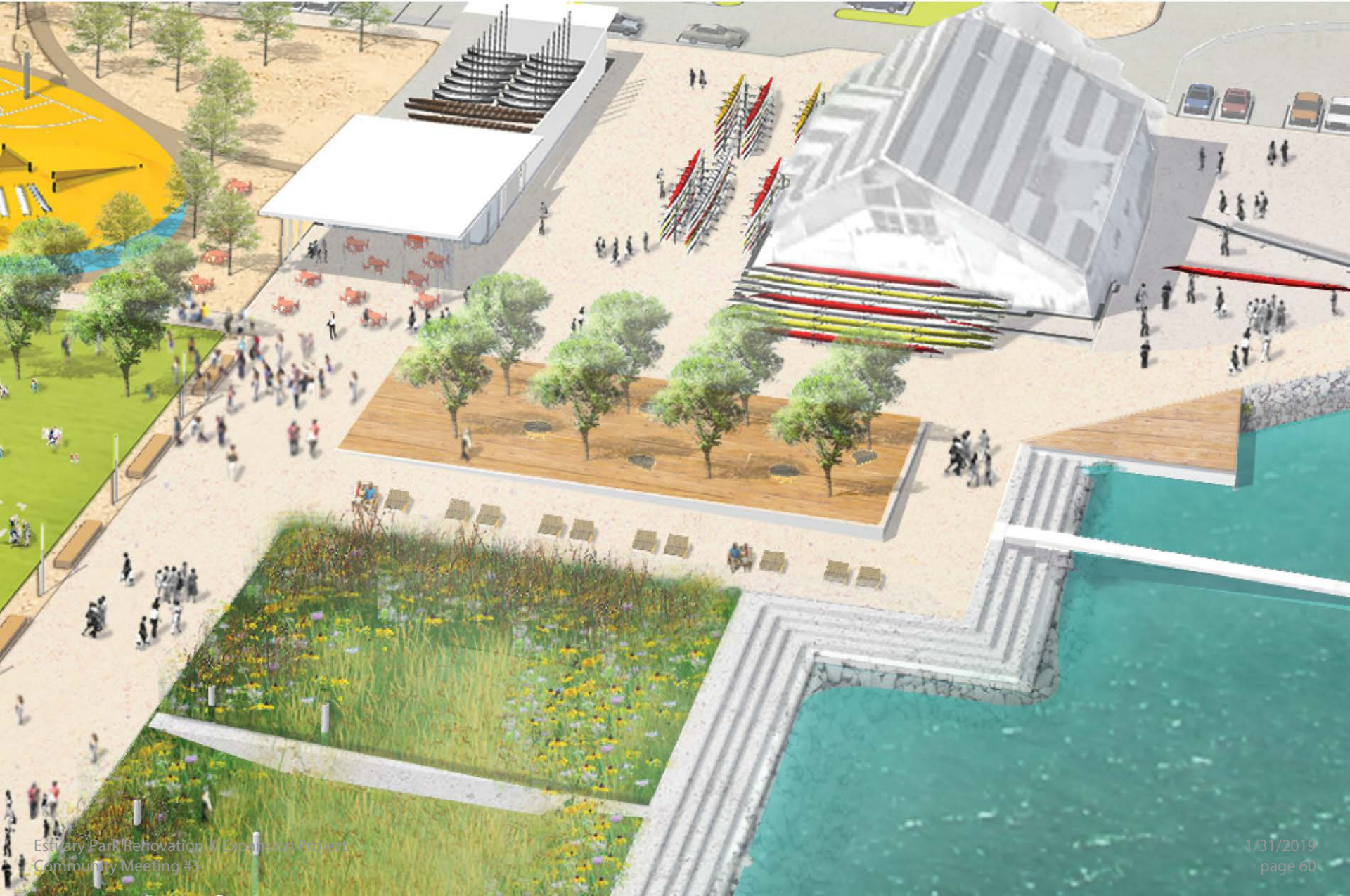

# Overlook

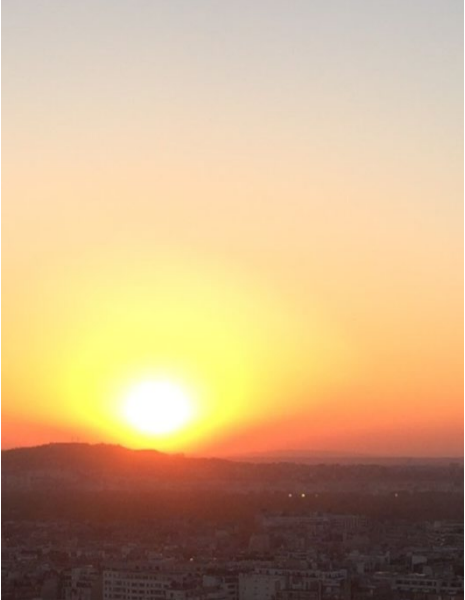
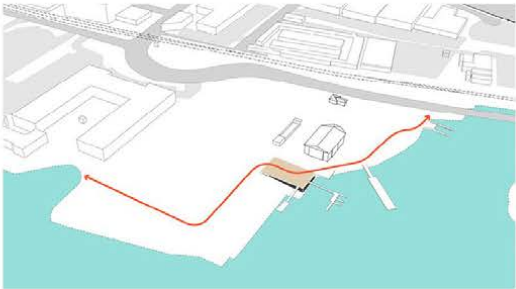

# Pebble Beach



AV  
SLO

# Pebble Beach

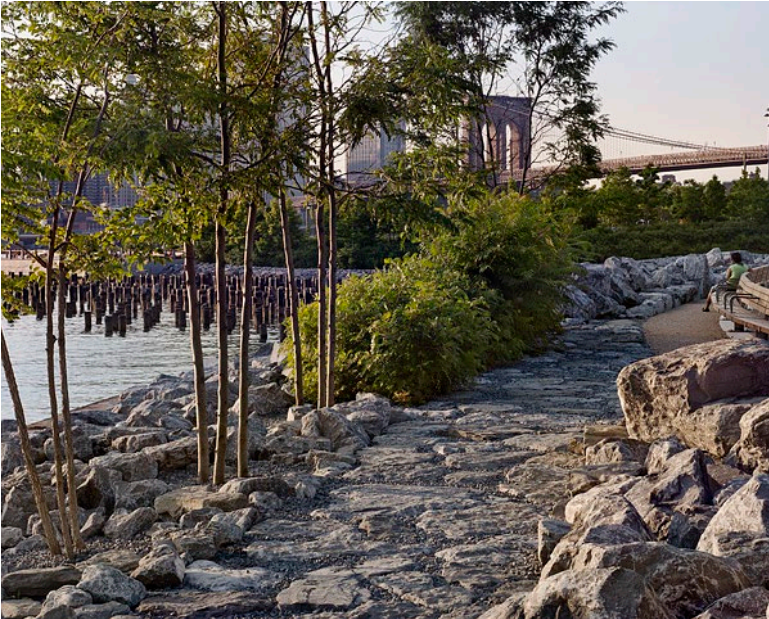
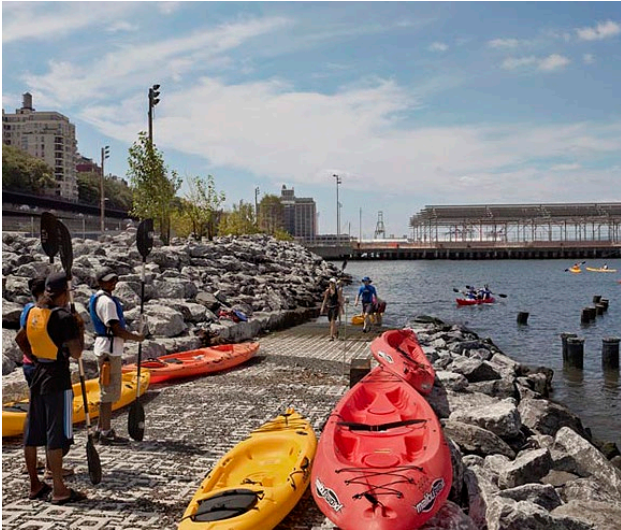
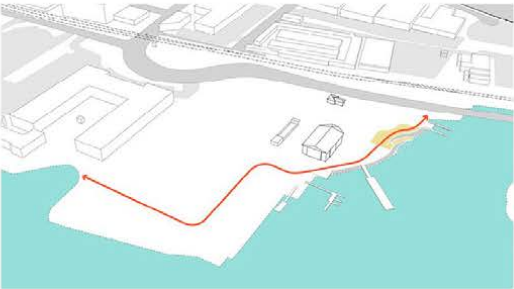

# Boathouse Plaza





# Boathouse Plaza



# Park Pavilion

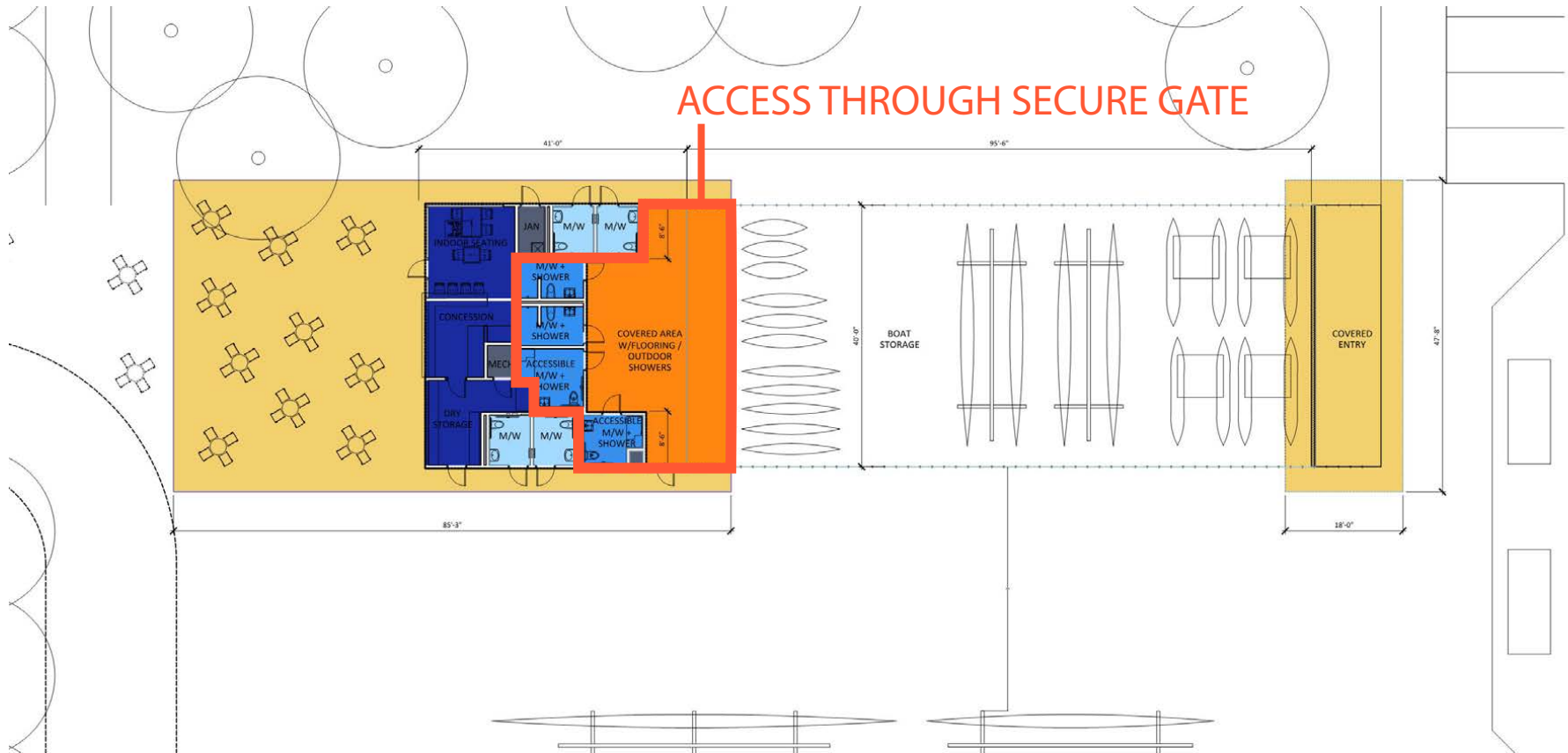

- CONCESSION
- COVERED AREAS
- RESTROOMS
- OUTDOOR SHOWER AREA
- SHOWER STALLS

# Park Pavilion



# Park Pavilion



# Green Lot

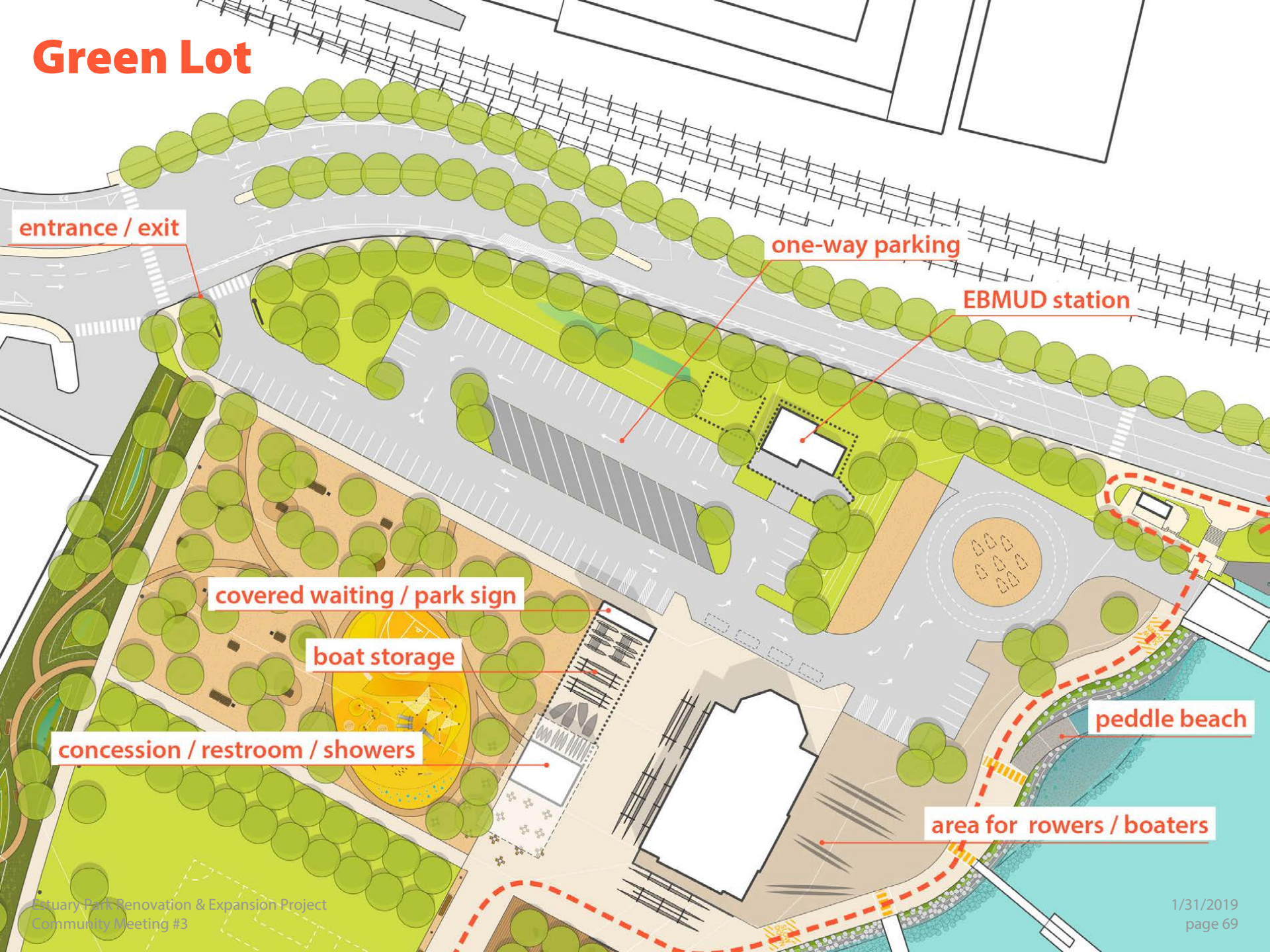

# Green Lot

**1:1 REPLACEMENT  
OF EXISTING**



- kayak drop-off
- trailer parking
- drop-off

entrance / exit

one-way parking

EBMUD station

covered waiting / park sign

boat storage

concession / restroom / showers

Drop-off

emergency vehicle

JACK LONDON AQUATIC CENTER

ADA

KAYAK

peddle beach

area for rowers / boaters

# Streetscape



# Streetscape

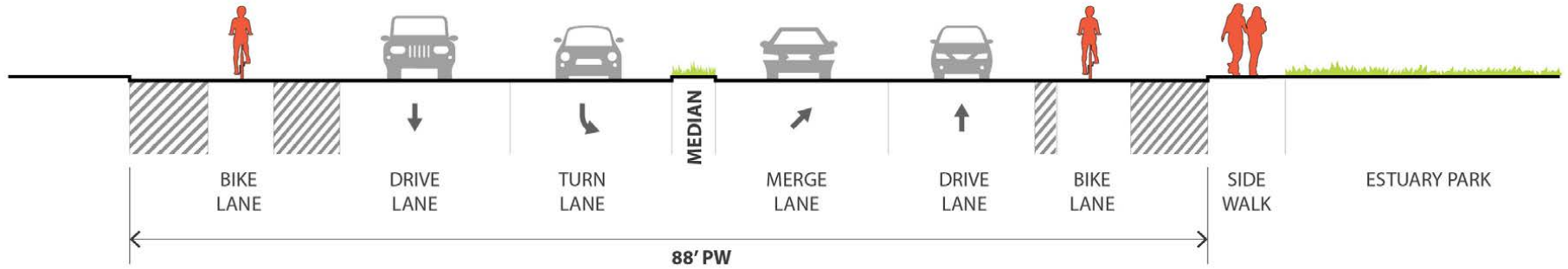

## EXISTING

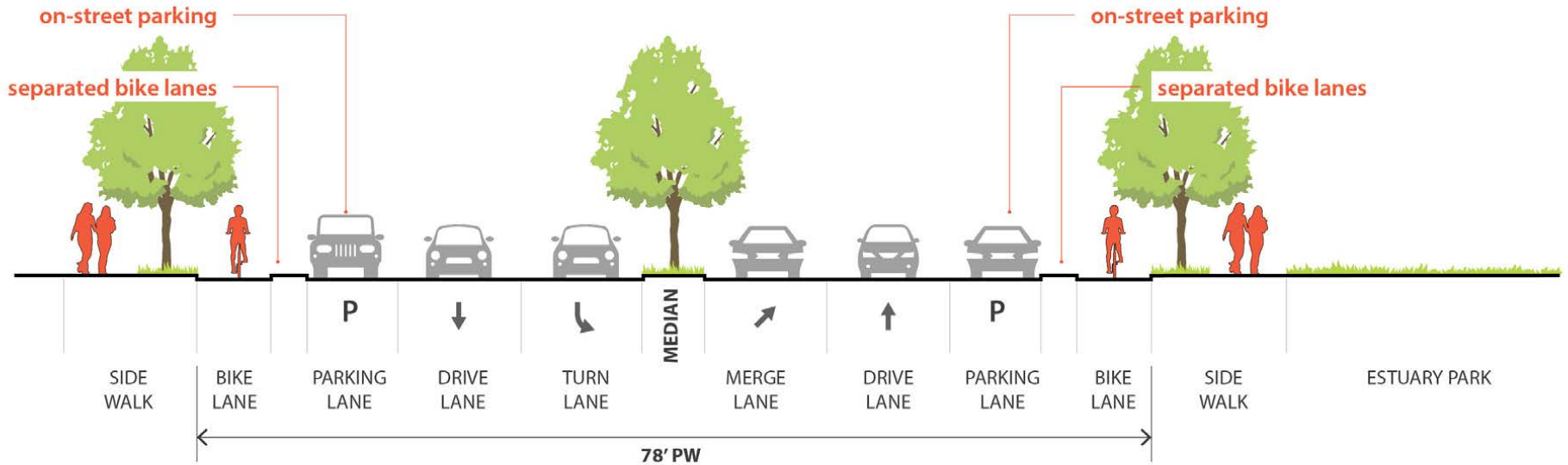

## PROPOSED



# Streetscape

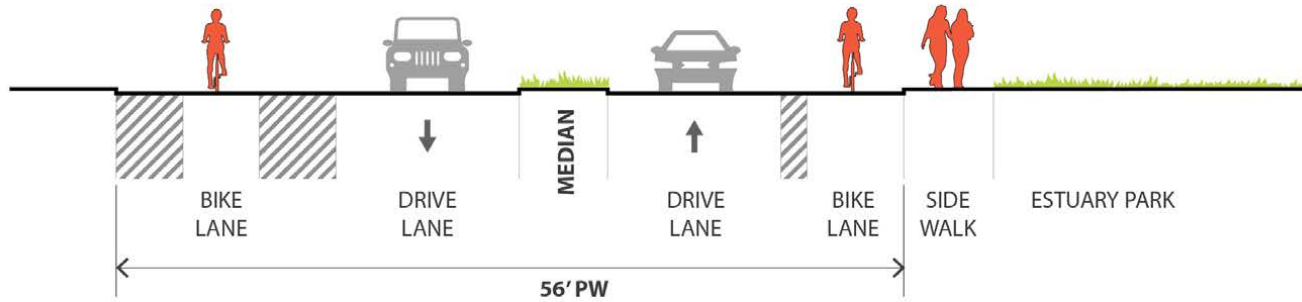

## EXISTING

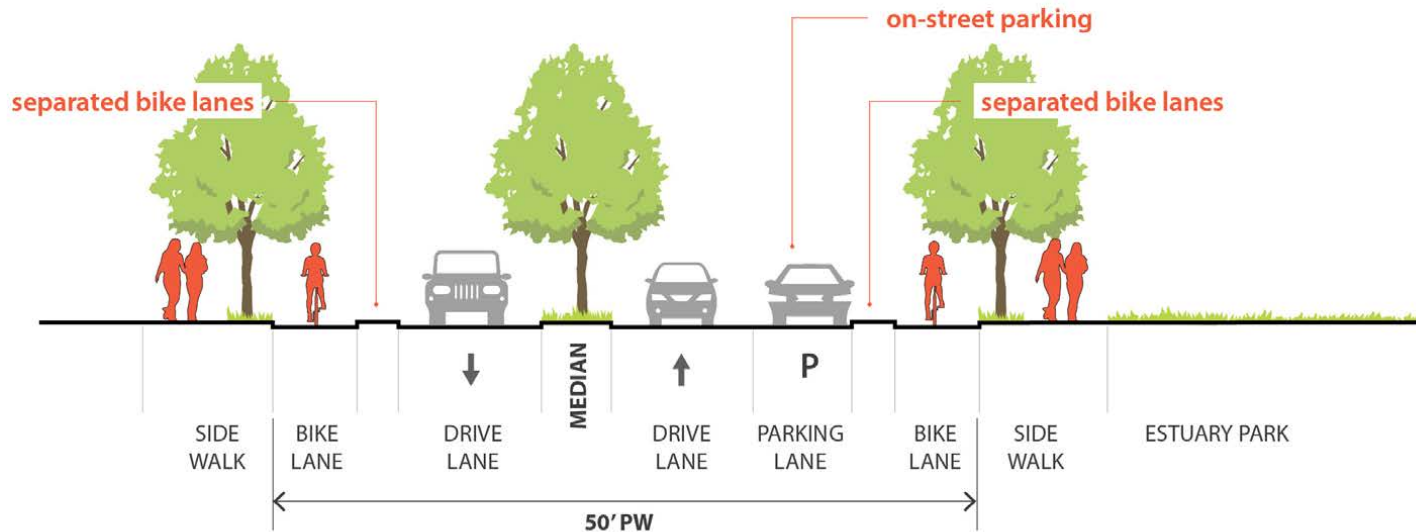

## PROPOSED

# Streetscape

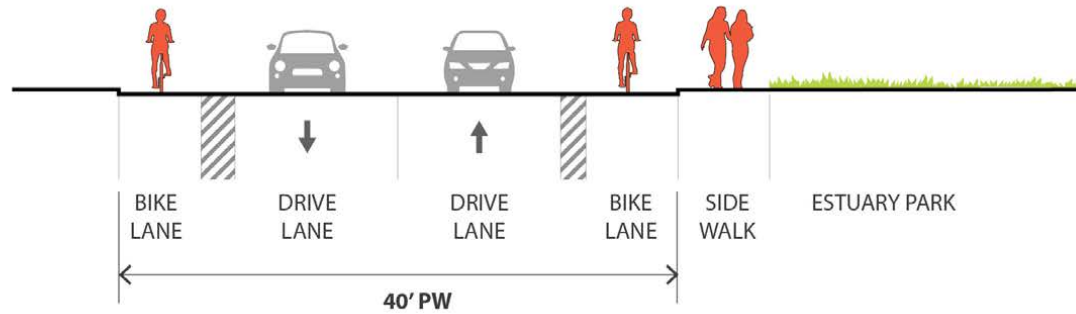

## EXISTING

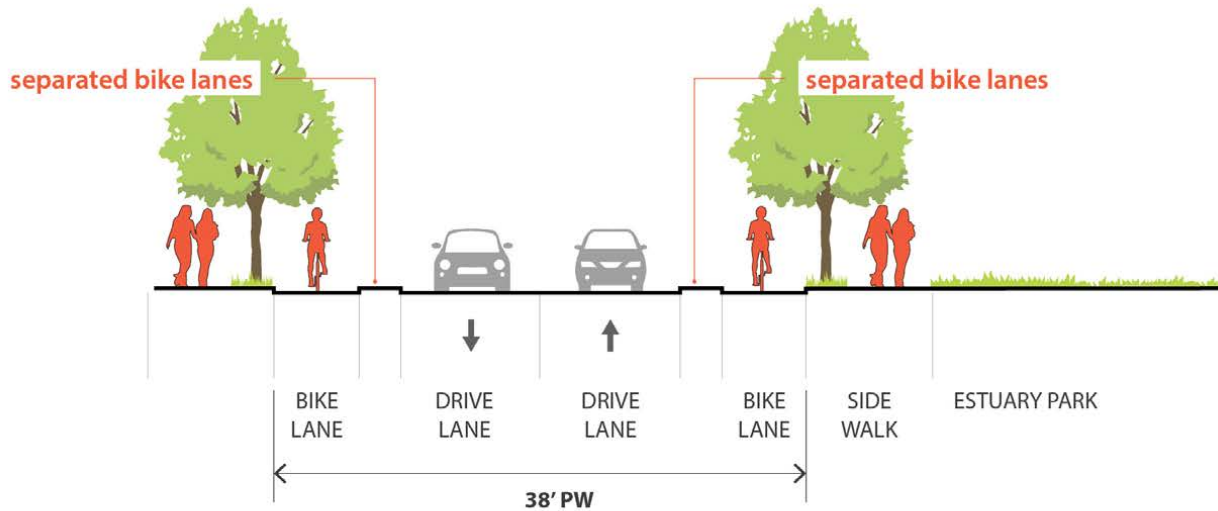

## PROPOSED

# Estuary Park

*Bringing Oakland  
to the Estuary and  
the Estuary to  
Oakland*



**COMMENT PERIOD**

# Estuary Park



**NEXT STEPS**



## Next Steps

- **Encourage others to comment about the new park online. Comment period will be open until February 14 at 11:59pm**
- **Parks and Recreation Advisory Committee Meeting & Measure DD Community Coalition Meeting**  
March 2019
- **For more details about the Estuary Park project and for upcoming events, please go to:**  
<https://www.oaklandca.gov/projects/estuary-park>
- Please contact **Ali Schwarz**: [aschwarz@oaklandca.gov](mailto:aschwarz@oaklandca.gov) if you have any questions.



**THANK YOU – LET'S MAKE OAKLAND'S  
ESTUARY PARK BIGGER & BETTER**

**#OaklandEstuaryPark**